



CIRCULAR CONNECTORS

PRC SERIES

PRC SERIES (Push-Pull Circular Connector)

PRC03,04 and 05 are high specification, quick release, light Weight, miniature, multi-pin connectors. They are mated with a simple "push-pull" action. PRC03 connectors meet the requirements of the Japanes Non-destructive Testing Association.

OFUATURE

1. PRC eliminates the time required for turning the connector by hand and pushing by finger different from the conventional screw or bayonet type.
2. PRC ensures a quick conection or disconnection.
3. PRC never loosens even if it is subjected to vibrations and impacts.
4. PRC ensures smoother operation (connection and disconnection) even in a narrow space.

OPART NUMBERING SYSTEM

PRC05 series

PRC 05 - P 5 F

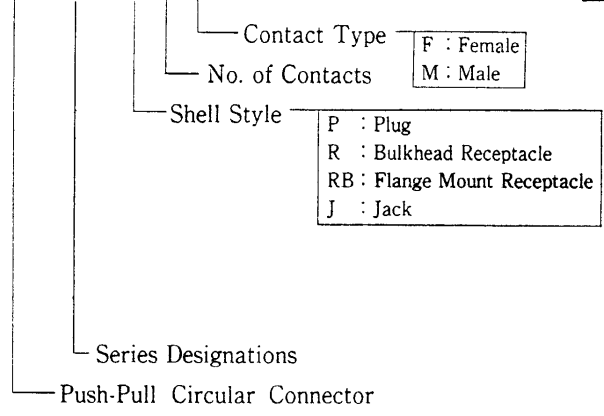

PRC03,04 series

PRC 03 - 12A 10 - 3A F 10.5

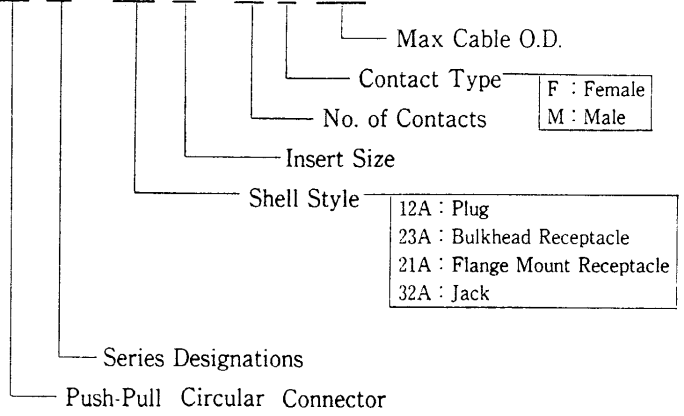

OMATERIALS

Principal Part	Materials			Plating		
	05 series	03 series	04 series	05 series	03 series	04 series
Shell	Brass	Zinc Alloy	Aluminum Alloy	Nickel	Nickel	Anodic Oxidation Coatings
Male Contact	Brass	Brass	Brass	Gold	Gold	Gold
Female Contact	Copper Alloy	Copper Alloy	Copper Alloy	Gold	Gold	Gold
Insulation	Synthetic Resin	Synthetic Resin	Synthetic Resin	—	—	—

OSPECIFICATIONS

Electrical PRC05 Series

Insert No.	6 - 2	6 - 3	6 - 5	9 - 6	9 - 8	12 - 12
No. of Contacts	2	3	5	6	8	12
Insert Arrangements						
Current rating	2 A	2 A	2 A	2 A	2 A	2 A
Voltage rating (AC V rms)	300V	300V	150V	300V	200V	300V
Withstand Voltage (AC V rms)	900V	900V	500V	900V	700V	900V
Contact resistance	DC3V 1A 8mΩ max.					
Insulation resistance	DC500V 1,000MΩ min.					
Temperature range	-25°C ~ +85°C					
Applicable Wire	A.W.G. #	AWG # 24 max.				
	Square	0.3 mm ² max.				
	Wire diameter	0.8φ max.				



CIRCULAR CONNECTORS

PRC SERIES

Electrical PRC03 Series

Insert No.	10-2 A	10-3 A	10-4	10-5	10-7	
No. of Contacts	2	3	4	5	7	
Insert Arrangements						
Current rating	10A	10A	5 A	5 A	5 A	
Voltage rating (AC. V. rms)	600V	350V	400V	350V	350V	
Withstand Voltage (AC. V. rms)	1,800V	1,000V	1,200V	1,000V	1,000V	
Contact resistance	DC3V 1A 5mΩ max.					
Insulation resistance	DC500V 1,000MΩ min.					
Temperature range	-25°C ~ +85°C					
Applicable Wire	A.W.G. #	AWG #16	AWG #16	AWG #20	AWG #20	AWG #20
	Square	1.4mm ² max.	1.4mm ² max.	0.5mm ² max.	0.5mm ² max.	0.5mm ² max.
	Wire diameter	1.6φ max.	1.6φ max.	1.0φ max.	1.0φ max.	1.0φ max.

Electrical PRC04 Series

Insert No.	16-8 A	16-14	20 S-12	20 S-19	
No. of Contacts	8	14	12	19	
Insert Arrangements					
Current rating	10A	5 A	10A	4 A	
Voltage rating (AC. V. rms)	400V	350V	400V	400V	
Withstand Voltage (AC. V. rms)	1,200V	1,000V	1,200V	1,200V	
Contact resistance	DC3V 1A 5mΩ max.				
Insulation resistance	DC500V 1,000MΩ min.				
Temperature range	-25°C ~ +85°C				
Applicable Wire	A.W.G. #	AWG #16	AWG #20	AWG #16	AWG #20
	Square	1.4mm ² max.	0.5mm ² max.	1.4mm ² max.	0.5mm ² max.
	Wire diameter	1.6φ max.	1.0φ max.	1.6φ max.	1.0φ max.

Electrical PRC04 Series

Insert No.	26 S-21	26 S-37	
No. of Contacts	21	37	
Insert Arrangements			
Current rating	10A	3 A	
Voltage rating (AC. V. rms)	400V	400V	
Withstand Voltage (AC. V. rms)	1,200V	1,200V	
Contact resistance	DC3V 1A 5mΩ max.		
Insulation resistance	DC500V 1,000MΩ min.		
Temperature range	-25°C ~ +85°C		
Applicable Wire	A.W.G. #	AWG #16	AWG #20
	Square	1.4mm ² max.	0.5mm ² max.

Plugs

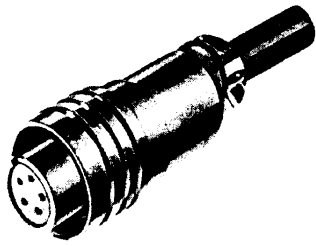

PRC05-P5F

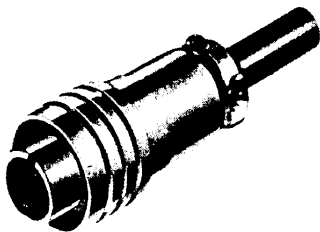

PRC05-P5M

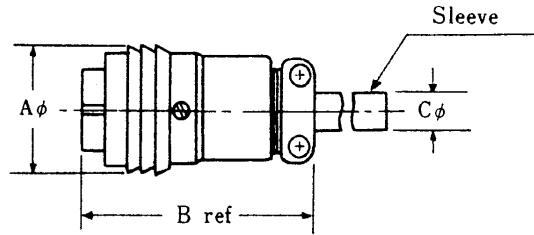

Insert No.	No. of Contacts	Part Number	Dimensions, millimeter			Weight
			A	B	C	
6-2	2	PRC05-P2F	13.5	32.0	5.2(4.0)	13.7
		PRC05-P2M				13.3
6-3	3	PRC05-P3F	13.5	32.0	5.2(4.0)	13.9
		PRC05-P3M				13.4
6-5	5	PRC05-P5F	13.5	32.0	5.2(4.0)	14.1
		PRC05-P5M				13.4
9-6	6	PRC05-P6F	16.7	34.0	6.2(5.2)	22.9
		PRC05-P6M				21.9
9-8	8	PRC05-P8F	16.7	34.0	6.2(5.2)	23.1
		PRC05-P8M				22.1
12-12	12	PRC05-P12F1	21.0	39.0	11.0(8.5)	37.0
		PRC05-P12M1				36.0

* () indicates sleeve Inner Dia. and Elimination of last number "1" indicates no sleeve in 12-contact.

Bulkhead Receptacles



PRC05-R5M



PRC05-R5F

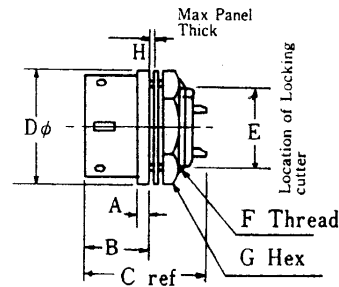
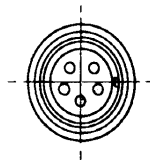

Insert No.	No. of Contacts	Part Number	Dimensions, millimeter								Weight
			A	B	C	D	E	F	G	H	
6-2	2	PRC05-R2M	2.0	9.5	17.8	13.0	8.2	9.0	11.0	2.0	6.5
		P=0.5						6.9			
6-3	3	PRC05-R3M	2.0	9.5	17.8	13.0	8.2	9.0	11.0	2.0	6.6
		P=0.5						7.0			
6-5	5	PRC05-R5M	2.0	9.5	17.8	13.0	8.2	9.0	11.0	2.0	6.8
		P=0.5						7.3			
9-6	6	PRC05-R6M	2.0	9.5	17.8	16.0	11.0	12.0	14.0	2.0	9.2
		P=0.8						10.2			
9-8	8	PRC05-R8M	2.0	9.5	17.8	16.0	11.0	12.0	14.0	2.0	9.4
		P=0.8						10.4			
12-12	12	PRC05-R12M	2.0	9.5	17.8	20.0	14.5	16.0	20.0	1.6	15.5
		P=1.0						16.5			

Dust Caps for Receptacles

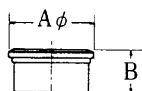

Materials—Polyethylene

Insert No.	Part Number	Dimensions, millimeter	
		A	B
6-2, 3, 5	PRC05-6RC	16.0	10.5
9-6, 8	PRC05-9RC	19.0	10.5
12-12	PRC05-12RC	22.0	10.5



CIRCULAR CONNECTORS

PRC05 SERIES

Flange Mount Receptacles

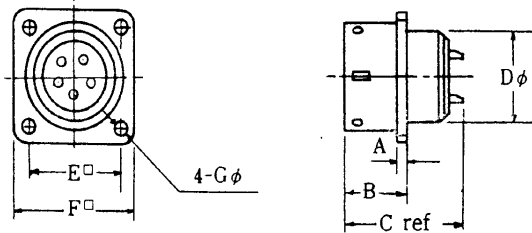
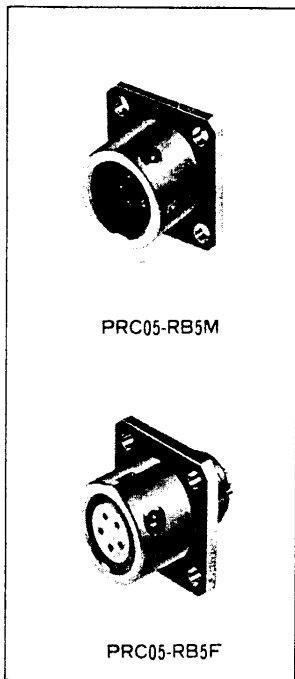

Insert No.	No. of Contacts	Part Number	Dimensions, millimeter							Weight
			A	B	C	D	E	F	G	
6-2	2	PRC05-RB2M	1.5	9.5	17.8	9.0	11.5	16.0	2.2	7.1
		PRC05-RB2F								7.6
6-3	3	PRC05-RB3M	1.5	9.5	17.8	9.0	11.5	16.0	2.2	7.2
		PRC05-RB3F								7.7
6-5	5	PRC05-RB5M	1.5	9.5	17.8	9.0	11.5	16.0	2.2	7.4
		PRC05-RB5F								8.0
9-6	6	PRC05-RB6M	1.5	9.5	17.8	12.0	13.5	18.0	2.2	9.8
		PRC05-RB6F								10.8
9-8	8	PRC05-RB8M	1.5	9.5	17.8	12.0	13.5	18.0	2.2	10.0
		PRC05-RB8F								11.0
12-12	12	PRC05-RB12M	2.0	9.5	17.8	16.0	17.0	22.5	2.8	14.9
		PRC05-RB12F								15.9

Jacks

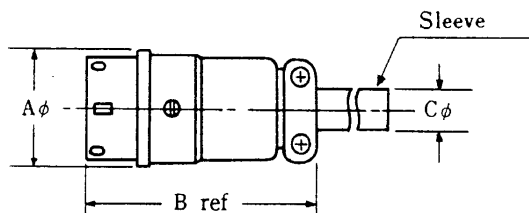
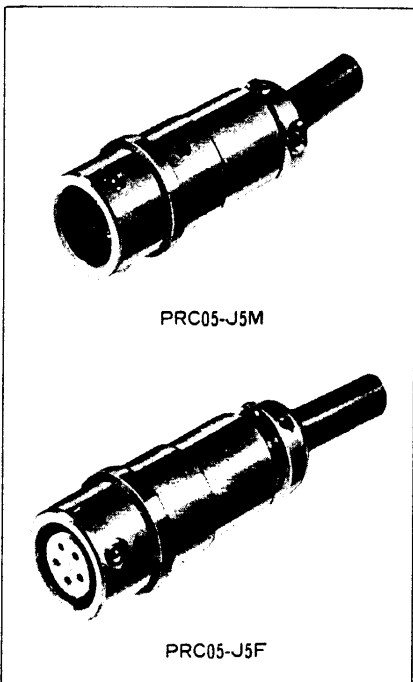

Insert No.	No. of Contacts	Part Number	Dimensions, millimeter			Weight
			A	B	C	
6-2	2	PRC05-J2M	13.0	32.3	5.2(4.0)	13.4
		PRC05-J2F				13.8
6-3	3	PRC05-J3M	13.0	32.3	5.2(4.0)	13.5
		PRC05-J3F				13.9
6-5	5	PRC05-J5M	13.0	32.3	5.2(4.0)	13.9
		PRC05-J5F				14.4
9-6	6	PRC05-J6M	16.0	34.3	6.2(5.2)	21.6
		PRC05-J6F				22.6
9-8	8	PRC05-J8M	16.0	34.3	6.2(5.2)	21.8
		PRC05-J8F				22.8
12-12	12	PRC05-J12M1	20.0	39.0	11.0(8.5)	34.0
		PRC05-J12F1				35.0

*() indicates sleeve Inner Dia. and Elimination of last number "1" indicates no sleeve in 12-contact.

Mounting Hole Dimensions

Bulkhead Type

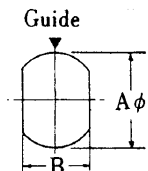

Insert No.	Dimensions, millimeter	
	A	B
6-2, 3, 5	9.2	8.4
9-6, 8	12.2	11.2

Flange Mounting Type

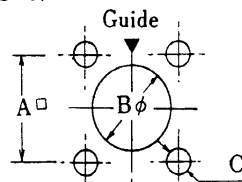

Insert No.	Dimensions, millimeter		
	A	B	C
6-2, 3, 5	11.5	9.2	2.2
9-6, 8	13.5	12.2	2.2



CIRCULAR CONNECTORS

PRC03 SERIES

Plugs

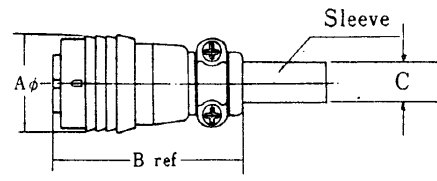
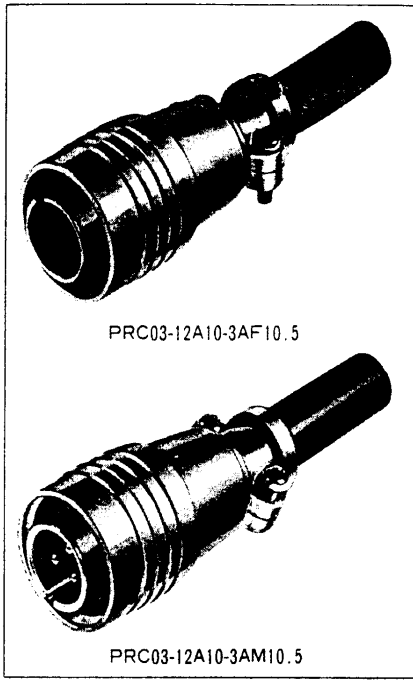

Insert No.	No. of Contacts	Part Number	Dimensions, millimeter			Weight
			A	B	C	
10-2A	2	PRC03-12A10-2AF10.5	21.0	46.0	10.5(8.0)	41.0
		PRC03-12A10-2AM10.5				39.6
10-3A	3	PRC03-12A10-3AF10.5	21.0	46.0	10.5(8.0)	41.4
		PRC03-12A10-3AM10.5				40.5
10-4	4	PRC03-12A10-4F10.5	21.0	46.0	10.5(8.0)	41.4
		PRC03-12A10-4M10.5				39.1
10-5	5	PRC03-12A10-5F10.5	21.0	46.0	10.5(8.0)	41.4
		PRC03-12A10-5M10.5				39.6
10-7	7	PRC03-12A10-7F10.5	21.0	46.0	10.5(8.0)	42.2
		PRC03-12A10-7M10.5				40.6

※ () Rubber Sleeve at fitting.

Bulkhead Receptacles

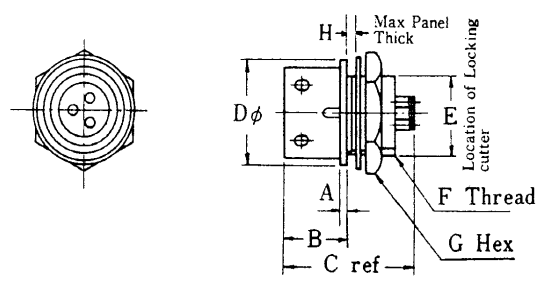
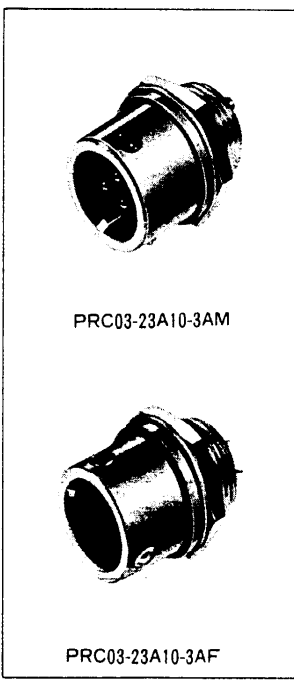

Insert No.	No. of Contacts	Part Number	Dimensions, millimeter								Weight	
			A	B	C	D	E	F	G	H		
10-2A	2	PRC03-23A10-2AM	1.5	12.5	26.5	19.0	14.0	15.0	P=1	19.0	4.0	19.7
		PRC03-23A10-2AF										20.7
10-3A	3	PRC03-23A10-3AM	1.5	12.5	26.5	19.0	14.0	15.0	P=1	19.0	4.0	20.5
		PRC03-23A10-3AF										21.6
10-4	4	PRC03-23A10-4M	1.5	12.5	26.5	19.0	14.0	15.0	P=1	19.0	4.0	19.4
		PRC03-23A10-4F										21.1
10-5	5	PRC03-23A10-5M	1.5	12.5	26.5	19.0	14.0	15.0	P=1	19.0	4.0	19.8
		PRC03-23A10-5F										21.6
10-7	7	PRC03-23A10-7M	1.5	12.5	26.5	19.0	14.0	15.0	P=1	19.0	4.0	20.3
		PRC03-23A10-7F										22.0

Dust Caps for Plugs

Dust Caps for Receptacles

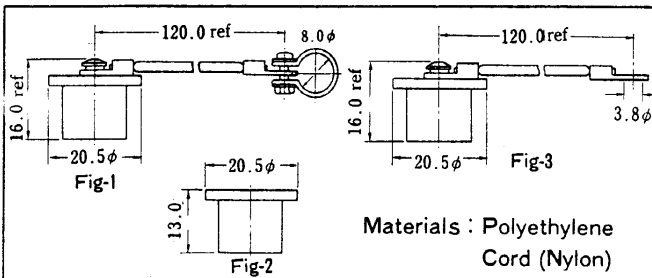

Insert No.	Part Number	Figure
10-2A, 3A, 4, 5, 7	PRC03-10PC	2
	PRC03-10PC1-1	3

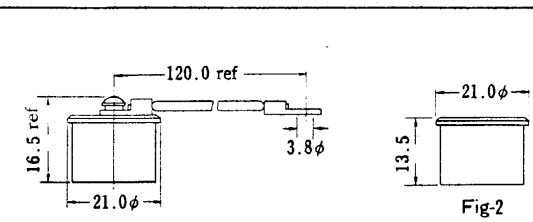

Insert No.	Part Number	Figure
10-2A, 3A, 4, 5, 7	PRC03-10RC	2



CIRCULAR CONNECTORS

PRC03 SERIES

Flange Mount Receptacles

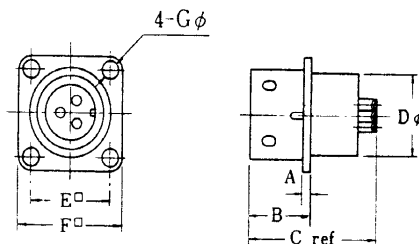
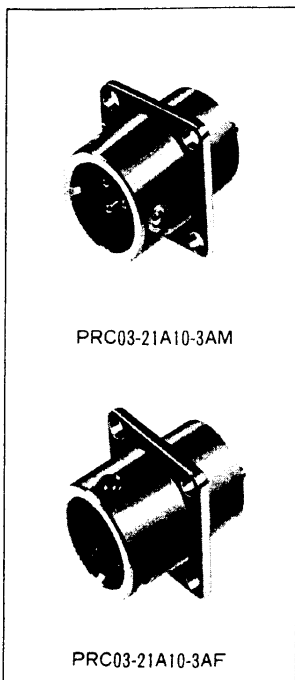

Insert No.	No. of Contacts	Part Number	Dimensions, millimeter							Weight
			A	B	C	D	E	F	G	
10-2A	2	PRC03-21A10-2AM	1.5	12.5	26.5	15.0	16.0	21.0	2.9	18.1
		PRC03-21A10-2AF								19.8
10-3A	3	PRC03-21A10-3AM	1.5	12.5	26.5	15.0	16.0	21.0	2.9	18.8
		PRC03-21A10-3AF								20.1
10-4	4	PRC03-21A10-4M	1.5	12.5	26.5	15.0	16.0	21.0	2.9	18.0
		PRC03-21A10-4F								20.0
10-5	5	PRC03-21A10-5M	1.5	12.5	26.5	15.0	16.0	21.0	2.9	17.3
		PRC03-21A10-5F								20.0
10-7	7	PRC03-21A10-7M	1.5	12.5	26.5	15.0	16.0	21.0	2.9	20.3
		PRC03-21A10-7F								22.0

Jacks

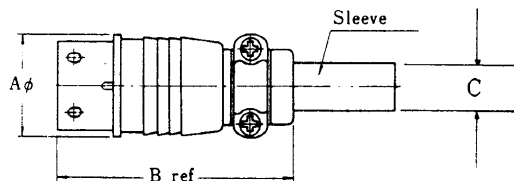
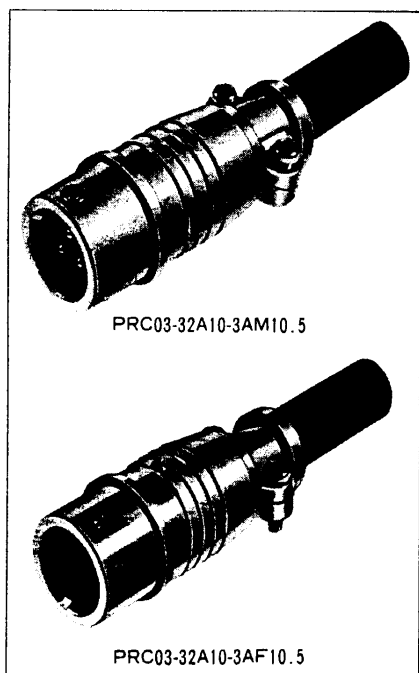

Insert No.	No. of Contacts	Part Number	Dimensions, millimeter			Weight
			A	B	C	
10-2A	2	PRC03-32A10-2AM10.5	19.0	46.0	10.5(8.0)	34.1
		PRC03-32A10-2AF10.5				35.2
10-3A	3	PRC03-32A10-3AM10.5	19.0	46.0	10.5(8.0)	34.7
		PRC03-32A10-3AF10.5				35.4
10-4	4	PRC03-32A10-4M10.5	19.0	46.0	10.5(8.0)	33.5
		PRC03-32A10-4F10.5				35.2
10-5	5	PRC03-32A10-5M10.5	19.0	46.0	10.5(8.0)	34.2
		PRC03-32A10-5F10.5				35.5
10-7	7	PRC03-32A10-7M10.5	19.0	46.0	10.5(8.0)	34.8
		PRC03-32A10-7F10.5				37.0

※ () Rubber Sleeve at fitting

Mounting Hole Dimensions

Bulkhead Type

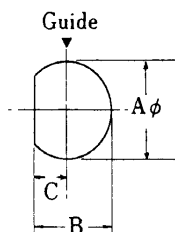

Insert No.	Dimensions, millimeter		
	A	B	C
10-2A, 3A			

Flange Mounting Type

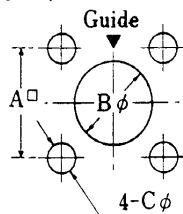

Insert No.	Dimensions, millimeter		
	A	B	C
10-2A, 3A			



CIRCULAR CONNECTORS

PRC04 SERIES

Plugs

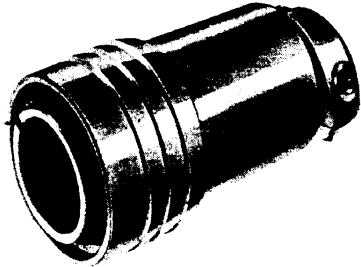

PRC04-12A16-8AF12.5

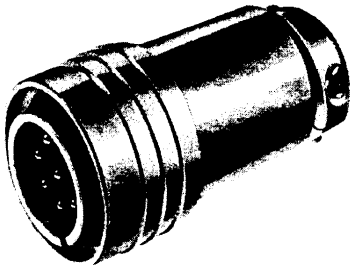

PRC04-12A16-8AM12.5

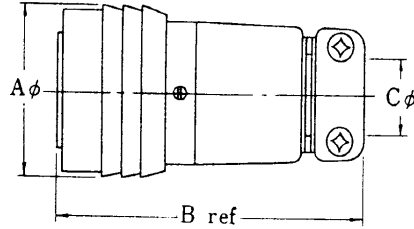

Insert No.	No. of Contacts	Part Number	Dimensions, millimeter			Weight
			A	B	C	
16-8A	8	PRC04-12A16-8AF12.5	28.0	55.5	12.5	43.4
		PRC04-12A16-8AM12.5				40.0
16-14	14	PRC04-12A16-14F12.5	28.0	55.5	12.5	42.9
		PRC04-12A16-14M12.5				38.6
20S-12	12	PRC04-12A20S-12F14.5	34.0	63.5	14.5	68.2
		PRC04-12A20S-12M14.5				62.5
20S-19	19	PRC04-12A20S-19F14.5	34.0	63.5	14.5	66.4
		PRC04-12A20S-19M14.5				60.3
26S-21	21	PRC04-12A26S-21F18	40.8	71.0	18.0	115.5
		PRC04-12A26S-21M18				102.5
26S-37	37	PRC04-12A26S-37F18	40.8	71.0	18.0	110.3
		PRC04-12A26S-37M18				97.5

Bulkhead Receptacles

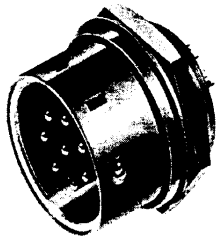

PRC04-23A16-8AM

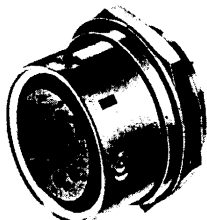

PRC04-23A16-8AF

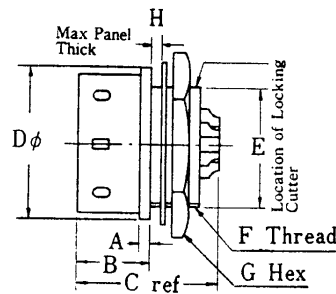
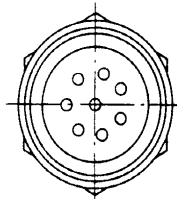

Insert No.	No. of Contacts	Part Number	Dimensions, millimeter							Weight	
			A	B	C	D	E	F	G		H
16-8A	8	PRC04-23A16-8AM	2.0	13.5	25.5	25.0	20.0	21.0	26.0	3.4	24.0
		P=1						27.3			
16-14	14	PRC04-23A16-14M	2.0	13.5	25.5	25.0	20.0	21.0	26.0	3.4	22.5
		P=1						26.9			
20S-12	12	PRC04-23A20S-12M	2.5	14.0	26.0	32.0	25.0	26.0	32.0	2.0	42.0
		P=1						47.5			
20S-19	19	PRC04-23A20S-19M	2.5	14.0	26.0	32.0	25.0	26.0	32.0	2.0	39.4
		P=1						45.7			
26S-21	21	PRC04-23A26S-21M	2.5	14.0	26.0	38.0	31.0	32.0	38.0	2.0	58.2
		P=1						68.1			
26S-37	37	PRC04-23A26S-37M	2.5	14.0	26.0	38.0	31.0	32.0	38.0	2.0	54.9
		P=1						66.5			



CIRCULAR CONNECTORS

PRC04 SERIES

Flange Mount Receptacles

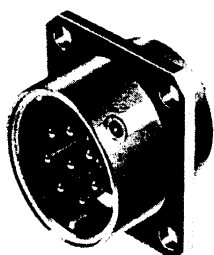

PRC04-21A16-8AM

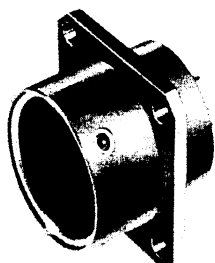

PRC04-21A16-8AF

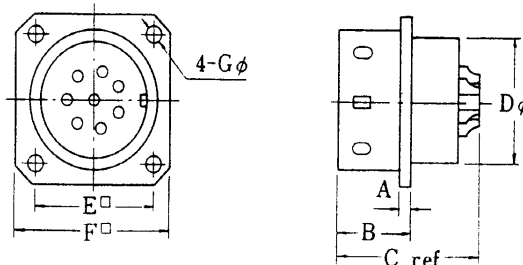

Insert No.	No. of Contacts	Part Number	Dimensions, millimeter							Weight
			A	B	C	D	E	F	G	
16-8A	8	PRC04-21A16-8AM	2.0	13.5	25.5	21.0	21.5	28.0	3.4	18.9
		PRC04-21A16-8AF								22.4
16-14	14	PRC04-21A16-14M	2.0	13.5	25.5	21.0	21.5	28.0	3.4	17.7
		PRC04-21A16-14F								21.9
20S-12	12	PRC04-21A20S-12M	2.5	14.0	26.0	26.0	26.0	33.0	3.9	28.8
		PRC04-21A20S-12F								35.3
20S-19	19	PRC04-21A20S-19M	2.5	14.0	26.0	26.0	26.0	33.0	3.9	27.7
		PRC04-21A20S-19F								33.6
26S-21	21	PRC04-21A26S-21M	2.5	14.0	26.0	32.0	31.0	38.0	3.9	43.5
		PRC04-21A26S-21F								52.7
26S-37	37	PRC04-21A26S-37M	2.5	14.0	26.0	32.0	31.0	38.0	3.9	39.5
		PRC04-21A26S-37F								51.1

Jacks

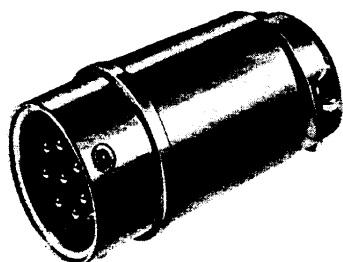

PRC04-32A16-8AM12.5

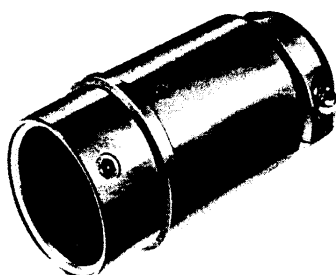

PRC04-32A16-8AF12.5

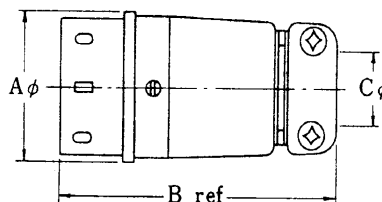

Insert No.	No. of Contacts	Part Number	Dimensions, millimeter			Weight
			A	B	C	
16-8A	8	PRC04-32A16-8AM12.5	25.0	50.0	12.5	32.1
		PRC04-32A16-8AF12.5				35.6
16-14	14	PRC04-32A16-14M12.5	25.0	50.0	12.5	30.5
		PRC04-32A16-14F12.5				34.8
20S-12	12	PRC04-32A20S-12M14.5	32.0	58.5	14.5	53.1
		PRC04-32A20S-12F14.5				58.5
20S-19	19	PRC04-32A20S-19M14.5	32.0	58.5	14.5	50.3
		PRC04-32A20S-19F14.5				57.1
26S-21	21	PRC04-32A26S-21M18	38.0	65.5	18.0	86.9
		PRC04-32A26S-21F18				96.2
26S-37	37	PRC04-32A26S-37M18	38.0	65.5	18.0	83.1
		PRC04-32A26S-37F18				95.0



■ Dust Caps for Receptacles

Materials—Polyethylene

Insert No.	Part Number	Dimension, millimeter	
		A	B
16-8A, 14	PRC04-16RC	27.5	14.0
20S-12, 19	PRC04-20RC	33.0	14.0
26S-21, 37	PRC04-26RC	39.5	14.0

○ Mounting Hole Dimensions

Bulkhead Type

Insert No.	Dimensions millimeter		
	A	B	C
16-8A, 14	21.2	20.2	9.6
20S-12, 19	26.2	25.2	12.1
26S-21, 37	32.2	31.2	15.1

Flange Mounting Type

Insert No.	Dimensions millimeter		
	A	B	C
16-8A, 14	21.5	21.3	3.4
20S-12, 19	26.0	26.3	3.9
26S-21, 37	31.0	32.3	3.9

INSTRUCTIONS FOR OPERATION

1. Connection

Holding the back of a slide ring by hand as shown in Photo, adjust an arrow mark on the receptacle guide to a grooved guide on the plug and push straightly. A characteristic click sounded when both are connected is an indication of a perfect connection.

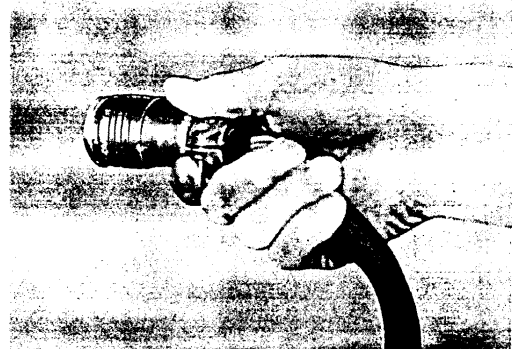
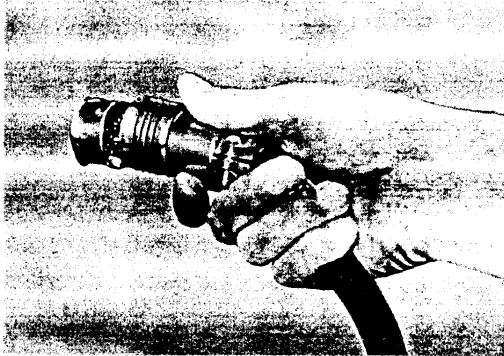

2. Disconnection

As shown in Photo, holding the slide ring by hand pull it forcibly in the straight direction, and the plug and receptacle are disengaged mechanically followed by an easier disconnection.

