

3 Digit 14.4mm (.6") Series

Conventional Part No.	Global Part No.	Lighting Color
LN536RAMR	LN236AA01	Amber
LN536RKMR	LNM236KA01	Amber
LN536GAMG	LNM336AA01	Orange
LN536GKMG	LNM336KA01	Orange

Terminal Connection

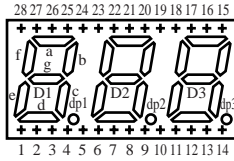

Pin No.	Assignment	Assignment
1	Cathode e1	Anode e1
2	Cathode d1	Anode d1
3	Common Anode D1	Common Cathode D1
4	Cathode c1	Anode c1
5	Cathode dp1	Anode dp1
6	Cathode e2	Anode e2
7	Cathode d2	Anode d2
8	Cathode e2	Anode e2
9	Cathode dp2	Anode dp2
10	Cathode e3	Anode e3
11	Cathode d3	Anode d3
12	Cathode g3	Anode g3
13	Cathode c3	Anode c3
14	Cathode dp3	Anode dp3
15	Cathode b3	Anode b3
16	Cathode a3	Anode a3
17	Cathode f3	Anode f3
18	Common Anode D3	Common Cathode D3
19	Common Anode D2	Common Cathode D2
20	Cathode b2	Anode b2
21	Cathode a2	Anode a2
22	Cathode g2	Anode g2
23	Cathode f2	Anode f2
24	Cathode b1	Anode b2
25	Cathode a1	Anode a1
26	Common Anode D1	Common Cathode D1
27	Cathode f1	Anode f1
28	Cathode g1	Anode g1

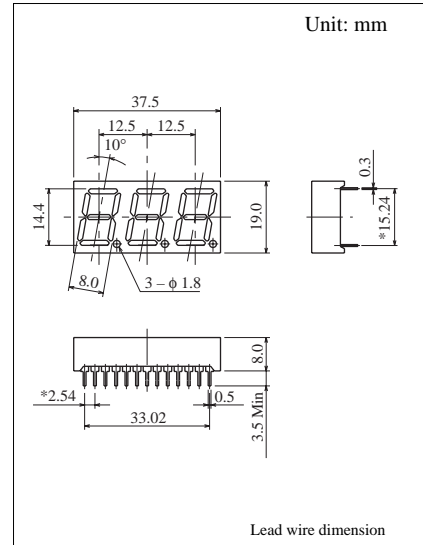

Absolute Maximum Ratings ($T_a = 25^\circ\text{C}$)

Lighting Color	P_D (mW)	I_F (mA)	I_{FP} (mA)*	V_R (V)	T_{opr} ($^\circ\text{C}$)	T_{stg} ($^\circ\text{C}$)
Red	50	20	100	5	-25 ~ +80	-30 ~ +85
Green	50	20	100	5	-25 ~ +80	-30 ~ +85

I_{FP} の条件は、duty 10%、Pulse width 1 msec. The condition of I_{FP} is duty 10%, Pulse width 1 msec

Electro-Optical Characteristics ($T_a = 25^\circ\text{C}$)

Conventional Part No.	Lighting Color	Common	I_O		I_F	V_F		λ_P	$\Delta\lambda$	I_F	I_R		
			Typ	Min		Typ	Max				Max	V_R	
LN533RAMR	Red	Anode	600	250	250	5	2.2	2.8	700	100	20	10	5
LN533RKMR	Red	Cathode	600	250	250	5	2.2	2.8	700	100	20	10	5
LN533GAMG	Green	Anode	1500	600	500	10	2.2	2.8	565	30	20	10	5
LN533GKMG	Green	Cathode	1500	600	500	10	2.2	2.8	565	30	20	10	5
Unit	—	—	μcd	μcd	μcd	mA	V	V	nm	nm	mA	μA	V

