

## SCHOTTKY DIODES STUD TYPE 30 A

### Features

- High Surge Capability
- Types up to 45V  $V_{RRM}$

**30Amp Rectifier  
35-45 Volts**

### Maximum Ratings

- Operating Temperature: -55 °C to +150 °C
- Storage Temperature: -55 °C to +175 °C

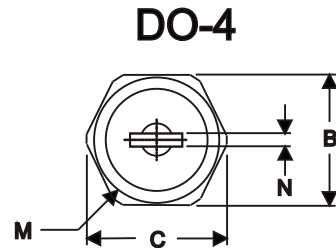

Part Number	Maximum Recurrent Peak Reverse Voltage	Maximum RMS Voltage	Maximum DC Blocking Voltage
SD41(R)	35V	25V	35V
SD4145(R)	45V	32V	45V

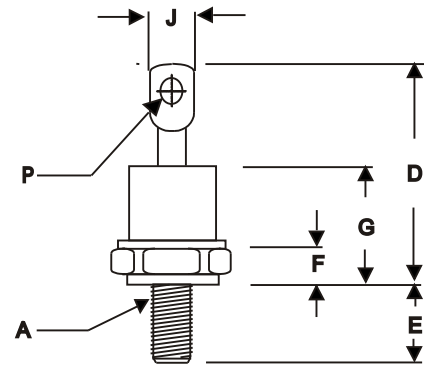

Notes:

- Standard Polarity: Stud is Cathode
- Reverse Polarity: Stud is Anode

### Electrical Characteristics @ 25 °C Unless Otherwise Specified

Average Forward Current	$I_{F(AV)}$	30A	$T_C = 140\text{ }^\circ\text{C}$
Peak Forward Surge Current	$I_{FSM}$	600A	8.3ms , Half sine
Maximum Instantaneous Forward Voltage <small>NOTE (1)</small>	$V_F$	0.68V	$I_{FM} = 30\text{ A};$ $T_J = 25\text{ }^\circ\text{C}$
Maximum Instantaneous Reverse Current At Rated DC Blocking Voltage <small>NOTE (1)</small>	$I_R$	1.5mA 25mA	$T_J = 25\text{ }^\circ\text{C}$ $T_J = 125\text{ }^\circ\text{C}$
Maximum thermal resistance, junction to case	$R_{\theta jc}$	1.5°C/W	
Mounting torque	Kgf-cm	11.0~13.4	Not lubricated threads

DIM	DIMENSIONS				NOTE
	INCHES		MM		
	MIN	MAX	MIN	MAX	
A	10-32	UNF3A	Threads	Standard	Polarity
B	.424	.437	10.77	11.10	
C	----	.505	----	12.82	
D	.600	.820	15.24	20.82	
E	.422	.453	10.72	11.50	
F	.075	.175	1.91	4.44	
G	----	.405	----	10.29	
J	----	.310	----	7.87	
M	----	.413	----	10.49	∅
N	.020	.065	0.51	1.65	
P	.060	.100	1.53	2.54	∅

NOTE :

- (1) Pulse Test: Pulse Width 300 usec, Duty Cycle < 2%

# SD41(R) THRU SD4145(R)

