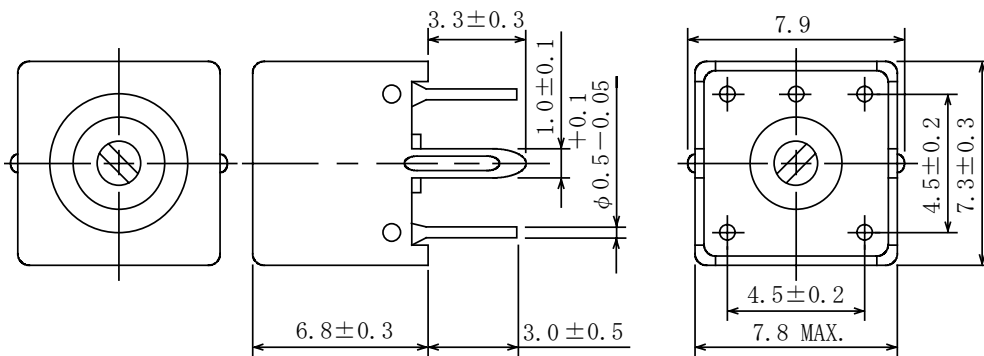

Type: S-7LDJ
◆ Product Description

- 8.1×7.8mm Max.(L×W), 7.1mm Max. Height.
- Inductance:0.1~4.0 μ H Max.
- Operating frequency:300MHz Max.
- In addition to the reference versions of parameters shown here, custom designs are available to meet your exact requirements.

◆ Feature

- Variable shielded type.
- RoHS Compliance

◆ Dimensions (mm)

- * Dimension does not include solder used on coil.
- * Pin pitch should be measured at the root of terminal.

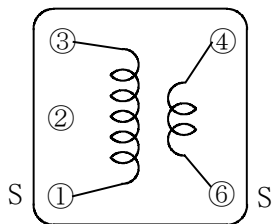
◆ Connection (Bottom View)

“S” is winding start.

◆ Specification (Part No.S0975791)

Item	(1-3)	Measuring Condition
Inductance	0.35μH±4% Variable	25.2MHz
Unloaded Qu	45 Min.	25.2MHz