

POWER LINE CHOKE (DRUM CORE STYLE)

Electrical Specifications at 25°C

Parameter	Min.	Typ.	Max.	Units
Inductance	160	200	240	μH
I _{MAX}		19.2		A
DCR		.019		Ω
Lead Diameter		.0808 (2.05)		inches (mm)

Applications

Power Amplifiers

Filters Power Supplies

SCR and Triac Controls

Speaker Crossover Networks

RFI Suppression

Test Conditions:

Inductance tested at 100 mV_{RMS} and 1 kHz

1. Current for 10% drop in Inductance

PHYSICAL DIMENSIONS All dimensions in inches

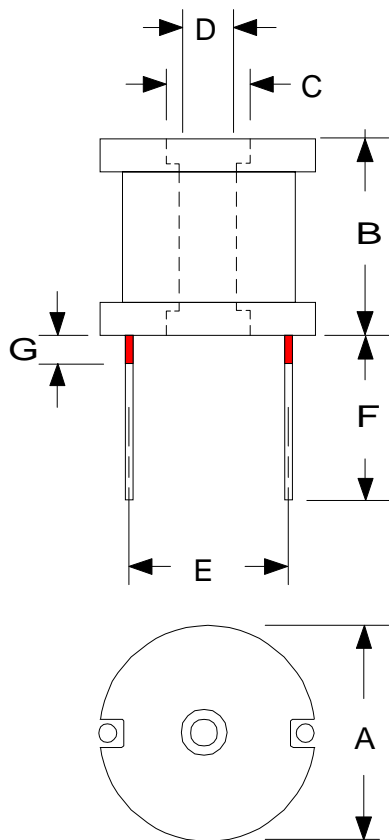

Dim.	inches
A	1.810
B	1.400
C	0.350
D	0.270
E	1.500
F	0.750
G	0.062

High Saturation

Pre-Tinned Leads

Center hole for mechanical mounting

Leads are .025 (# 11 AWG)

Leads tinned to within 1/16" of body.

RHOMBUS P/N: **L-12590**

CUST P/N:

NAME:

DATE: **08/17/01**

SHEET: 1 OF 1