

- ▶ 5 x 7 Footprint
- ▶ 2 Pole Filter
- ▶ Tape & Reel Packaging



ECS-96SMF 45.0 MHz

SMD CRYSTAL FILTER

The ECS-96SMF 45.000 MHz Miniature SMD Monolithic Crystal Filters offer a narrow bandwidth and a 2 pole response in a 5 x 7 package.

OPERATING CONDITIONS / ELECTRICAL CHARACTERISTICS

PART NUMBER *	CENTER FREQUENCY F ₀	PASSBAND MIN.		STOPBAND MAX.		ATTENUATION GUARANTEED MIN.		RIPPLE MAX.	LOSS MAX.	TERMINATING IMPEDANCE	OPERATING TEMPERATURE	NO. OF POLES
	MHz	dB	KHz	dB	KHz	dB	KHz	dB	dB	Ω/pF	°C	
ECS-96SMF45A7.5	45.000	3	± 3.75	20	± 25.0	70	-910	1.0	2.0	650//3.5	-30 ~ +80	2
ECS-96SMF45A12	45.000	3	± 6	15	± 20.0	70	-910	1.0	2.0	650//5.0	-30 ~ +80	2
ECS-96SMF45A15	45.000	3	± 7.5	15	± 25.0	70	-910	1.0	2.0	560//6.0	-30 ~ +80	2
ECS-96SMF45A30	45.000	3	± 15	15	± 60.0	70	-910	1.0	2.0	1200//1.8	-30 ~ +80	2

PACKAGE DIMENSIONS (mm)

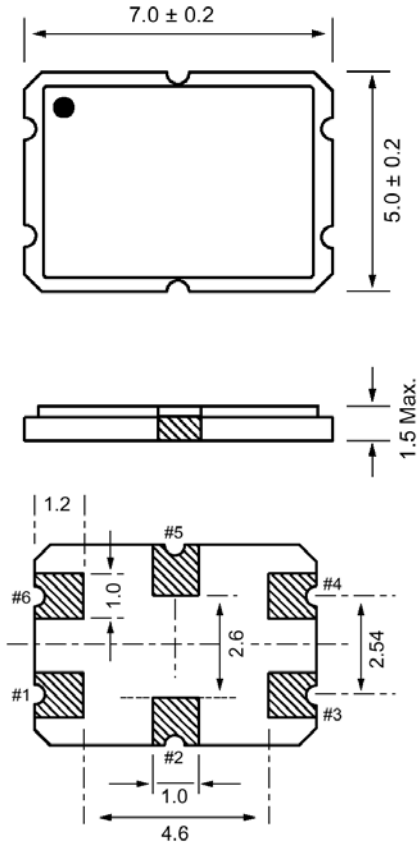

PIN CONNECTIONS	
#1	In/Out
#2	Ground
#3	Ground
#4	Out/In
#5	Ground
#6	Ground

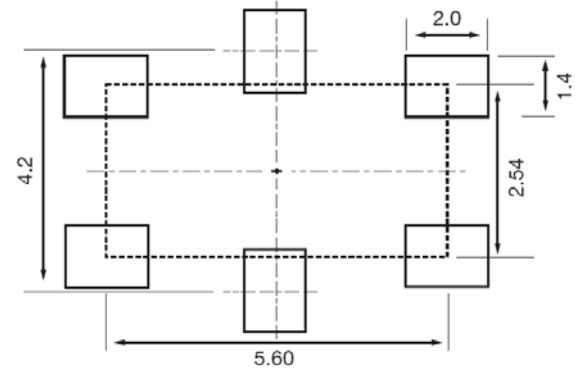

Figure 1) Top, Side and Bottom Views

Figure 2) Land Pattern