

BAT165WS

SCHOTTKY BARRIER DIODE

Features

- Medium current schottky rectifier diode

Applications

- For low-loss, fast-recovery, meter protection, bias isolation and clamping applications

PINNING

PIN	DESCRIPTION
1	Cathode
2	Anode

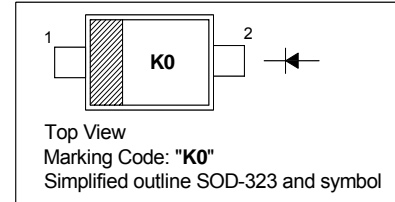

Absolute Maximum Ratings ($T_a = 25\text{ }^\circ\text{C}$)

Parameter	Symbol	Value	Unit
Reverse Voltage	V_R	40	V
Average forward current	I_{FAV}	500	mA
Forward Current	I_F	750	mA
Surge Forward Current ($t \leq 10\text{ ms}$)	I_{FSM}	2.5	A
Total Power Dissipation	P_{tot}	600	mW
Junction Temperature	T_J	150	$^\circ\text{C}$
Storage Temperature Range	T_s	- 65 to + 150	$^\circ\text{C}$

Characteristics at $T_a = 25\text{ }^\circ\text{C}$

Parameter	Symbol	Max.	Unit
Forward Voltage at $I_F = 10\text{ mA}$ at $I_F = 250\text{ mA}$	V_F	0.4 0.7	V
Reverse Current at $V_R = 30\text{ V}$ at $V_R = 30\text{ V}, T_a = 65\text{ }^\circ\text{C}$	I_R	50 900	μA
Diode Capacitance at $V_R = 10\text{ V}, f = 1\text{ MHz}$	C_T	12	pF

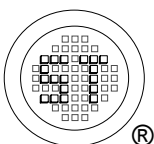

SEMTECH ELECTRONICS LTD.

(Subsidiary of Sino-Tech International Holdings Limited, a company listed on the Hong Kong Stock Exchange, Stock Code: 724)



Dated : 01/09/2006

Diode capacitance $C_T = f(V_R)$

$f = 1\text{MHz}$

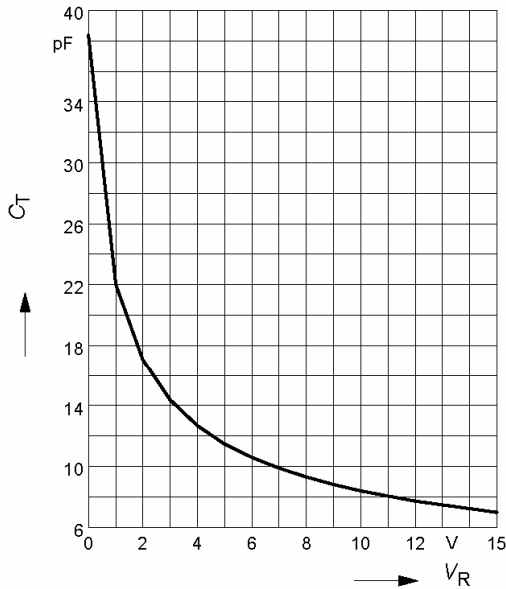

Reverse current $I_R = f(V_R)$

$T_A = \text{Parameter}$

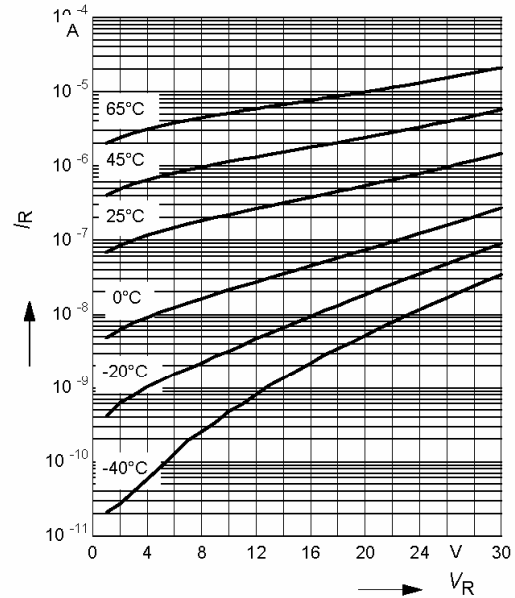

Forward current $I_F = f(V_F)$

$T_A = \text{Parameter}$

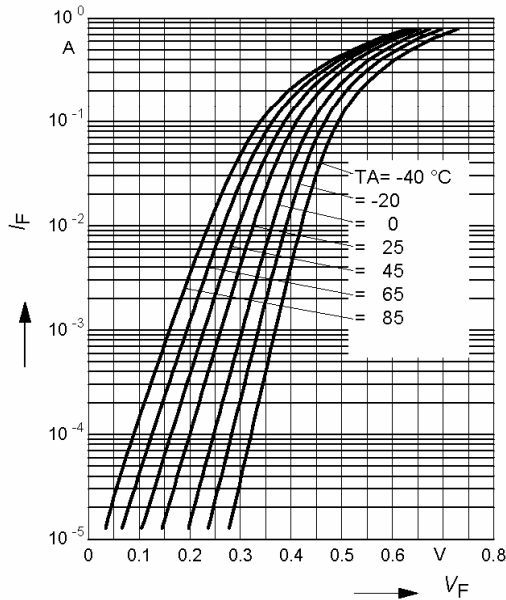

Forward current $I_F = f(T_S)$

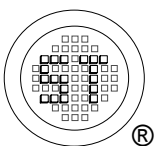
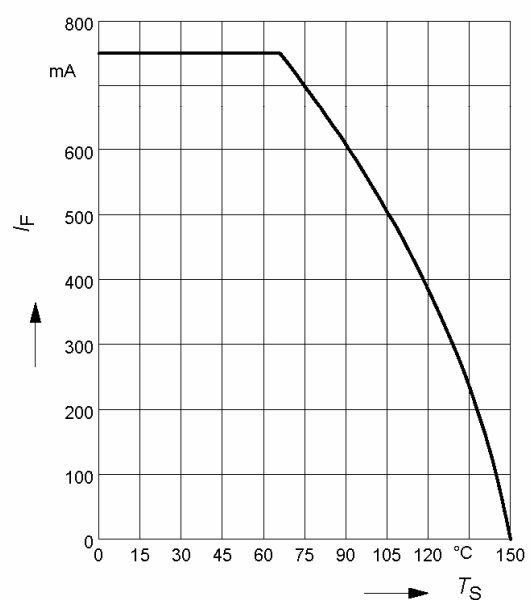

SEMTECH ELECTRONICS LTD.

(Subsidiary of Sino-Tech International Holdings Limited, a company listed on the Hong Kong Stock Exchange, Stock Code: 724)



ISO/TS 16949 : 2002 Certificate No. 05103
 ISO 14001:2004 Certificate No. 7116
 ISO 9001:2000 Certificate No. 0506098

Dated : 01/09/2006

BAT165WS

PACKAGE OUTLINE

Plastic surface mounted package; 2 leads

SOD-323

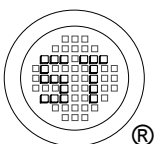
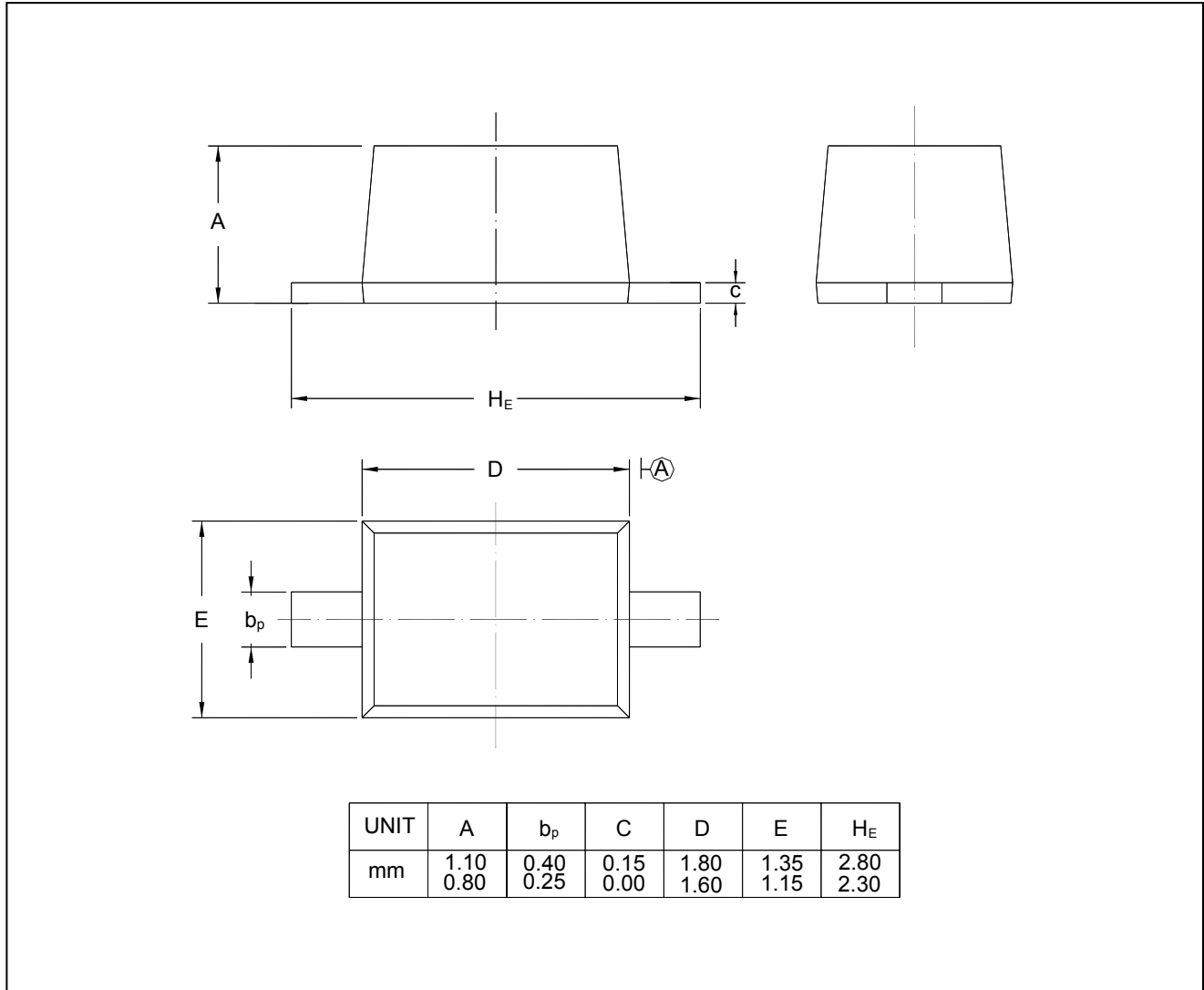

SEMTECH ELECTRONICS LTD.
 (Subsidiary of Sino-Tech International Holdings Limited, a company
 listed on the Hong Kong Stock Exchange, Stock Code: 724)



Dated : 01/09/2006