



TAI-SAW TECHNOLOGY CO., LTD.

No. 3, Industrial 2nd Rd., Ping-Chen Industrial District,
Tao-Yuan, 324, Taiwan, R.O.C.

TEL: 886-3-4690038 FAX: 886-3-4697532

E-mail: tstsales@mail.taisaw.com Web: www.taisaw.com

Approval Sheet for Product Specification

Issued Date:

Product Name: 380MHz IF SAW Filter (BW=5 MHz)

TST Parts No.: TB0445A

Customer Parts No.: _____

| |
|---------------------|
| Company: _____ |
| Division: _____ |
| Approved by : _____ |
| Date: _____ |

Checked by: _____ Andy Yu

Approval by: _____ Francis Chen

Date: _____ 12/26/2006



TAI-SAW TECHNOLOGY CO., LTD.

No.3, Industrial 2nd Rd., Ping-Chen Industrial District, Taoyuan, Taiwan, R.O.C.

TEL: 886-3-4690038 FAX: 886-3-4697532

E-mail: tstsales3@mail.taisaw.com Web: www.taisaw.com

SAW Filter 380MHz (SMD 5.0×7.0 mm)

MODEL NO.: TB0445A

Rev. NO. 1.0

A. MAXIMUM RATINGS:

1. Operating Temperature: -10°C to 75°C
2. Storage Temperature: -40°C to 85°C
3. Input Power: 15dBm

RoHS Compliant
Lead free
Lead-free soldering

B. ELECTRICAL CHARACTERISTICS:

1. Ambient Temperature: 25 °C

| Characteristics | Value | | | Note |
|--|--------|--------|--------|------|
| | Min. | Typ. | Max. | |
| Center frequency F_C MHz | - | 380 | - | - |
| Minimum Insertion loss I.L. dB | - | 11.5 | 13.0 | - |
| Lower 1.5 dB Bandwidth MHz | - | 377.67 | 377.90 | - |
| Upper 1.5 dB Bandwidth MHz | 382.10 | 382.34 | - | - |
| Lower 10 dB Bandwidth MHz | 376.65 | 376.79 | - | - |
| Upper 10 dB Bandwidth MHz | - | 383.17 | 383.35 | - |
| Lower 20 dB Bandwidth MHz | 376.25 | 376.40 | - | - |
| Upper 20 dB Bandwidth MHz | - | 383.56 | 383.75 | - |
| Lower 30 dB Bandwidth MHz | 375.85 | 376.12 | - | - |
| Upper 30 dB Bandwidth MHz | - | 383.83 | 384.15 | - |
| Passband Ripple 377.9-382.1MHz dB p-p | - | 0.2 | 1.0 | - |
| Amplitude Variation 377.9-382.1MHz dB p-p | - | 0.88 | 1.5 | - |
| Group Delay 377.9-382.1MHz usec | - | 0.94 | - | - |
| Group Delay Variation 377.9-382.1MHz nsec | - | 30 | 120 | - |
| Source Impedance (Balanced) ohm | - | 100 | - | - |
| Load Impedance (Balanced) ohm | - | 100 | - | - |

C. FREQUENCY CHARACTERISTICS

(1) S21 Response: (span 20MHz)

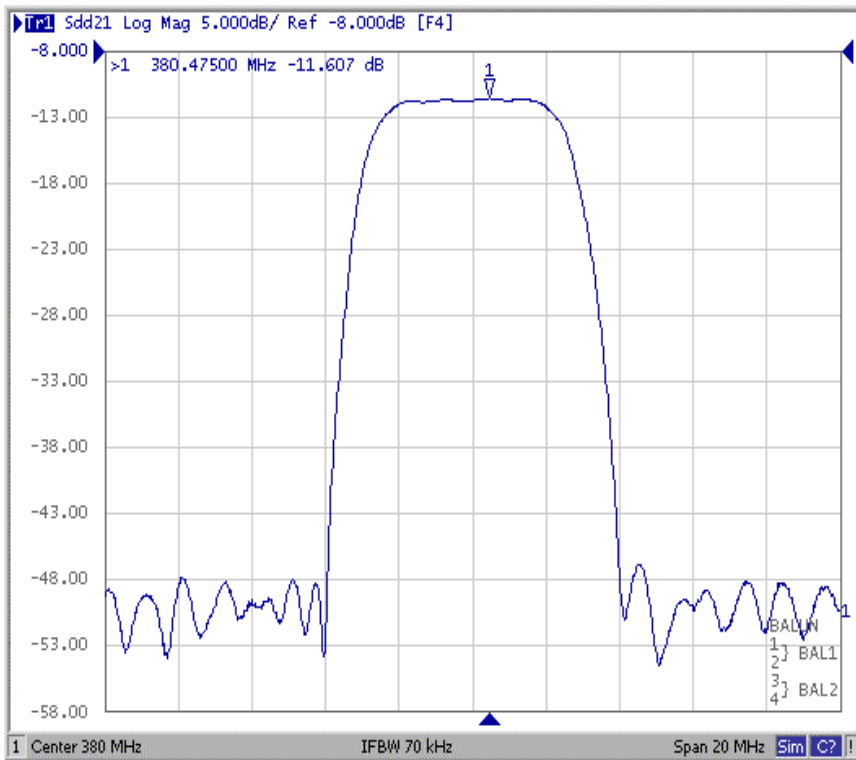

(2) Passband Response: (span 8MHz)

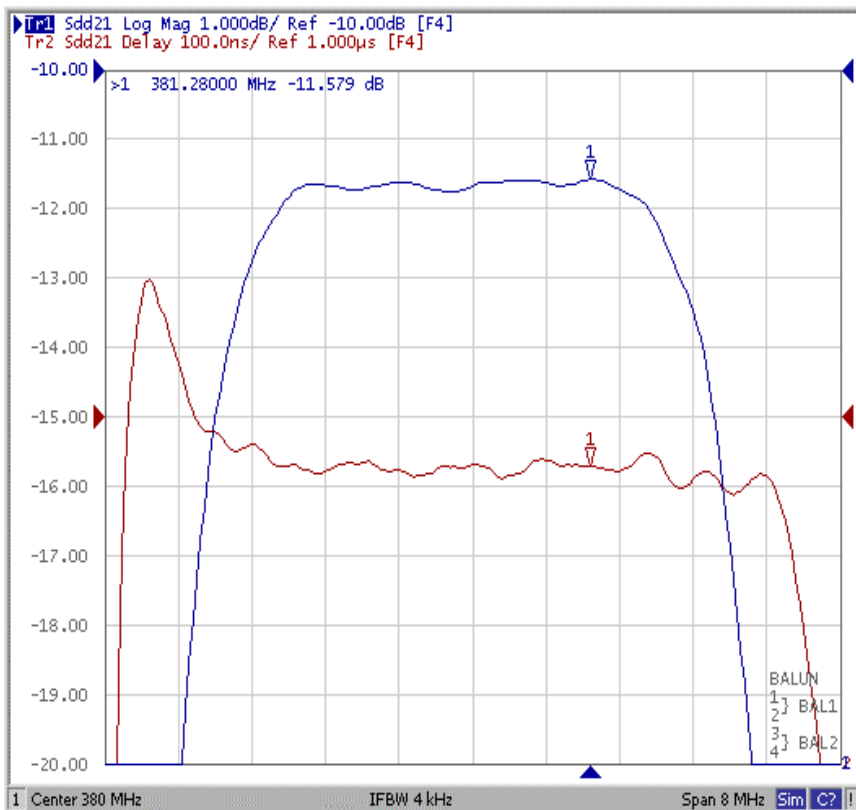

D. TEST CIRCUIT:

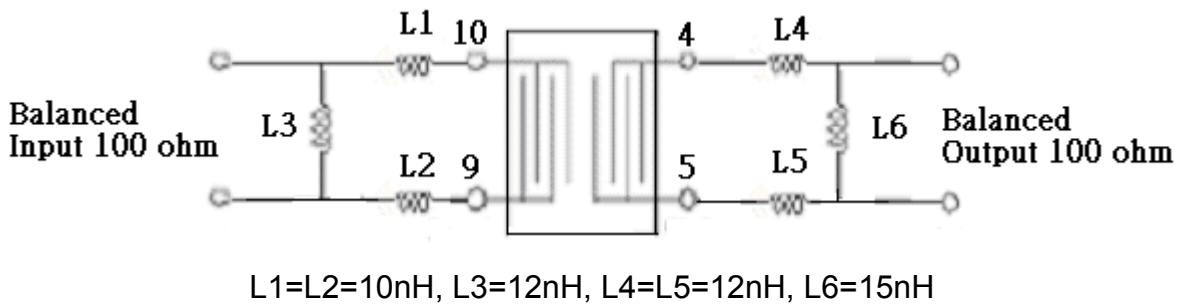

E. OUTLINE DRAWING:

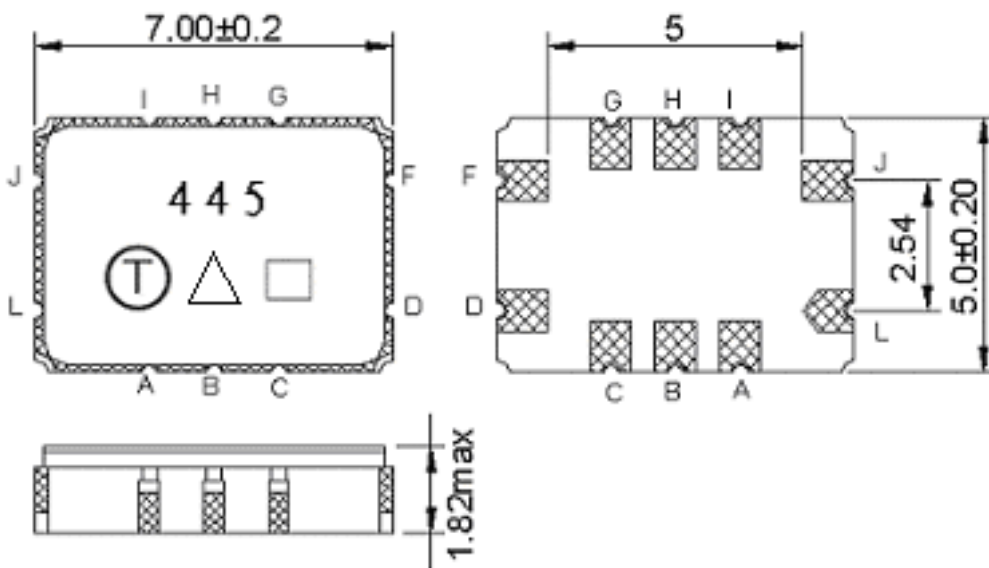

- Pin J : Input or Balance Input
- Pin L : Input or Balance Input
- Pin D: Output or balanced Input
- Pin F : Output or balanced Input
- Pin A, B, C, I , H, G: To be Ground
- : Week Code (Follow the table from planner each year)
- Unit : mm
- △ : Product / Year Code

| | | | | |
|--------------|--------------|--------------|--------------|--------------|
| Year | 2005 2009 | 2006 2010 | 2007 2011 | 2008 2012 |
| Product Code | B | b | <u>B</u> | <u>b</u> |

F.PACKING:

1.REEL DIMENSION

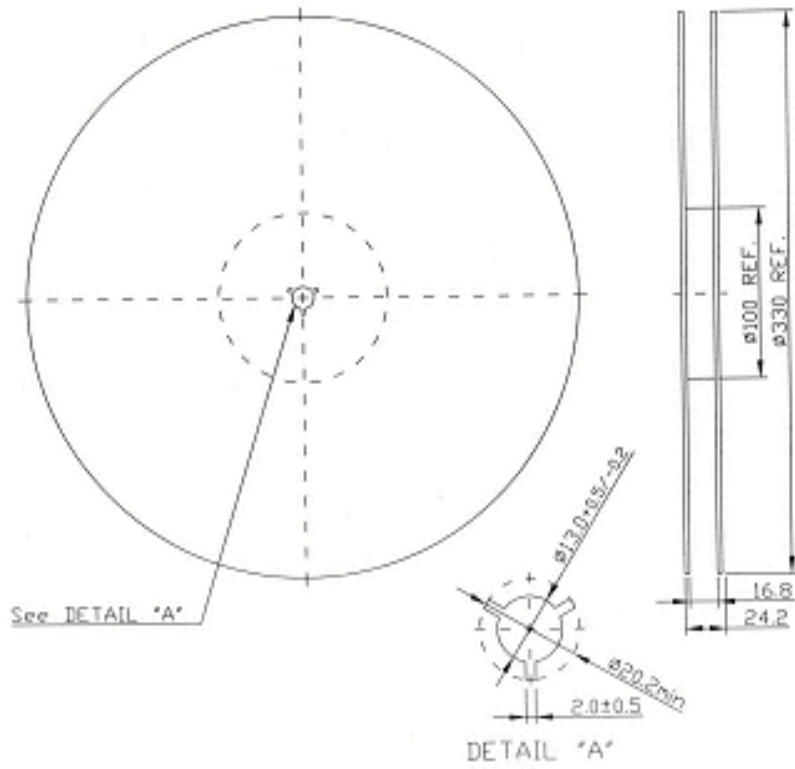

2.TAPE DIMENSION

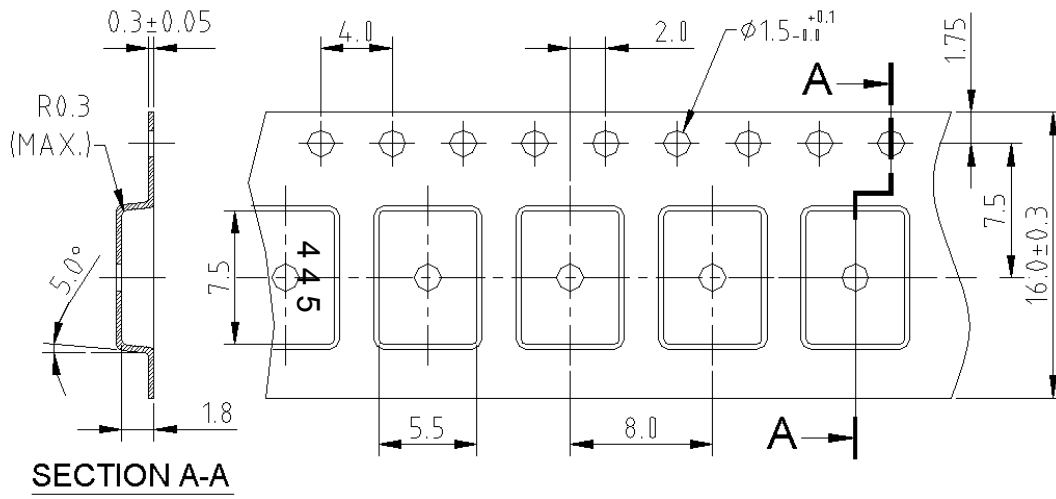

→
Direction of feed

G. Recommended Reflow Profile:

