



**SHIELDED SMD POWER INDUCTOR DR364 SERIES**

**Features**

- Low Profile Surface Mount Design (Height 3.5mm / 0.138 inches)
- Shielded and suitable for large current
- Inductance Range from 1.0µH to 150µH
- Ideal for variety of DC-DC Converter applications and DSC, DVC, PDA Products
- Operating Temperature : -20°C to +85°C
- Operating Frequency Range : 10kHz – 1MHz
- Tinned Leads with Leaded Solder is Available (note 4)



**Electrical Specifications at 25°C**

Part Number	L (µH) ±20%	Test Freq. (0.1V)	DCR (mΩ) Max (Typ.)	Rated Current (A) Max	
				I sat	I rms
DR364-202	2.0	100kHz	19.2 (16.0)	3.00	3.31
DR364-272	2.7	100kHz	22.0 (18.3)	2.69	3.12
DR364-332	3.3	100kHz	25.7 (21.4)	2.57	2.81
DR364-472	4.7	100kHz	31.6 (26.3)	2.08	2.51
DR364-622	6.2	100kHz	34.9 (29.1)	1.84	5.41
DR364-822	8.2	100kHz	43.4 (36.2)	1.54	2.11
DR364-103	10.0	100kHz	49.4 (41.2)	1.49	1.97
DR364-123	12.0	100kHz	62.0 (51.7)	1.28	1.73
DR364-153	15.0	100kHz	76.9 (64.1)	1.10	1.54
DR364-183	18.0	100kHz	81.5 (67.9)	1.05	1.52
DR364-223	22.0	100kHz	106.0 (88.4)	0.97	1.29
DR364-273	27.0	100kHz	140.0 (117.0)	0.82	1.11
DR364-333	33.0	100kHz	162.0 (135.0)	0.76	1.02
DR364-393	39.0	100kHz	191.0 (159.0)	0.70	0.96
DR364-473	47.0	100kHz	209.0 (174.0)	0.68	0.89
DR364-563	56.0	100kHz	257.0 (214.0)	0.60	0.80
DR364-683	68.0	100kHz	319.0 (266.0)	0.56	0.71
DR364-823	82.0	100kHz	419.0 (349.0)	0.47	0.61
DR364-104	100.0	100kHz	476.0 (397.0)	0.45	0.57
DR364-154	150.0	100kHz	664.0 (553.0)	0.37	0.48

**MECHANICAL OUTLINES**

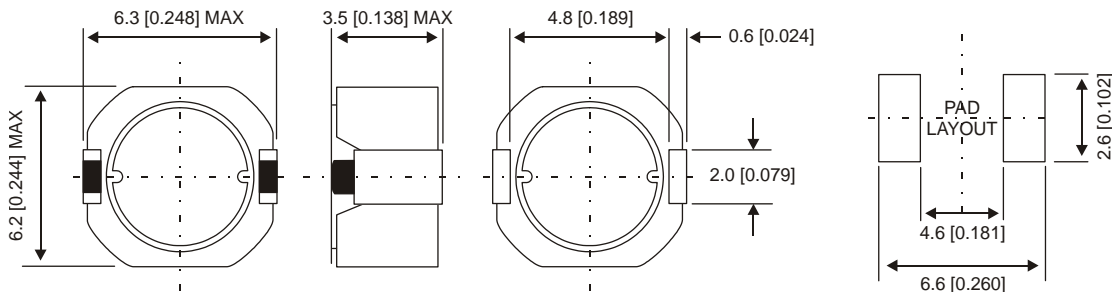

**Notes:**

1. All dimensions are given in millimeters "mm" (Inches "IN" ref)
2. Unless otherwise specified, tolerance; ± 0,254mm, (0.010 IN)
3. Tape and reel quantity, 2000 pcs/reel
4. For non-RoHS parts replace DR prefix with 42- (e.g. DR364 becomes 42-364)
5. Terminal finish is compliant to RoHS requirements. Solder in accordance with J-STD-020C