

PLEASE CHECK WWW.MOLEX.COM FOR LATEST PART INFORMATION

Part Number: [0009626085](#)
Status: **Active**
Description: 3.96mm (.156") Pitch KK® PC Board Connector, Top Entry, Nylon Connector, 5.0µm (200µ") Tin (Sn), 8 Circuits

Documents:

[3D Model](#) [Product Specification PS-08-50 \(PDF\)](#)
[Drawing \(PDF\)](#) [RoHS Certificate of Compliance \(PDF\)](#)

Agency Certification

UL E29179

General

Product Family PCB Receptacles
 Series [2145](#)
 Application Board-to-Board
 Product Name KK®

Physical

Circuits (Loaded) 8
 Color - Resin Natural
 Flammability 94V-2
 Glow-Wire Compliant No
 Keying to Mating Part Yes
 Lock to Mating Part Yes
 Material - Metal Phosphor Bronze
 Material - Plating Mating Tin
 Material - Plating Termination Tin
 Material - Resin Nylon
 Number of Rows 1
 Orientation Vertical
 PC Tail Length (in) 0.120 In
 PC Tail Length (mm) 3.05 mm
 PCB Locator No
 PCB Retention None
 PCB Thickness Recommended (in) 0.062 In
 PCB Thickness Recommended (mm) 1.60 mm
 Packaging Type Bag
 Pitch - Mating Interface (in) 0.156 In
 Pitch - Mating Interface (mm) 3.96 mm
 Plating min: Mating (µin) 200
 Plating min: Mating (µm) 5.00
 Plating min: Termination (µin) 200
 Plating min: Termination (µm) 5.00
 Polarized to PCB No
 Temperature Range - Operating 0°C to +75°C
 Termination Interface: Style Through Hole

Electrical

Current - Maximum per Contact 5A
 Voltage - Maximum 250V

Solder Process Data

Duration at Max. Process Temperature (seconds) 5
 Lead-free Process Capability Wave Capable (TH only)
 Max. Cycles at Max. Process Temperature 1
 Process Temperature max. C 235

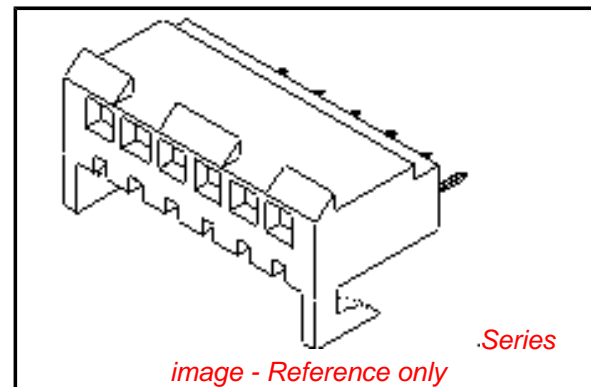

EU RoHS

**ELV and RoHS
 Compliant**
**REACH SVHC
 Contains SVHC: No**
**Halogen-Free
 Status**

China RoHS



Not Reviewed

**Need more information on product
 environmental compliance?**

Email productcompliance@molex.com
 For a multiple part number RoHS Certificate of
 Compliance, [click here](#)

Please visit the [Contact Us](#) section for any
 non-product compliance questions.

Search Parts in this Series
[2145Series](#)

Material Info

Old Part Number

A-2145-CA08B-102

Reference - Drawing Numbers

Product Specification

PS-08-50

Sales Drawing

SDA-2145-002

This document was generated on 04/14/2010

PLEASE CHECK WWW.MOLEX.COM FOR LATEST PART INFORMATION

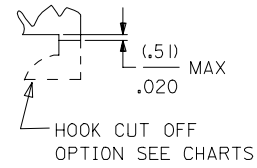
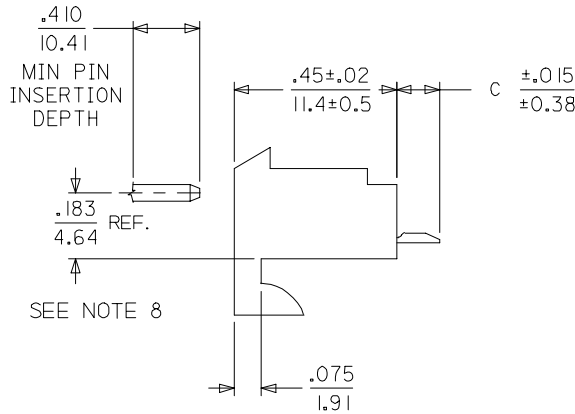
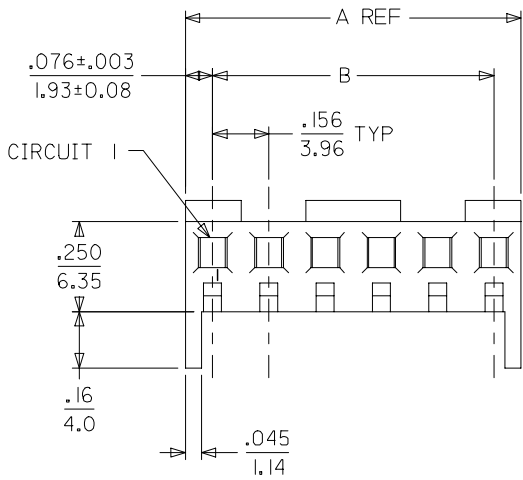

- NOTES:
- HOUSING MATERIAL: NYLON, UL 94V-2
 - FINISH:
 - (909) = OVERALL HOT TIN DIP: .000100/0.00254 MIN.
 - (501) = OVERALL GOLD: .000020/0.00051 MIN.
 - OVERALL NICKLE UNDERPLATE: .000030/0.00076 MIN.
 - (102) = OVERALL TIN: .000200/0.00508 MIN.
 - OVERALL COPPER UNDERPLATE: .000100/0.00254 MIN.
 - (208) = SELECT GOLD: .000015/0.00038 MIN.
 - SELECT TIN: .000100/0.00254 MIN.
 - OVERALL NICKEL UNDERPLATE: .000050/0.00127 MIN.
 - PRODUCT SPECIFICATION: PS-08-50
 - PACKAGING INFO: SEE CHARTS
 - SOLDERABILITY SPECIFICATION: SMES-152
 - RIGHT ANGLE OPTIONS SEE DRAWING SDA-2145-001
 - BOTTOM ENTRY OPTIONS SEE DRAWING SDA-2145-003
 - .183/4.64 DIMENSION IS BOTTOM OF HOUSING TO CENTER OF MATING PIN AND DOES NOT REFLECT CENTER OF CONNECTOR HOUSING WINDOW DIMENSION.
 - THIS PART CONFORMS TO CLASS B REQUIREMENTS OF COSMETIC SPECIFICATION PS-45499-002.

| CKT | A | | B | |
|-----|-------|-------|------------|------------|
| | | | | |
| 02 | .308 | 7.82 | .156±.005 | 3.96±0.13 |
| 03 | .464 | 11.79 | .312±.005 | 7.92±0.13 |
| 04 | .620 | 15.75 | .468±.005 | 11.89±0.13 |
| 05 | .776 | 19.71 | .624±.005 | 15.85±0.13 |
| 06 | .932 | 23.67 | .780±.005 | 19.81±0.13 |
| 07 | 1.088 | 27.64 | .936±.010 | 23.77±0.25 |
| 08 | 1.244 | 31.60 | 1.092±.010 | 27.74±0.25 |
| 09 | 1.400 | 35.56 | 1.248±.010 | 31.70±0.25 |
| 10 | 1.556 | 39.52 | 1.404±.010 | 35.66±0.25 |
| 11 | 1.712 | 43.48 | 1.560±.010 | 39.62±0.25 |
| 12 | 1.868 | 47.45 | 1.716±.010 | 43.59±0.25 |
| 13 | 2.024 | 51.41 | 1.872±.010 | 47.55±0.25 |
| 14 | 2.180 | 55.37 | 2.028±.014 | 51.51±0.36 |
| 15 | 2.336 | 59.33 | 2.184±.014 | 55.47±0.36 |

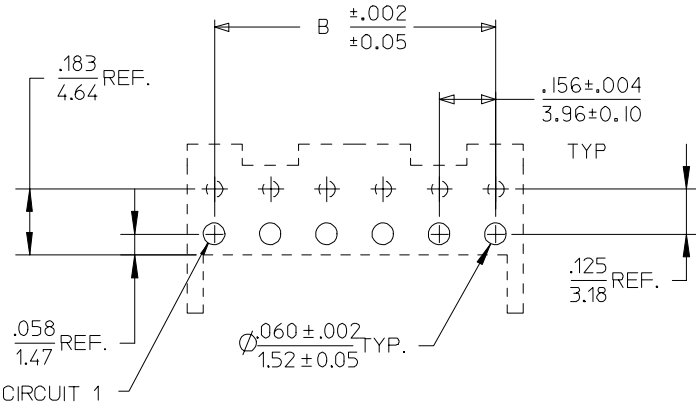

PCB LAYOUT: COMPONENT SIDE
RECOMMENDED PCB THICKNESS: .062/1.57

| | |
|------|------|
| 2-4 | Y1 |
| 1 | Y4 |
| SHT. | REV. |

| | | | | | | | | | |
|--|--------------------|---|---|------------------------------------|--|--|-----------|-------------------|------------------------|
| UPDATE PCB VIEW EC NO: UCP2007-2776 DRWN:PRIDDER 2007/05/02 CHKD:ADERR 2007/05/03 APPR:FSMITH 2007/05/07 Y4 | DESCRIPTION REV | QUALITY SYMBOLS ▽=0 ▽=0 | GENERAL TOLERANCES (UNLESS SPECIFIED) | | DIMENSION STYLE IN/MM | | SCALE --- | DESIGN UNITS INCH | THIRD ANGLE PROJECTION |
| | | 4 PLACES ± --- ± --- 3 PLACES ± --- ±.010 2 PLACES ±0.25 ±.014 1 PLACE ±0.36 ± --- | mm INCH | DRAWN BY DATE SAMIEC 2003/01/16 | TITLE KK 156 HOUSING ASSY PC TAIL TOP ENTRY | | | | |
| | | ANGULAR ±1/2° | APPROVED BY DATE MARGULIS 2003/01/16 | MOLEX MOLEX INCORPORATED | | | | | |
| | | DRAFT WHERE APPLICABLE MUST REMAIN WITHIN DIMENSIONS | MATERIAL NO. SEE CHART | DOCUMENT NO. SDA-2145-002 | SHEET NO. 1 OF 4 | | | | |



KK 156 PCB ASSY 2-15 CKT

2145 TOP ENTRY SERIES

CATALOG PRODUCTS

| | | | | |
|---------|--------------|---------------------|--------------|---------------------|
| OPTIONS | RAMPS | YES | RAMPS | YES |
| | HOOKS: | YES | HOOKS: | YES |
| | COLOR: | WHITE | COLOR: | WHITE |
| | MOLD VOID: | NONE | MOLD VOID: | NONE |
| | TERM MATL: | PHOS BRONZE | TERM MATL: | PHOS BRONZE |
| | CONTACT: | STANDARD | CONTACT: | STANDARD |
| | PC TAIL (C): | .120 / 3.05 | PC TAIL (C): | .120 / 3.05 |
| | PLT CODE: | 102 – TIN | PLT CODE: | 208 – 15 GOLD |
| | TERM VOID: | NONE | TERM VOID: | NONE |
| | PACKAGING: | TRAY PK-2145-001 | PACKAGING: | TRAY PK-2145-001 |
| Ckt | Material No | Material No | | |
| 2 | 09-62-6025 | 09-62-4029 | | |
| 3 | 09-62-6035 | 09-62-4039 | | |
| 4 | 09-62-6045 | 09-62-4049 | | |
| 5 | 09-62-6055 | 09-62-4059 | | |
| 6 | 09-62-6065 | 09-62-4069 | | |
| 7 | 09-62-6075 | 09-62-4079 | | |
| 8 | 09-62-6085 | 09-62-4089 | | |
| 9 | 09-62-6095 | 09-62-4099 | | |
| 10 | 09-62-6105 | 09-62-4109 | | |
| 11 | 09-62-6115 | 09-62-4119 | | |
| 12 | 09-62-6125 | 09-62-4129 | | |
| 13 | 09-62-6135 | 09-62-4139 | | |
| 14 | 09-62-6145 | 09-62-4149 | | |
| 15 | 09-62-6155 | 09-62-4159 | | |

| | | | |
|--|--|--|-------------------------------------|
| REV: Y1 | ADDA-2145-FANA501 UCP2005-0149 7/20/2004 SCHAFFER | TITLE: | SHEET No. |
| | | KK 156 PCB ASSY 2145 TOP ENTRY SERIES | - 2 - |
| DOCUMENT NUMBER: SDA-2145-002 | | CREATED / REVISED BY: SAMIEC | CHECKED BY: SAMIEC |
| | | APPROVED BY: MARGULIS | |



KK 156 PCB ASSY 2-15 CKT

2145 TOP ENTRY SERIES

CUSTOM PRODUCTS

| OPTIONS | RAMPS | YES | RAMPS | YES | RAMPS | YES | RAMPS | YES |
|---------|--------------|---------------------|--------------|---------------------|--------------|---------------------|--------------|---------------------|
| | HOOKS: | YES | HOOKS: | YES | HOOKS: | CUT OFF | HOOKS: | YES |
| | COLOR: | WHITE | COLOR: | WHITE | COLOR: | WHITE | COLOR: | WHITE |
| | MOLD VOID: | NONE | MOLD VOID: | NONE | MOLD VOID: | NONE | MOLD VOID: | NONE |
| | TERM MATL: | BRASS | TERM MATL: | BRASS | TERM MATL: | BRASS | TERM MATL: | BRASS |
| | CONTACT: | STANDARD | CONTACT: | STANDARD | CONTACT: | STANDARD | CONTACT: | STANDARD |
| | PC TAIL (C): | .120 / 3.05 | PC TAIL (C): | .189 / 4.80 | PC TAIL (C): | .120 / 3.05 | PC TAIL (C): | .120 / 3.05 |
| | PLT CODE: | 102 – TIN | PLT CODE: | P909 – TIN | PLT CODE: | P909 – TIN | PLT CODE: | P909 – TIN |
| | TERM VOID: | NONE | TERM VOID: | NONE | TERM VOID: | NONE | TERM VOID: | NONE |
| | PACKAGING: | TRAY PK-2145-001 | PACKAGING: | TRAY PK-2145-001 | PACKAGING: | TRAY PK-2145-001 | PACKAGING: | TRAY PK-2145-001 |
| Ckt | Material No | | Material No | | Material No | | Material No | |
| 2 | 09-52-1023 | | 09-52-1029 | | | | 09-52-3023 | |
| 3 | 09-52-1033 | | 09-52-1039 | | 09-52-3034 | | 09-52-3033 | |
| 4 | 09-52-1043 | | 09-52-1049 | | 09-52-3044 | | 09-52-3043 | |
| 5 | 09-52-1053 | | 09-52-1059 | | 09-52-3054 | | 09-52-3053 | |
| 6 | 09-52-1063 | | 09-52-1069 | | 09-52-3064 | | 09-52-3063 | |
| 7 | 09-52-1073 | | 09-52-1079 | | | | 09-52-3073 | |
| 8 | 09-52-1083 | | 09-52-1089 | | 09-52-3089 | | 09-52-3083 | |
| 9 | 09-52-1093 | | 09-52-1099 | | 09-52-3094 | | 09-52-3093 | |
| 10 | 09-52-1103 | | 09-52-1109 | | | | 09-52-3103 | |
| 11 | 09-52-1113 | | 09-52-1119 | | | | 09-52-3113 | |
| 12 | 09-52-1123 | | 09-52-1129 | | | | 09-52-3123 | |
| 13 | 09-52-1133 | | 09-52-1139 | | | | 09-52-3133 | |
| 14 | 09-52-1143 | | 09-52-1149 | | | | 09-52-3143 | |
| 15 | 09-52-1153 | | 09-52-1159 | | | | 09-52-3153 | |

| | | | |
|---------------------|---|---|-----------------|
| REV: | ADDA-2145-FANA501 UCP2005-0149 7/20/2004 SCHAFFER | TITLE: | SHEET No. |
| Y1 | | <h1 style="margin: 0;">KK 156 PCB ASSY</h1> <h2 style="margin: 0;">2145 TOP ENTRY SERIES</h2> | - 3 - |
| DOCUMENT NUMBER: | CREATED / REVISED BY: | CHECKED BY: | APPROVED BY: |
| SDA-2145-002 | SAMIEC | SAMIEC | MARGULIS |



KK 156 PCB ASSY 2-15 CKT

2145 TOP ENTRY SERIES

CUSTOM PRODUCTS

| OPTIONS | RAMPS | NO | RAMPS | YES | RAMPS | YES | RAMPS | YES |
|---------|--------------|---------------------|--------------|---------------------|--------------|---------------------|--------------|---------------------|
| | HOOKS: | CUT OFF | HOOKS: | YES | HOOKS: | YES | HOOKS: | CUT OFF |
| | COLOR: | WHITE | COLOR: | WHITE | COLOR: | WHITE | COLOR: | WHITE |
| | MOLD VOID: | NONE | MOLD VOID: | NONE | MOLD VOID: | NONE | MOLD VOID: | NONE |
| | TERM MATL: | BRASS | TERM MATL: | BRASS | TERM MATL: | PHOS BRONZE | TERM MATL: | BRASS |
| | CONTACT: | STANDARD | CONTACT: | STANDARD | CONTACT: | STANDARD | CONTACT: | STANDARD |
| | PC TAIL (C): | .120 / 3.05 | PC TAIL (C): | .120 / 3.05 | PC TAIL (C): | .120 / 3.05 | PC TAIL (C): | .120 / 3.05 |
| | PLT CODE: | P909 – TIN | PLT CODE: | 208 – 15 GOLD | PLT CODE: | P909 – TIN | PLT CODE: | 501-20 GOLD |
| | TERM VOID: | NONE | TERM VOID: | NONE | TERM VOID: | NONE | TERM VOID: | NONE |
| | PACKAGING: | TRAY PK-2145-001 | PACKAGING: | TRAY PK-2145-001 | PACKAGING: | TRAY PK-2145-001 | PACKAGING: | TRAY PK-2145-001 |
| Ckt | Material No | | Material No | | Material No | | Material No | |
| 2 | 09-52-1025 | | 09-62-3023 | | 09-52-2029 | | | |
| 3 | 09-52-1035 | | 09-62-3033 | | 09-52-2039 | | | |
| 4 | 09-52-1045 | | 09-62-3043 | | 09-52-2049 | | | |
| 5 | 09-52-1055 | | 09-62-3053 | | 09-52-2059 | | | |
| 6 | 09-52-1065 | | 09-62-3063 | | 09-52-2069 | | 50-29-1694 | |
| 7 | 09-52-1075 | | 09-62-3073 | | 09-52-2079 | | | |
| 8 | 09-52-1085 | | 09-62-3083 | | 09-52-2089 | | | |
| 9 | 09-52-1095 | | 09-62-3093 | | 09-52-2099 | | | |
| 10 | 09-52-1105 | | 09-62-3103 | | 09-52-2109 | | | |
| 11 | 09-52-1115 | | 09-62-3113 | | 09-52-2119 | | | |
| 12 | 09-52-1125 | | 09-62-3123 | | 09-52-2129 | | | |
| 13 | 09-52-1135 | | 09-62-3133 | | 09-52-2139 | | | |
| 14 | 09-52-1145 | | 09-62-3143 | | 09-52-2149 | | | |
| 15 | 09-52-1155 | | 09-62-3153 | | 09-52-2159 | | | |

| | | | | |
|--|--|--|---|--|
| REV: Y1 | ADDA-2145-FANA501 UCP2005-0149 7/20/2004 SCHAFFER | TITLE: <h2 style="text-align: center;">KK 156 PCB ASSY</h2> <h2 style="text-align: center;">2145 TOP ENTRY SERIES</h2> | SHEET No. - 4 - | |
| DOCUMENT NUMBER: <h3 style="text-align: center;">SDA-2145-002</h3> | | CREATED / REVISED BY: <h3 style="text-align: center;">SAMIEC</h3> | CHECKED BY: <h3 style="text-align: center;">SAMIEC</h3> | APPROVED BY: <h3 style="text-align: center;">MARGULIS</h3> |