

C&K RTBH Series 1-2 Pole Coded Rotary Switches

DESIGNATION

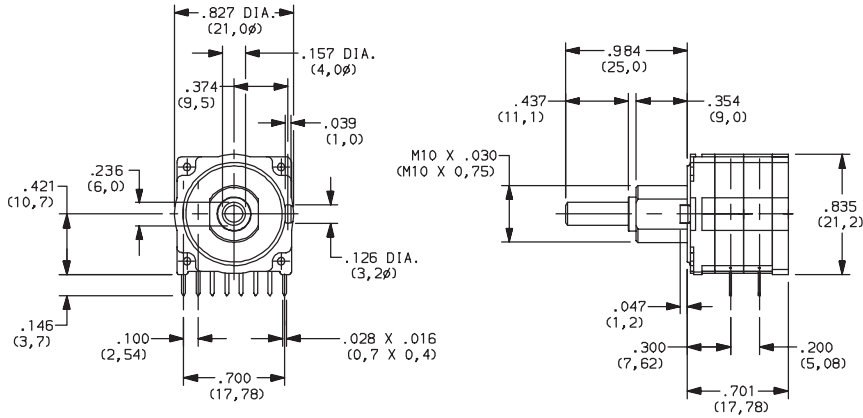

RTBH



INDEXING

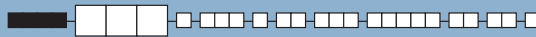

- 15** 15° index
- 22.5** 22.5° index
- 30** 30° index
- 36** 36° index

NUMBER OF SWITCH FUNCTIONS



- 1** 1 FUNCTION
- 2** 2 FUNCTIONS

NOTE: Several functions can be combined. For more information consult us.



Dimensions are shown: Inch (mm)
Specifications and dimensions subject to change

C&K RTBH Series 1-2 Pole Coded Rotary Switches

NUMBER OF POLES / POSITIONS



- 116** 22.5 INDEX, SP, 16 POSITIONS
- 112** 30 INDEX, SP, 12 POSITIONS
- 206** 30 INDEX, DP, 6 POSITIONS
- B** BINARY CODE, 15 /22.5 /30 /36
- C** COMPLEMENT, 15 /22.5 /30 /36
- BC** DIRECT + COMPLEMENT, 15 /22.5 /30 /36

SINGLE POLE FUNCTION

	C	1	2	3	4	5	6	7	8	9	10	11	12	13	14	15	16	17	18	19	20	21	22	23	24
1	●																								
2	●	●																							
3	●		●																						
4	●			●																					
5	●				●																				
6	●					●																			
7	●						●																		
8	●							●																	
9	●								●																
10	●									●															
11	●										●														
12	●											●													
13	●												●												
14	●													●											
15	●														●										
16	●															●									
17	●																●								
18	●																	●							
19	●																		●						
20	●																			●					
21	●																				●				
22	●																					●			
23	●																						●		
24	●																							●	

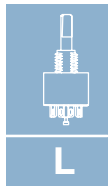

Rotary

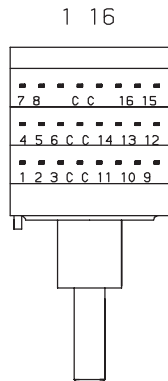
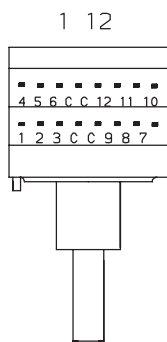

Dimensions are shown: Inch (mm)
Specifications and dimensions subject to change

C&K RTBH Series 1-2 Pole Coded Rotary Switches

NUMBER OF POLES / POSITIONS



DOUBLE POLE FUNCTION

	C ₁	1 ₁	2 ₁	3 ₁	4 ₁	5 ₁	6 ₁	C ₂	1 ₂	2 ₂	3 ₂	4 ₂	5 ₂	6 ₂
1	●	●						●	●					
2	●		●					●		●				
3	●			●				●			●			
4	●				●			●				●		
5	●					●		●					●	
6	●						●	●						●

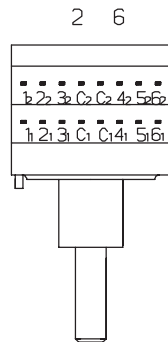

BINARY DIRECT CODE

	C	1	2	4	8	16
0	●					
1	●	●				
2	●		●			
3	●	●	●			
4	●			●		
5	●	●			●	
6	●	●	●			
7	●	●	●	●		
8	●				●	
9	●	●				●
10	●		●			
11	●	●	●			
12	●			●		
13	●	●	●	●		
14	●	●			●	
15	●	●	●			●
16	●					●
17	●	●				●
18	●		●			
19	●	●	●			●
20	●			●		
21	●	●			●	
22	●	●	●			●
23	●	●	●	●		●

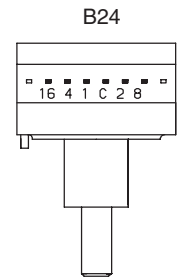
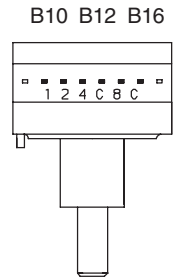

COMPLEMENT BINARY CODE

	C	1	2	4	8	16
0	●	●	●	●	●	●
1	●	●	●	●	●	●
2	●	●	●	●	●	●
3	●	●	●	●	●	●
4	●	●	●	●	●	●
5	●	●	●	●	●	●
6	●	●	●	●	●	●
7	●	●	●	●	●	●
8	●	●	●	●	●	●
9	●	●	●	●	●	●
10	●	●	●	●	●	●
11	●	●	●	●	●	●
12	●	●	●	●	●	●
13	●	●	●	●	●	●
14	●	●	●	●	●	●
15	●	●	●	●	●	●
16	●	●	●	●	●	●
17	●	●	●	●	●	●
18	●	●	●	●	●	●
19	●	●	●	●	●	●
20	●	●	●	●	●	●
21	●	●	●	●	●	●
22	●	●	●	●	●	●
23	●	●	●	●	●	●

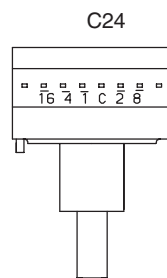
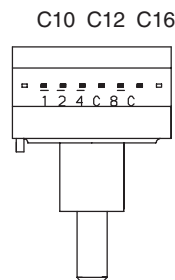

DIRECT AND COMPLEMENT BINARY CODE

	C	1	2	4	8	16	C	1	2	4	8	16
0	●						●	●	●	●	●	●
1	●	●					●	●	●	●	●	●
2	●		●				●	●	●	●	●	●
3	●	●	●				●	●	●	●	●	●
4	●			●			●	●	●	●	●	●
5	●	●			●		●	●	●	●	●	●
6	●	●	●				●	●	●	●	●	●
7	●	●	●	●			●	●	●	●	●	●
8	●				●		●	●	●	●	●	●
9	●	●				●	●	●	●	●	●	●
10	●		●				●	●	●	●	●	●
11	●	●	●				●	●	●	●	●	●
12	●			●			●	●	●	●	●	●
13	●	●	●	●			●	●	●	●	●	●
14	●	●			●		●	●	●	●	●	●
15	●	●	●			●	●	●	●	●	●	●
16	●					●	●	●	●	●	●	●
17	●	●					●	●	●	●	●	●
18	●		●				●	●	●	●	●	●
19	●	●	●				●	●	●	●	●	●
20	●			●			●	●	●	●	●	●
21	●	●			●		●	●	●	●	●	●
22	●	●	●				●	●	●	●	●	●
23	●	●	●	●			●	●	●	●	●	●

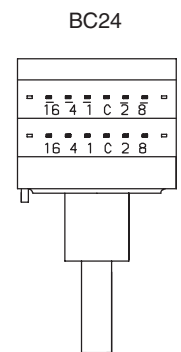
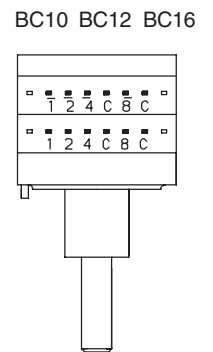

Dimensions are shown: Inch (mm)
Specifications and dimensions subject to change

C&K RTBH Series 1-2 Pole Coded Rotary Switches

STOPS

B STOP WITH NUMBER OF POSITIONS

S WITHOUT

MOUNTING STYLE

AD STANDARD BUSHING FOR PANEL MOUNT

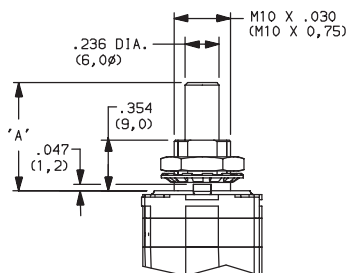

DE SEALED BUSHING FOR PANEL MOUNT

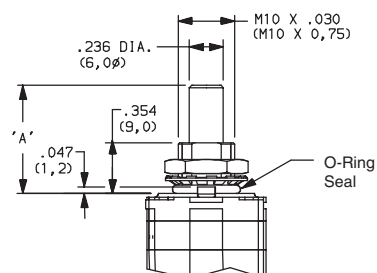

SHAFT DIAMETER

D6 6 mm (.236)

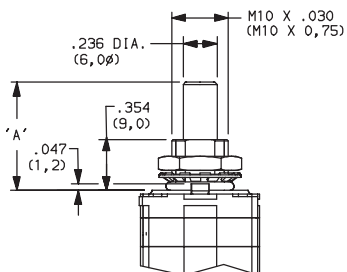

D63 6.35 mm (.250)

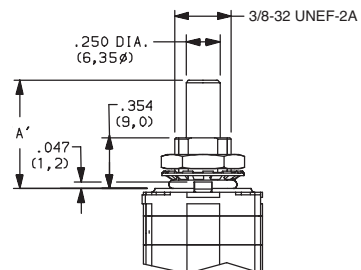

OPTION OF SHAFT

(NONE)

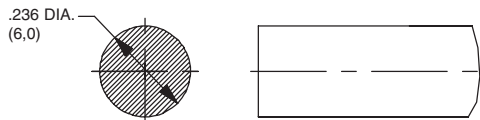

M10X5 FLAT

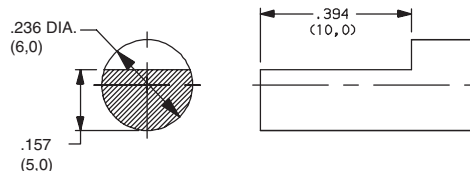

Third Angle
Projection

Dimensions are shown: Inch (mm)
Specifications and dimensions subject to change



Rotary

C&K RTBH Series 1-2 Pole Coded Rotary Switches

ACTUATOR OPTION ANGLE



(NONE)

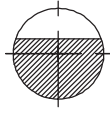

K0 0 ANGLE

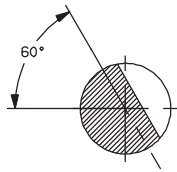

K60 60°

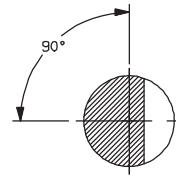

K90 90°

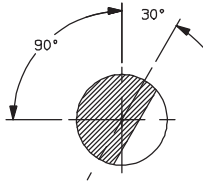

K120 120°

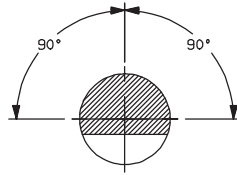

K180 210°

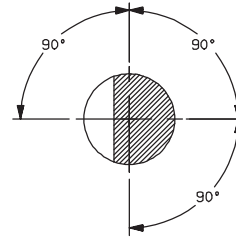

K270 300°

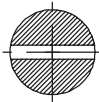

K0 (STD.) 0 ANGLE

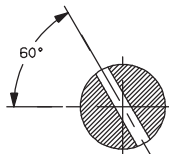

K60 60°

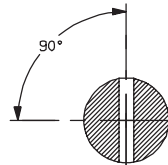

K90 90°

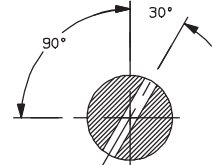

K120 120°

ACTUATOR LENGTH



25 0,25 mm (.984) STANDARD SHAFT

Other lengths available by request.

CONTACT MATERIAL



OPTION CODE	RoHS COMPLIANT*	RoHS COMPATIBLE*	CONTACT AND TERMINAL MATERIAL	RATING	
				LOW LEVEL/DRY CIRCUIT	SWITCH: 250 mA, POWER: 5 VA; CARRY: 5 AMPS
S	YES	YES	SILVER	LOW LEVEL/DRY CIRCUIT	SWITCH: 250 mA, POWER: 5 VA; CARRY: 5 AMPS
G	YES	YES	GOLD	LOW LEVEL/DRY CIRCUIT OR POWER	SWITCH: 20 mA, POWER: 0.2 VA; CARRY: 1 AMP

* Note: See Technical Data section of this catalog for RoHS compliant and compatible definition and specifications.



Dimensions are shown: Inch (mm)
Specifications and dimensions subject to change