

### General Description

The LDS506P/504 is a 2-terminal current regulator capable of delivering a constant current over a wide voltage range, and requires no separate voltage source or supporting components.

The LDS506P/504 is a bipolar integrated circuit that replaces legacy JFET devices.

Its low cost, small size and simplicity makes the current regulator diode ideal for applications requiring an isolated constant current source.

### Applications

- Audio circuits
- Timing circuits
- Current source or sink
- Current limiting circuits

### Features

- No separate voltage source required
- Excellent temperature performance
- High Dynamic Impedance
- **RoHS compliant** available

### Block Diagram

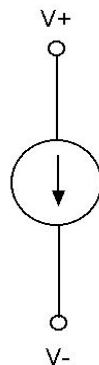

### Pin Configuration (Top View)

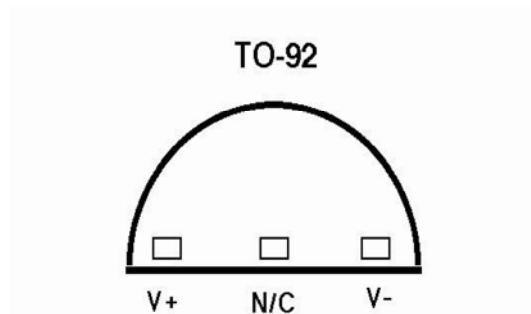

## Electrical Characteristic

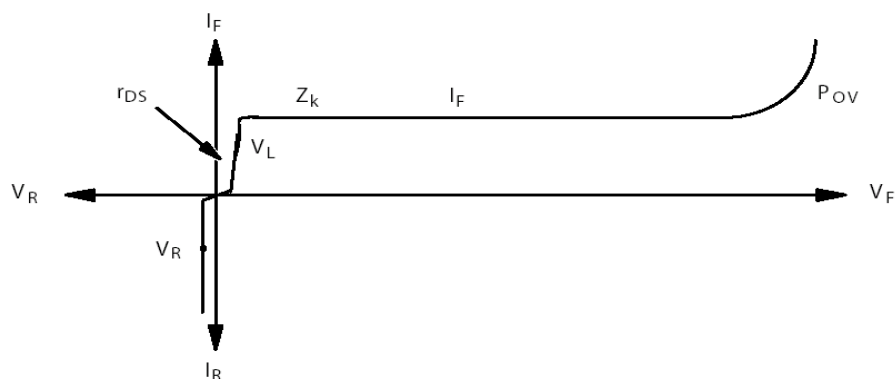

## Absolute Maximum Ratings

Parameter	Value	Unit
Peak Forward Voltage	36	V
Reverse Current	50	mA
Operating Junction Temperature	150	°C
Lead Temperature (soldering 10 seconds)	300	°C
Storage Temperature Range	-80 to +150	°C

## Electrical Specifications

Electrical characteristics are guaranteed over the full temperature range  $0^{\circ}\text{C} \leq T_j \leq 100^{\circ}\text{C}$ . Ambient temperature must be de-rated based upon power dissipation and package thermal characteristics.

Symbol	Parameter	Conditions	Min	Typ	Max	Units
POV	Peak Operating Voltage	$I_F = 1.1 \cdot I_{F \text{ max}}$	36	45		Volts
VR	Reverse Voltage	$I_R = 1\text{mA}$		0.8		Volts
CF	Capacitance	$V_F = 25\text{V}$ , $f = 1\text{MHz}$		2.2		pF
IF	Regulator Current	LDS506P, $V_F = 25\text{V}$	1.12	1.40	1.68	mA
		LDS504, $V_F = 25\text{V}$	0.61	0.70	0.84	
Zd	Dynamic Impedance	$V_F = 25\text{V}$	.33	1.5		$\text{M}\Omega$
Zk	Knee Impedance	$V_F = 6\text{V}$		.25		$\text{M}\Omega$
VL	Limiting Voltage	$I_F = 0.8 \cdot I_{f \text{ min}}$		1.1	2.5	V
TC	Temperature Coefficient	$V_F = 25\text{V}$		.19		$\%/^{\circ}\text{C}$

Symbol	Parameter	Conditions	Min	Typ	Max	Units
		$0^{\circ}\text{C} \leq \text{TA} \leq 100^{\circ}\text{C}$				

### Typical Applications

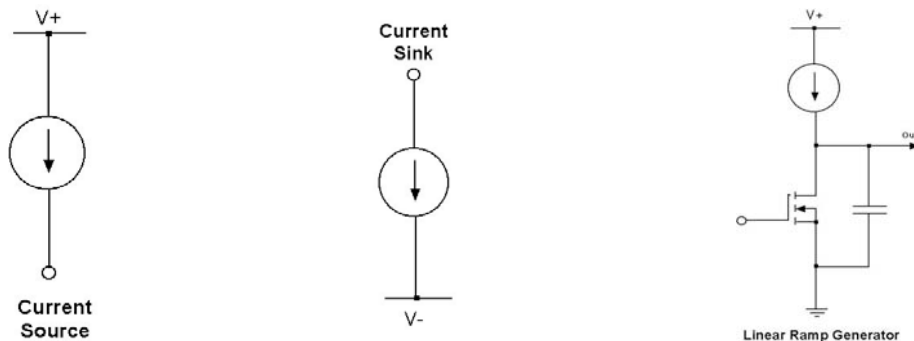

### PACKAGE DIMENSIONS TO92-2

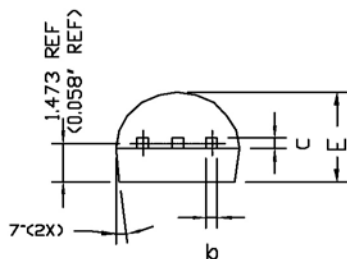
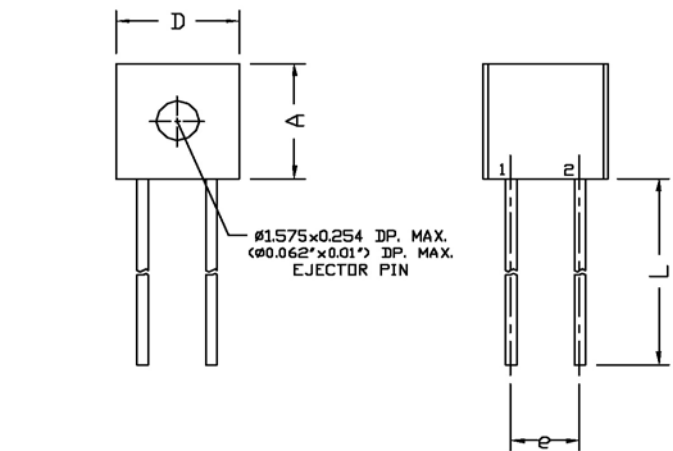

SYMBOL	COMMON					
	DIMENSIONS MILLIMETER			DIMENSIONS INCH		
	MIN.	NOM.	MAX.	MIN.	NOM.	MAX.
A	4.472	4.572	4.672	0.176	0.180	0.184
b	0.381	0.406	0.431	0.015	0.016	0.017
c	0.356	0.406	0.456	0.014	0.016	0.018
D	4.472	4.572	4.672	0.176	0.180	0.184
E	3.456	3.556	3.656	0.136	0.140	0.144
e	2.413	2.540	2.667	0.095	0.100	0.105
L	13.87	13.97	14.07	0.546	0.550	0.554

- NOTES :
1. CONTROLLING DIMENSION : MILLIMETER. CONVERTED INCH DIMENSION ARE NOT NECESSARILY EXACT.
  2. DIMENSIONING AND TOLERANCING PER ANSI Y14.5, 1973.
  3. FOR 2 LEAD PACKAGE CENTER LEAD IS CLIPPED

## Ordering Information

Device	Operating Tj	%Tol	Pkg Type	I FWD	Wrap	Order Number
LDS506P	0C° ≤100C°	20	TO-92-2	1.4mA	BULK	LDS506FV-N2-14-BL
LDS504P	0C° ≤100C°	20	TO-92-2	0.7mA	BULK	LDS504FV-N2-07-BL

**Note:** Lead Free and RoHS compliant.

---

**Warranty and Use**

LEADIS TECHNOLOGY MAKES NO WARRANTY, REPRESENTATION OR GUARANTEE, EXPRESS OR IMPLIED, REGARDING THE SUITABILITY OF ITS PRODUCTS FOR ANY PARTICULAR PURPOSE, NOR THAT THE USE OF ITS PRODUCTS WILL NOT INFRINGE ITS INTELLECTUAL PROPERTY RIGHTS OR THE RIGHTS OF THIRD PARTIES WITH RESPECT TO ANY PARTICULAR USE OR APPLICATION AND SPECIFICALLY DISCLAIMS ANY AND ALL LIABILITY ARISING OUT OF ANY SUCH USE OR APPLICATION, INCLUDING BUT NOT LIMITED TO, CONSEQUENTIAL OR INCIDENTAL DAMAGES.

Leadis Technology products are not designed, intended, or authorized for use as components in systems intended for surgical implant into the body, or other applications intended to support or sustain life, or for any other application in which the failure of the Leadis Technology product could create a situation where personal injury or death may occur.

Leadis Technology reserves the right to make changes to or discontinue any product or service described herein without notice. Products with data sheets labeled "Advance Information" or "Preliminary" and other products described herein may not be in production or offered for sale.

Leadis Technology advises customers to obtain the current version of the relevant product information before placing orders. Circuit diagrams illustrate typical semiconductor applications and may not be complete.

---



Leadis Technology  
 800 W. California Ave,  
 Suite 200  
 Sunnyvale, CA 94086  
 Phone: 408.331.8600  
 Fax: 408.331.8601  
<http://www.leadis.com>

Document No: 506LDS  
 Revision: 1.6  
 Issue date: 3/06/08