

# KDS Series Intrusion Switches

## Features/Benefits

- Slot mount into chassis to reduce installation cost
- Wire harness length & connector easily customized
- Available in N.O. or N.C. configuration
- RoHS compliant



## Typical Applications

- Intrusion/Alarm switch in network desktop PC
- Intrusion/Alarm switch in telecommunication equipment
- Intrusion/Alarm switch in cellular base station

## Specifications

CONTACT RATING: 0.4 VA max. @ 20 V AC or DC.

MECHANICAL & ELECTRICAL LIFE: 10,000 actuations min. at full load.

CONTACT RESISTANCE: 200 m Ω max. initial @ 2-4 V DC, 100mA.

INSULATION RESISTANCE: 10<sup>9</sup> Ω min.

OPERATING TEMPERATURE: -40°C to +85°C

TRAVEL: Pretravel: 0.050 max. Overtravel: 0.375 ±.025"

DIELECTRIC STRENGTH: 500 Vrms min. @ sea level.

PACKAGING: Bulk packaging.

## Materials

HOUSING: Nylon 6/6 (UL 94V-0)

ACTUATOR: Nylon 6/6 (UL 94V-0)

MOVABLE CONTACT: Copper alloy, gold plate over nickel plate.

FIXED CONTACT: Brass, gold plate over nickel plate.

WIRE: UL 1061-24 AWG.

**NOTE:** Specifications and materials listed above are for switches with standard options. For information on specific and custom switches, consult Customer Service Center.

## How To Order

Complete part numbers for KDS Series Switches are shown below.

| PART NUMBER  | SWITCH FUNCTION |        | SCHEMATIC |
|--------------|-----------------|--------|-----------|
|              | POS. 1          | POS. 2 |           |
| <b>KDS11</b> | OFF             | MOM.   | SPST N.O. |
| <b>KDS33</b> | ON              | OFF    | SPST N.C. |

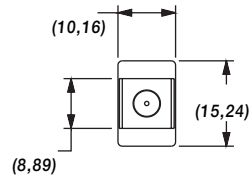

**KDS33**

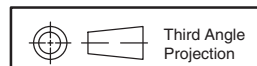
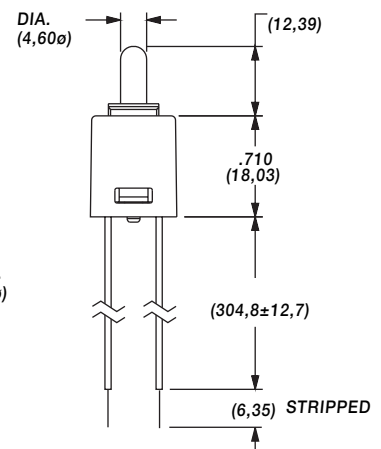
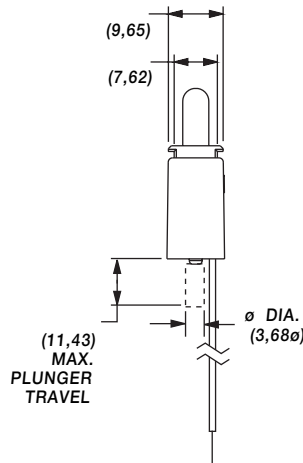
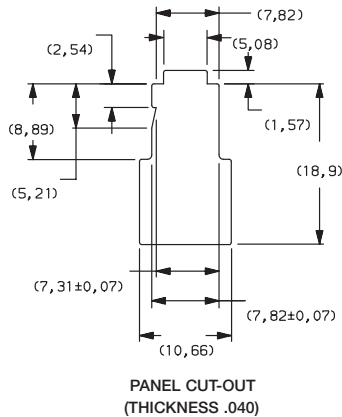

Dimensions are shown in mm  
Specifications and dimensions subject to change



Detect