

SEC A-A

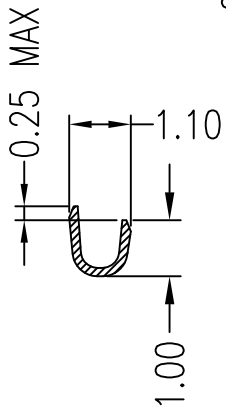

SEC B-B

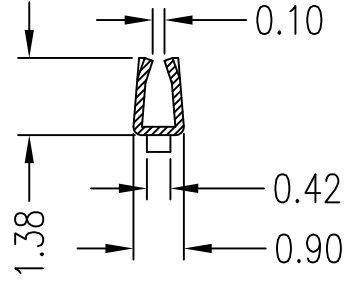

SEC C-C

Notes:

1. Stamping before plating.
2. Mated with 10114826 housing.
3. Product numbering:

Part No	Wire Range	Insulation O.D.	Material	Finish	Qty/reel
10114827-001LF	AWG#28-#32	1.00mm(max)	Phosphor Bronze	Tin-plated	20,000pcs
10114827-002LF	AWG#28-#32	1.00mm(max)	Phosphor Bronze	Gold-flash	20,000pcs

mat'l. code				tolerances unless otherwise specified			CUSTOMER COPY		FCI		www.fciconnect.com	
ltr	ecn no	dr	date	linear	.X ± 0.25		projection	title				
A	T10-0145	J H	12/1/10		.XX ± 0.15							
					.XXX ±							
				angles	0° ±2'		MM	WTB 1.25MM TERMINAL				
				dr	JASON HSU	12/1/10						
				enr	JASON HSU	12/1/10						
				chr	GARY HSIEH	12/1/10	scale	product family		WTB	code	
				appd	JOSEPH HSIA	12/1/10		size		dwg no	10114827	TWN
sheet index	revision sheet	A	1				1:1	A4			sheet 1 of 1	