

# SD188SBWS

## SILICON SCHOTTKY BARRIER DIODE

### Features

- Small surface mounting type
- Ultra low  $V_F$
- High reliability

### PINNING

PIN	DESCRIPTION
1	Cathode
2	Anode

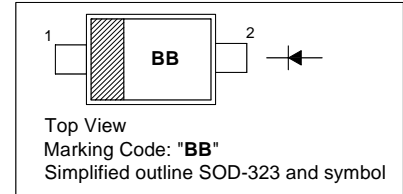

### Absolute Maximum Ratings ( $T_a = 25\text{ }^\circ\text{C}$ )

Parameter	Symbol	Value	Unit
Peak Reverse Voltage	$V_{RM}$	20	V
Reverse Voltage	$V_R$	10	V
Mean Rectifying Current	$I_O$	200	mA
Peak Forward Surge Current	$I_{FSM}$	0.5	A
Junction Temperature	$T_j$	125	$^\circ\text{C}$
Storage Temperature Range	$T_s$	- 40 to + 125	$^\circ\text{C}$

### Characteristics at $T_a = 25\text{ }^\circ\text{C}$

Parameter	Symbol	Max.	Unit
Forward Voltage at $I_F = 50\text{ mA}$ at $I_F = 200\text{ mA}$	$V_F$	0.3 0.41	V
Reverse Current at $V_R = 10\text{ V}$	$I_R$	20	$\mu\text{A}$

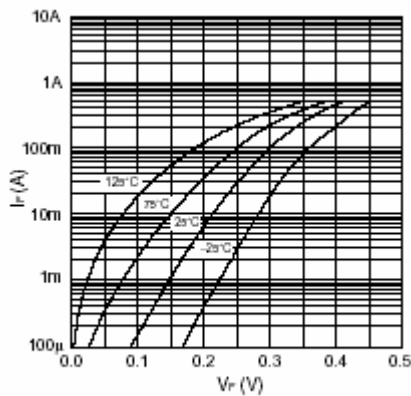

Fig.1 Forward characteristics

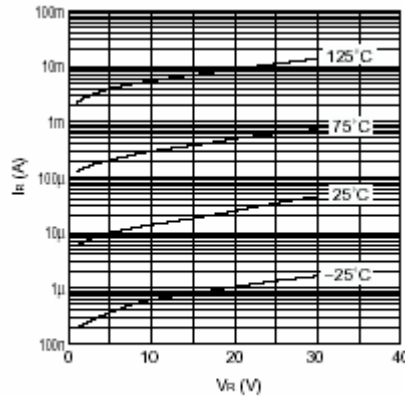

Fig.2 Reverse characteristics

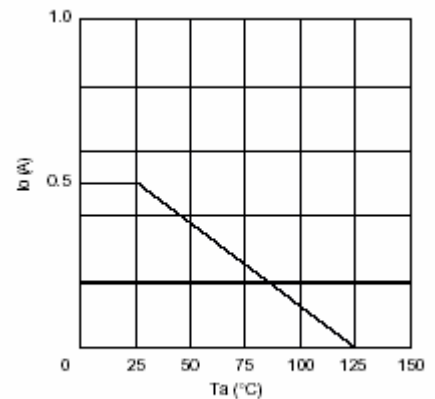
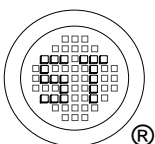

Fig.3 Derating curve



**SEMTECH ELECTRONICS LTD.**

(Subsidiary of Sino-Tech International Holdings Limited, a company listed on the Hong Kong Stock Exchange, Stock Code: 724)



ISO/TS 16949 : 2002 Certificate No. 05103  
ISO 14001:2004 Certificate No. 7116  
ISO 9001:2000 Certificate No. 0506098

Dated : 01/09/2006

# SD188SBWS

## PACKAGE OUTLINE

Plastic surface mounted package; 2 leads

SOD-323

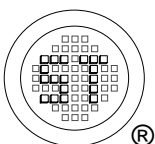
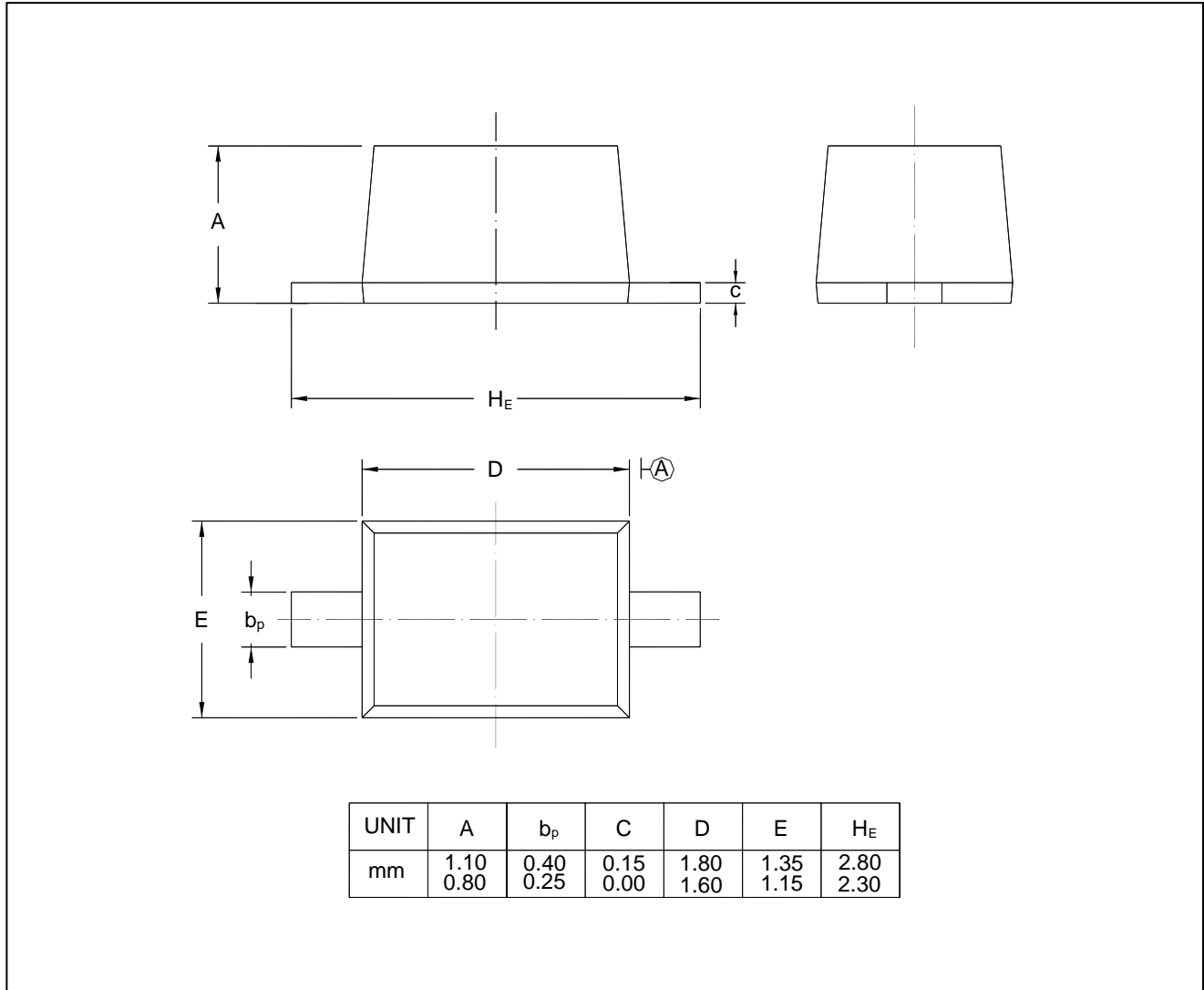

**SEMTECH ELECTRONICS LTD.**  
 (Subsidiary of Sino-Tech International Holdings Limited, a company  
 listed on the Hong Kong Stock Exchange, Stock Code: 724)



Dated : 01/09/2006