

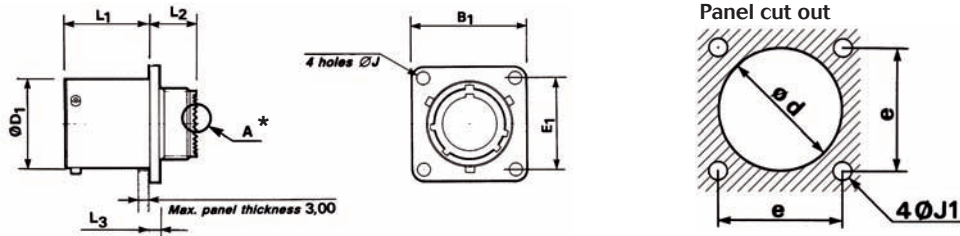

Receptacle type 3



Shell size		09	11	13	15	17	19	21	23	25	
B1	Min	23.70	26.05	28.50	30.85	33.20	36.40	39.55	42.75	46.00	
	Max	24.30	26.70	29.05	31.45	33.80	37.00	40.15	43.35	46.50	
E1		18.26	20.62	23.01	24.61	26.97	29.36	31.75	34.93	38.10	
D1	Min	14.40	17.65	21.40	24.65	27.82	29.24	33.70	36.92	40.06	
	Max	14.53	17.78	21.59	24.77	27.94	30.66	33.83	37.00	40.18	
J	Min	3.25	3.25	3.25	3.25	3.25	3.25	3.25	3.73	3.73	
	Max	3.35	3.35	3.35	3.35	3.35	3.35	3.35	3.83	3.83	
L1	Min	20.71	20.71	20.71	20.71	20.71	20.71	19.96	19.96	19.96	
	Max	20.83	20.83	20.83	20.83	20.83	20.83	20.08	20.08	20.08	
L2	Min	10.40	10.40	10.40	10.40	10.40	10.40	11.15	11.15	11.15	
	Max	11.90	11.90	11.90	11.90	11.90	11.90	12.70	12.70	12.70	
L3	Min	2.14	2.14	2.14	2.14	2.14	2.14	2.90	2.90	2.90	
	Max	2.54	2.54	2.54	2.54	2.54	2.54	3.30	3.30	3.30	
d		Min	16.66	20.22	23.42	26.59	30.96	32.94	36.12	39.29	42.47
J1		± 0.15	3.25	3.25	3.25	3.25	3.25	3.25	3.25	3.91	3.91
e			18.26	20.62	23.01	24.61	26.97	29.36	31.75	34.92	38.10

Receptacle type 7 & HE 308 type 11

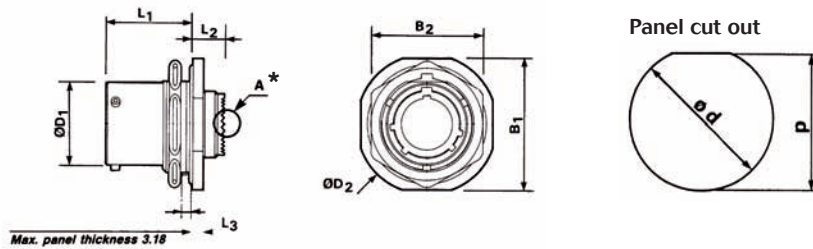

Shell size		09	11	13	15	17	19	21	23	25	
B1	Min	26.60	31.40	34.60	37.80	40.90	45.63	48.84	52.02	55.19	
	Max	27.35	32.10	35.31	38.49	41.63	46.37	49.58	52.76	55.93	
B2	Min	21.95	25.15	29.80	33.05	36.25	39.40	42.60	45.75	50.65	
	Max	22.35	25.55	30.30	33.45	36.65	39.80	43.00	46.15	50.95	
D1	Min	14.40	17.65	21.40	24.65	27.82	29.24	33.70	36.92	40.06	
	Max	14.53	17.78	21.59	24.77	27.94	30.66	33.83	37.00	40.18	
D2	Min	29.90	34.60	37.75	41.00	44.11	48.90	52.00	55.30	58.40	
	Max	30.58	35.30	38.50	41.65	44.85	49.60	52.75	55.94	59.10	
L1	Min	23.12	23.12	23.12	23.12	23.12	23.12	23.12	23.12	23.12	
	Max	23.36	23.36	23.36	23.36	23.36	23.36	23.36	23.36	23.36	
L2	Min	8.18	8.18	8.18	8.18	8.18	8.18	8.18	8.18	8.18	
	Max	8.32	8.32	8.32	8.32	8.32	8.32	8.32	8.32	8.32	
L3	Min	2.60	2.60	2.60	2.60	2.60	3.35	3.35	3.35	3.35	
	Max	3.00	3.00	3.00	3.00	3.00	3.79	3.79	3.79	3.79	
d		0/-0.25	17.78	20.96	25.65	28.83	32.00	35.18	38.35	41.53	44.70
p		0/-0.25	17.02	18.58	24.26	27.56	30.73	33.91	37.08	40.26	43.45