

RECOMENDED HOLE PATTERN.

- NOTES:
- MATERIAL PIN:
PHOSPHOR BRONZE A.S.T.M.
B 159 ALLOY C 51000 HO 3.
 - MATERIAL BODY:
POLYAMID,30% GLASS FILLED
FLAME RETARDANT PER U.L
94 V-0,COLOUR BLACK.
 - DIM 1.50 ^{+0.05} _{-0.05} FOR MOULDED
SIDE(S) ONLY,IF SIDE(S) ARE
BROKEN DIM 2.29 MIN TO
2.79 MAX APPLIES.
 - PIN PUSH-OUT FORCE 12N
MINIMUM.

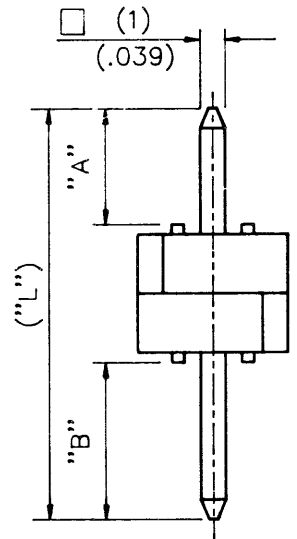
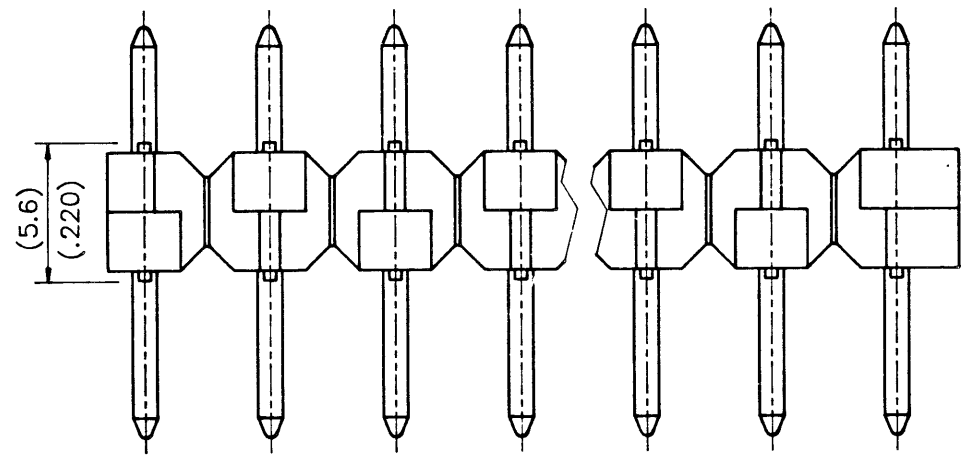

75875-XXX-XX

- No. OF POSN.
- VERSION
- PLATING
- BASIC PART NUMBER

CUSTOMER COPY FOR REFERENCE ONLY

					MM INCH	MAT'L CODE	SEE PART No.
				SCALE	5:1	FINISH	SEE SHEET 2
		DO NOT SCALE DRAWING				PRODUCT No.	75875-XXX-XX
		DATE	NAME			TITLE	JUMBO HEADER,STRAIGHT SINGLE ROW.
		DR 900125	K.N.CURTIS.			5.08mm.	
		CHK 900125	D.GREEN				
		APPD 900125	D.GREEN				
		RELEASE No.					
						DRG No.	75875
						REV	F
						SHEET	213
						1 OF 2	
F	11312	900125	KNC				
REV	ECR No.	DATE	DR				

PRODUCT No	PRODUCT DIMENSIONS		
	"A" ±0.25 .010	"B" ±0.4 .016	("L") REF
	75875-X01	6.76 .266	3.05 .120
75875-X02	6.76 .266	4.5 .177	16.86 .664
75875-X03	5.96 .235	11.00 .433	22.56 .888
75875-X04	5.96 .235	18.10 .712	29.66 1.678
75875-X05	5.96 .235	25.20 .992	36.76 1.447
75875-X06	13.71 .540	3.25 0.128	22.56 .888

212
100 r3

75875-4XX	
75875-3XX	$\frac{3.81\mu\text{m}}{150\mu}$ SnPb(93/7)
75875-2XX	
75875-1XX	$\frac{0.76\mu\text{m}}{30\mu}$ Au
75875-0XX	
PLATING CODE	MINIMUM PLATING THICKNESS OVER $\frac{1.27\mu\text{m Ni}}{50\mu}$

CUSTOMER COPY FOR REFERENCE ONLY

			MM INCH	MAT'L CODE	SEE SHEET 1
			SCALE	5:1	FINISH
DO NOT SCALE DRAWING				PRODUCT No.	75875-XXX-XX
	DATE	NAME	TITLE		
DR	900125	K.N.CURTIS.	JUMBO HEADER, STRAIGHT		
CHK	900125	D.GREEN	SINGLE ROW.		
APPD	900125	D.GREEN	5.08mm.		
RELEASE No.			DRG No.	REV	SHEET
			75875	F	213
F	11312	900125	KNC		2 OF 2
REV	ECR No.	DATE	DR		

CAD PRODUCED