

**Type: MC-100C**

◆ **Product Description**

- $\phi$  11.0mm Max.(L×W), 7.3 mm Max. (Height)
- In addition to the typical versions of parameters shown here, custom designs are available to meet your exact requirements.



◆ **Feature**

- Magnetically shielded construction.
- Max. Operating frequency 500kHz, Max. Operating power 3.1W(500kHz).
- Ideally used in LCD TV, Note PC, Portable equipment.
- RoHS Compliance

◆ **Dimensions (mm)**

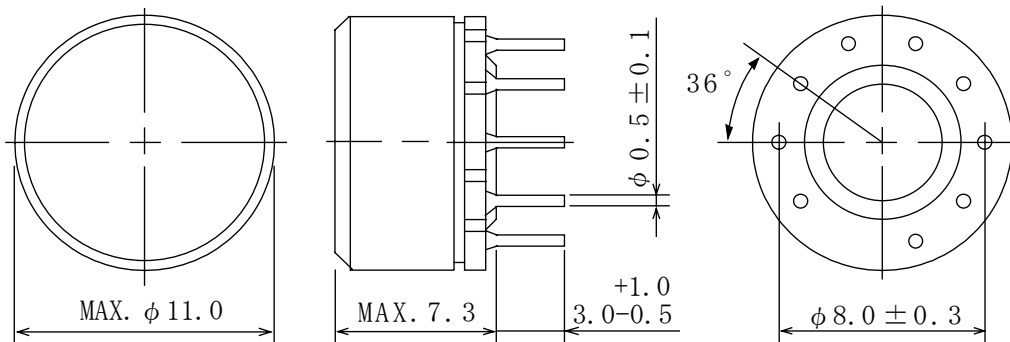

◆ **Schematics (Bottom)**

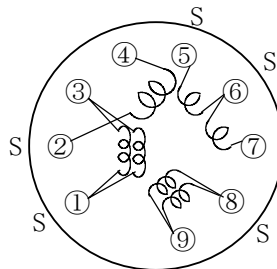

“S” indicates winding start.

◆ **Specification**

Sample No.	Inductance (1-3) 1kHz/1V	D.C.R. (1-3)	D.C.R. (8-9)
0313-T109	105 $\mu$ H $\pm$ 25%	1.43 $\Omega$ Max.	305m $\Omega$ Max.