



AVALANCHE AUTOMOTIVE DIODE

AAR50L/AARS50L

AVALANCHE VOLTAGE 20 to 24 Volts

CURRENT 50 Amperes

Technical Specifecation:

Features:

- High power capability
- Economical
- Avalanche Voltage: 20V to 24V

MECHANICAL DATA

- Case: transfer molded plastic
- Epoxy: UL94-0 rate flame ratardant
- Polarity: Indicated by Cathode Band
- Technology vacuum soldered
- Lead: Plated slug, solderable per MIL-STD-202E Method 208C
- Weight: 0.0635ounce, 1.8Grams (Approximately)

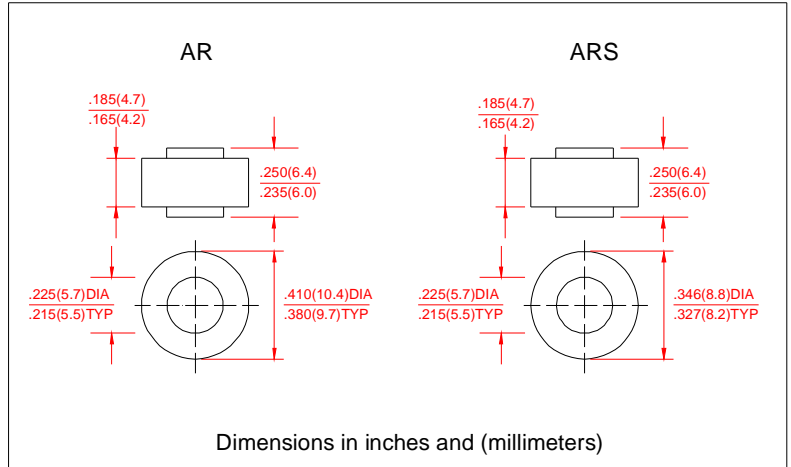

MAXIMUM RATINGS AND ELECTRICAL CHARACTERISTICS

- Ratings at 25°C ambient temperature unless otherwise specified
- Single Phase, half wave, 60Hz, resistive or inductive load
- For capacitive load derate current by 20%

Electrical Characteristics @ 25°C	SYMBOLS	MIN	NOMINAL	MAX	UNITS
Peak Repetitive Reverse Voltage	V _{RRM}		17		Volts
Working Peak Reverse Voltage	V _{RRM}		17		
DC Blocking Voltage	V _{DC}		17		
Average Rectified Forward Current (Tc=125°C)	I _o		50		Amps
Repetitive Peak Reverse Surge Current Tc=10msec Dury Cycle<1%	I _{RSM}		50		Amps
Breakdown Voltage (Vbr@ir=100mA, Tc=25°C)	Vbr1	20	22	24	Volts
Ir=90Amps, Tc=150°C, PW=80usec	Vbr2			32	Volts
Forward Voltage Drop @If=100Amps<300usec	V _F		1.0	1.05	Volts
Peak Forward Surge Current	I _{FSM}		600		Amps
Reverse Leakage (V _R =17Vdc) T _A =25°C	I _R		1.0	2.0	uAmps
Operating and Storage Junction Temperature Range	T _J , T _{STG}		-65 to +175		°C

Notes: 1. Enough heatsink must be considered in application.

