

This document is the property of Amphenol Corporation and is delivered on the express condition that it is not to be disseminated, reproduced or used, in whole or in part, for the manufacture or sale by anyone other than Amphenol Corporation without its prior consent, and that no right is granted to disclose or to use any information in this document.

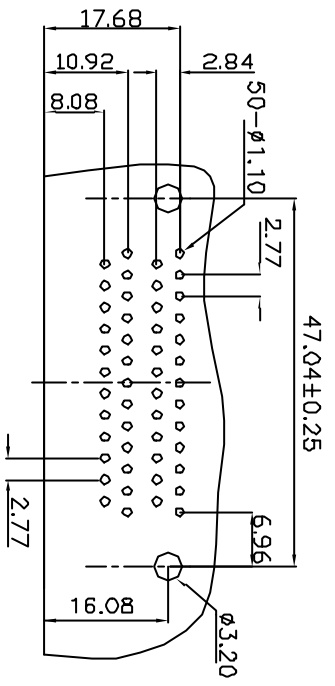
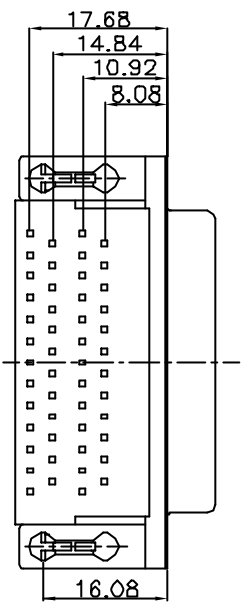
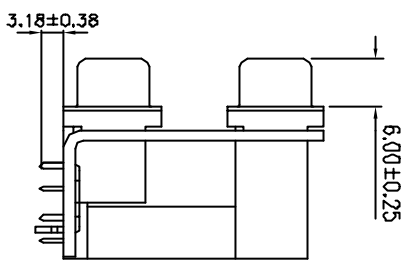
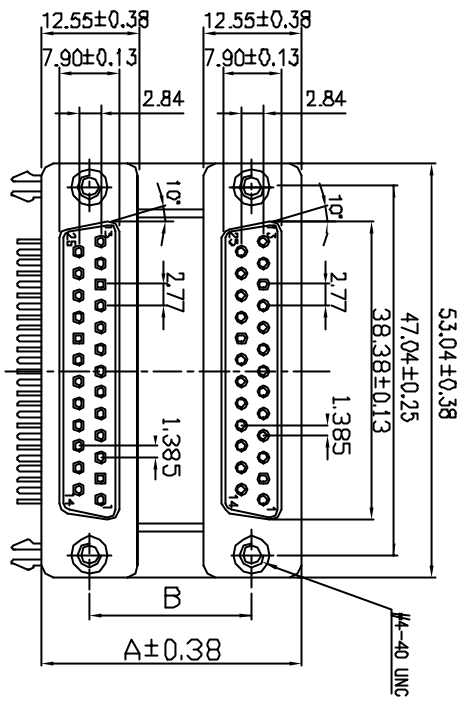

**RECOMMENDED P.C.B. LAYOUT**

**SPECIFICATIONS**

- Shells : Steel, tin plated
- Insulator : Glass-filled thermoplastic, UL 94V-0
- Contacts :
  - Pin : brass, selective gold
  - Socket : phosphor bronze, selective gold
- Boardlock : Phosphor bronze, 2.54m (100") min.
- Tin lead plated
- Flange accessories : Brass, 2.54m (100") min.
- Tin plated
- Current rating : 3A
- Voltage rating : 250V AC/rms 60Hz
- Withstanding voltage : 1000V AC/rms 60 Hz for 1 minute
- Insulation resistance : 1000M ohms
- Contact resistance : 20m ohms max
- Operating temperature : -55°C to +125°C
- Salt spray : 24 hours
- Single contact insertion force : 0.54kg (1.19lb) max
- Single contact withdrawal force : 0.06kg (0.13lb) min

A	15.88mm (0.625")	19.05mm (0.750")	22.86mm (0.90")
B	28.50mm	31.50mm	31.40mm

Drawing number	PROFILE TYPE (mm)	Contact plating
17H1660120	15.88	Gold flash
17H2660120	19.05	
17H3660120	22.95	.15u inches
17H1661120	15.88	
17H2661120	19.05	.30u inches
17H3661120	22.95	
17H1662120	15.88	
17H2662120	19.05	
17H3662120	22.95	

<b>TOLERANCE (mm)</b>		<b>APPROVALS</b>		<b>DATE</b>		<b>TITLE</b>	
XXX	±0.25	CR		14/1/01		17 H SERIES DUAL PORT D-SUB CONNECTORS	
XXXX	±0.130	JFL		14/1/01		TOP : SOCKET BOTTOM : SOCKET	
		JFL		14/1/01		AMPHENOL SOCAPEX Dole Plant	
				MM	A4	17H-66-120	
						Scale N.A. Sheet 1 of 1	
						REV: A	