

Tous droits strictement reserves. Reproduction ou communication a des tiers interdite sous quelque forme que ce soit sans autorisation ecrite du proprietaire. Propriete de c FCI. Droits de reproduction FCI.

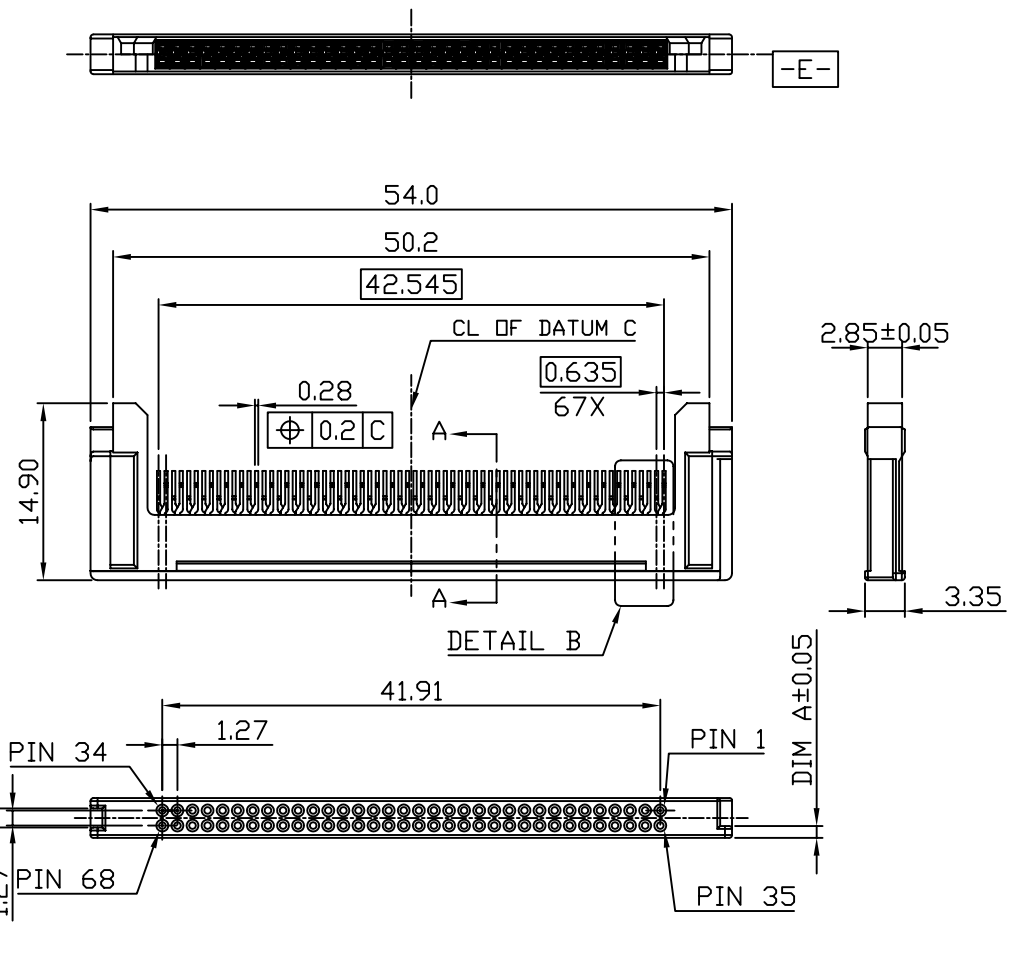

All rights strictly reserved. Reproduction or issue to third parties in any form whatever is not permitted without written authority from the proprietor. Property of FCI. Copyright FCI.

PRODUCT NO.	DIM A	VOLTAGE KEY	BOARD OFFSET DIM C	PACKING	
10014744					
-002 (-N02)	1.0	5.0V	0.3	SEE NOTE 5 FOR DETAIL DESCRIPTION	
-003 (-N03)	1.0	5.0V	0		
-004 (-N04)	1.0	5.0V	-0.3		
-006 (-N06)	2.1	3.3V	0.3		
-007 (-N07)	2.1	3.3V	0		
-008 (-N08)	2.1	3.3V	-0.3		
-011 (-N11)	1.0	5.0V	0.6		
-012 (-N12)	2.1	3.3V	0.6		
-013 (-N13)	1.0	5.0V	-0.6		
-014 (-N14)	2.1	3.3V	-0.6		
-015 (-N15)	1.0	5.0V	-0.8		
-021 (-N21)	1.0	5.0V	0		
SEE NOTE 6 FOR -NXX DETAIL					
SEE NOTE 7 FOR LEAD FREE DETAIL					
(NOTE: -021 & -N21 IS REVERSED TYPE)					



mat'l. code				tolerances unless otherwise specified				CUSTOMER COPY		FCI	
ltr	ecn no	dr	date	linear	.X ±.3	projection	title		www.fciconnect.com		
A	T20365	TAI	12/17/02		.XX ±.13		68PIN PCMCIA RECEPTACLE ASS'Y		product family PCMCIA code -		
B	T03-0042	TAI	01/30/03		.XXX ±.050						
C	T03-0099	TAI	03/21/03	angles	0° ±2°						
D	T03-0186	TAI	05/21/03	dr	KENNY TAI	12/17/02	MM	size	dwg no	sheet	
E	T03-0332	TAI	07/22/04	engr	KENNY TAI	12/17/02	scale	A3	10014744	1 of 4	
F	T03-0358	TAI	08/23/04	chr	KENNY TAI	12/17/02	1:1				
G	DG06-0154	CS	04/06/06	appd	PAUL WANG	12/17/02					
sheet index	revision sheet	G	F	F	F						
		1	2	3	4						

cage code 22526
 STATUS Released
 Printed Apr 08, 2006

ACAD

PDM: Rev:G

Tous droits strictement reserves. Reproduction ou communication a des tiers interdite sous quelque forme que ce soit sans autorisation ecrite du proprietaire. Propriete de c FCI. Droits de reproduction FCI.



All rights strictly reserved. Reproduction or issue to third parties in any form whatever is not permitted without written authority from the proprietor. Property of FCI. Copyright FCI.

1 | 2

3 |

4

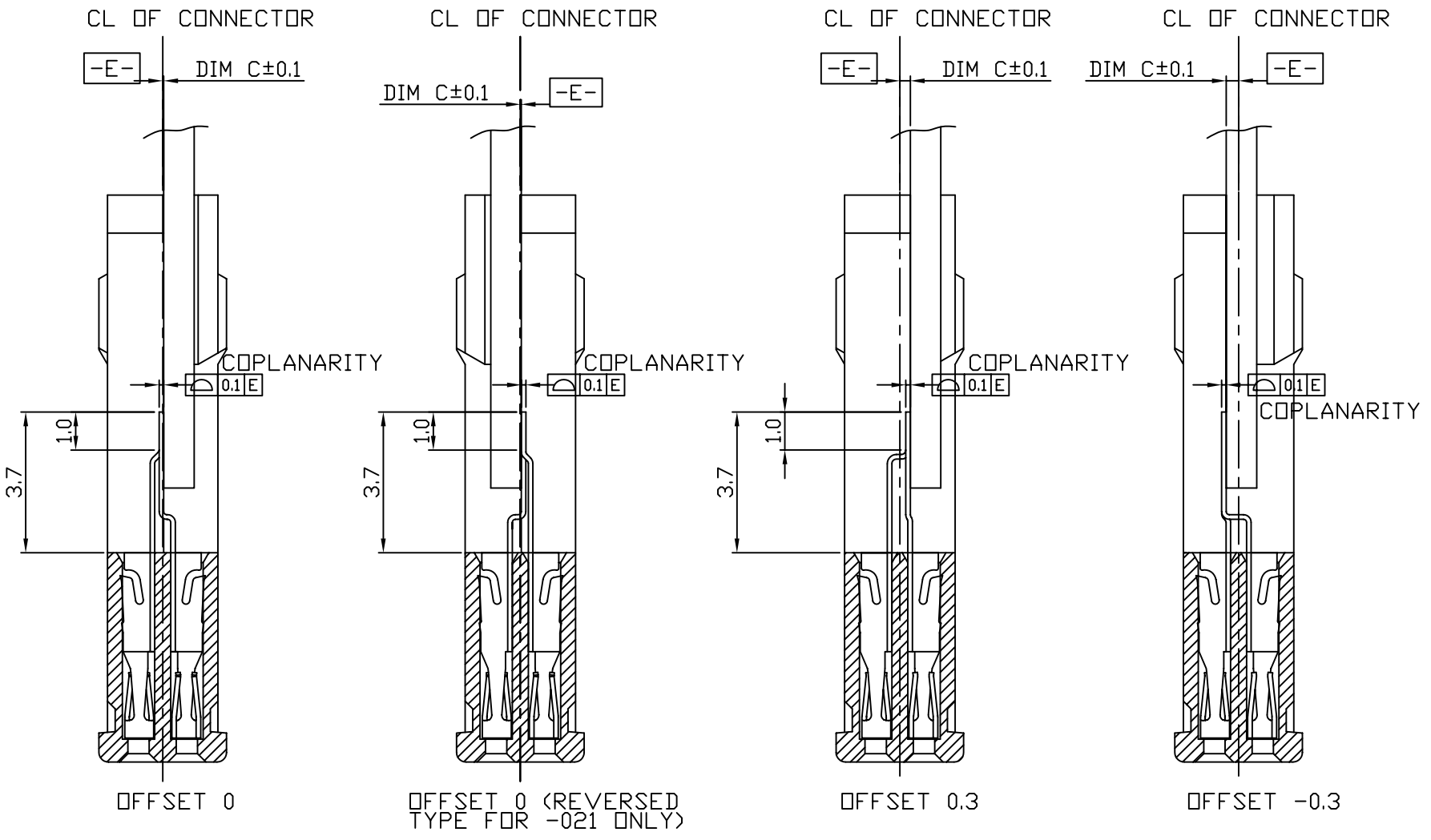

mat'l. code				tolerances unless otherwise specified			CUSTOMER COPY		FCI			
ltr	ecn no	dr	date	linear	.X ±.3		projection	www.fciconnect.com				
F					.XX ±.13			title	68PIN PCMCIA RECEPTACLE ASS'Y			
					.XXX ±.050				product family	PCMCIA		code
				angles	0° ±2°		MM	size		dwg no		
				dr	KENNY TAI	12/17/02		scale	A3		10014744	sheet
				engr	KENNY TAI	12/17/02	1:1				2 of	
				chr	KENNY TAI	12/17/02						
				appd	PAUL WANG	12/17/02						
sheet index	revision sheet											

1 | 2

3 |

4

ACAD

PDM: Rev:G

cage code 22526

STATUS Released

Printed Apr 08, 2006

Tous droits strictement reserves. Reproduction ou communication a des tiers interdite sous quelque forme que ce soit sans autorisation ecrite du proprietaire. Propriete de c FCI. Droits de reproduction FCI.

All rights strictly reserved. Reproduction or issue to third parties in any form whatever is not permitted without written authority from the proprietor. Property of FCI. Copyright FCI.



CL OF CONNECTOR

DIM C±0.1 [-E-]

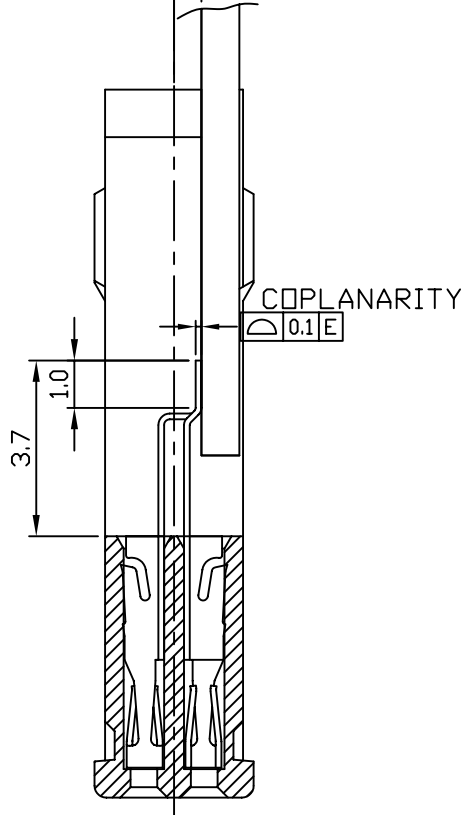

OFFSET 0.6

CL OF CONNECTOR

DIM C±0.1 [-E-]

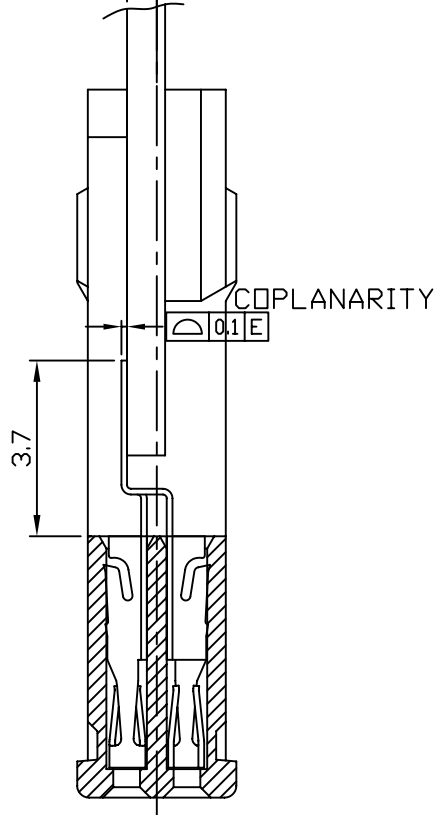

OFFSET -0.6

CL OF CONNECTOR

DIM C±0.1 [-E-]

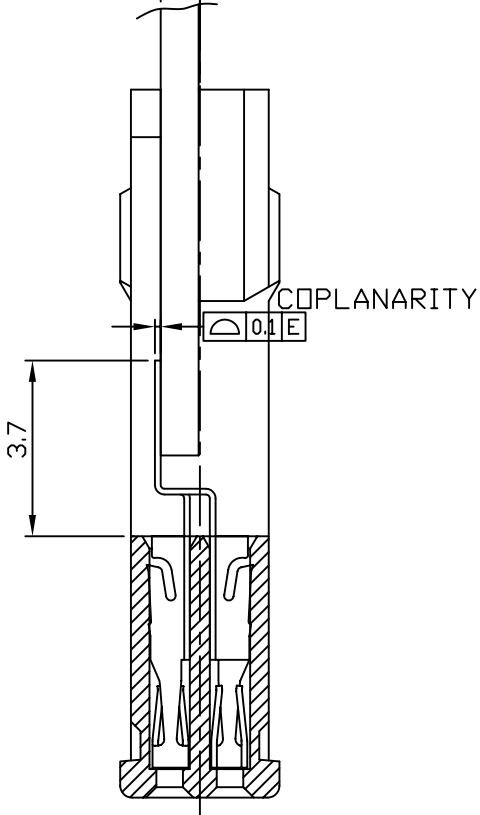

OFFSET -0.8

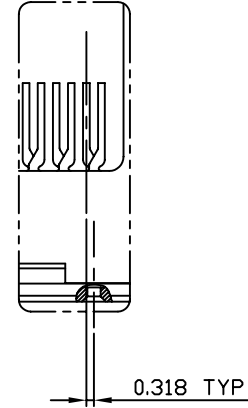

DETAIL B

mat'l. code				tolerances unless otherwise specified			CUSTOMER COPY		FCI www.fciconnect.com		
ltr	ecn no	dr	date	linear	.X ±.3		projection	title 68PIN PCMCIA RECEPTACLE ASS'Y			
F					.XX ±.13						
					.XXX ±.050						
				angles	0° ±2°		MM ← →	product family PCMCIA		code	
		dr	KENNY TAI	12/17/02	scale			size		dwg no	sheet
		engr	KENNY TAI	12/17/02	1:1			A3		10014744	3 of
		chr	KENNY TAI	12/17/02							
		appd	PAUL WANG	12/17/02							
sheet index	revision sheet										

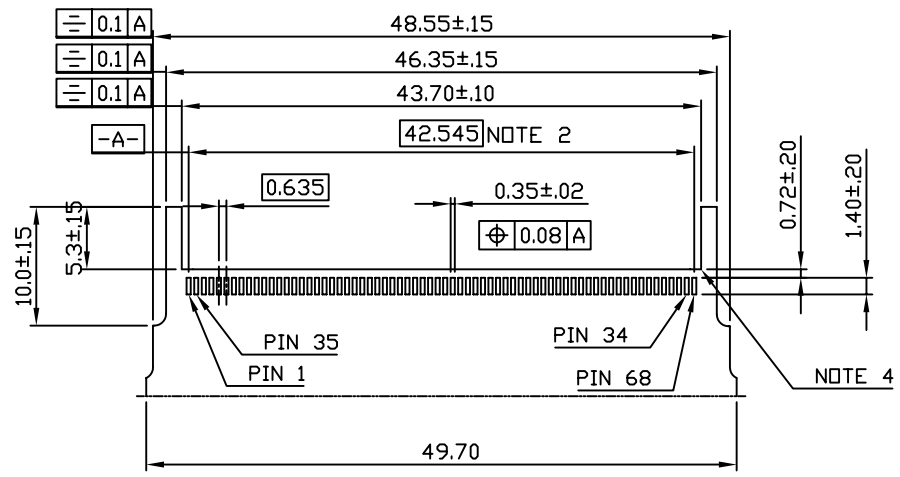

RECOMMENDED P.C.B. LAYOUT

NOTE:

1. MATERIAL:
CONTACT: PHBR 0.12t
HOUSING: LCP UL94V-0 (BLACK COLOR: -XXX; NATURAL COLOR: -NXX)
- FINISH:
CONTACT: ALL OVER--- Ni UNDER 0.5 MICRON THK.
CONTACT AREA--- Au 0.38 MICRON THK.
SOLDER TAIL---TIN LEAD 2.5 MICRON THK.
2. MAXIMUM PCB BOW ON THIS DIMENSION IS 0.1mm.
3. PACKING SPEC. REFER TO GS-14-723.
4. ELIMINATE THE CORNER TO PREVENT INTERFERENCE WITH SOLDER TAIL.
5. -XXX (-NXX) USE STD. PACKAGE, 1872 PCS / CARTON;
-XXXT (-NXXT) USE TAPE AND REEL, 750 PCS / REEL;
-XXXS (-NXXS) USE STD. PACKAGE, 200 PCS / CARTON;
-XXXX (-NXXA) USE TAPE AND TEEL, 600 PCS / REEL.
6. -NXX USE NATURAL COLOR HOUSING. EX. -N02 IS THE SAME WITH -002 EXCEPT NATURAL COLOR.
7. -XXXXLF IS LEAD FREE PLATING. SOLDER TAIL IS PLATED TIN 2.5 MICRON.
8. PRODUCT SPEC. REFER TO GS-12-228.

mat'l. code				tolerances unless otherwise specified				CUSTOMER COPY		FCI www.fciconnect.com	
ltr	ecn no	dr	date	linear	.X ±.3		projection	title			
G					.XX ±.13			68PIN PCMCIA RECEPTACLE ASS'Y			
					.XXX ±.050						
				angles	0° ±2°		MM	product family		code	
				dr	KENNY TAI	12/17/02		PCMCIA		-	
				engr	KENNY TAI	12/17/02		size	dwg no	sheet	
				chr	KENNY TAI	12/17/02		10014744	4 of		
				appd	PAUL WANG	12/17/02	scale	A3			
sheet index		revision sheet				1:1					

cage code 22526

STATUS Released

Printed Apr 08, 2006