

DO NOT SCALE FROM THIS PRINT

# HPMC-1XX-XX-Usas113

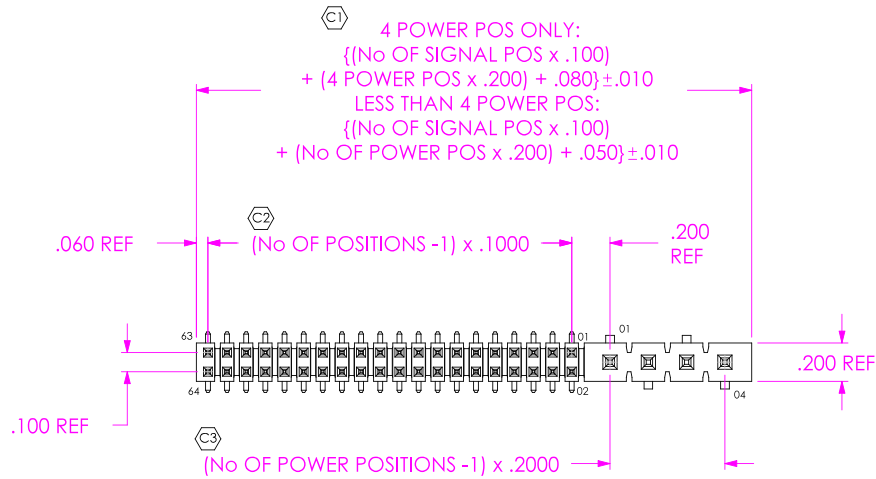

2° MAX SWAY (ANY DIRECTION)

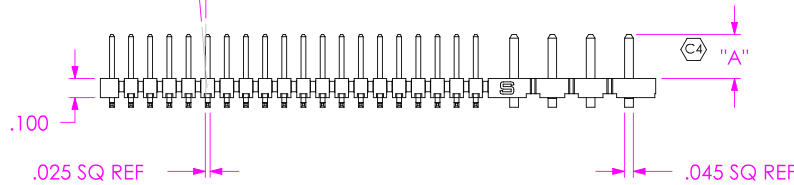

SURFACE MOUNT: STYLES -02, -04, -06

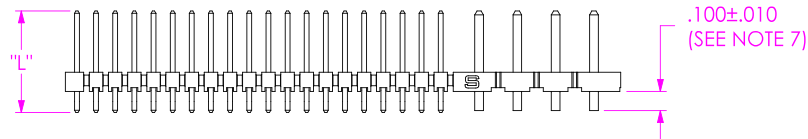

THROUGH HOLE: STYLES -01, -03, -05  
 [DIFFERENT AS SHOWN, OTHERWISE SAME AS SURFACE MOUNT]

No OF POSITIONS  
 -02 THRU -24 (PER ROW)

LEAD STYLE  
 -01, -03, \*-05: THROUGH HOLE  
 -02, -04, \*-06: SURFACE MOUNT (T-1S6-XX-X-2 & T-1S8-04-T) [SEE TABLE 1]

PLATING SPECIFICATION  
 -T: TIN (USE T-1S6-XX-T-2)  
 -L: LIGHT SELECTIVE GOLD (USE T-1S6-XX-L-2)

POWER POSITIONS  
 -02 THRU -04 (USE T-1S8-04-T)

ROW SPECIFICATION  
 -D: DOUBLE (USE HPMC-XX-D-X)

\* = NOT TOOLED

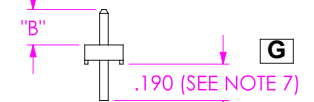

SURFACE MOUNT: IN-PROCESS 1 FOR POWER END

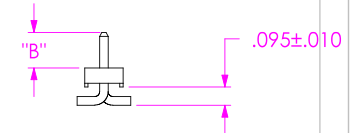

SURFACE MOUNT: IN-PROCESS 2 FOR POWER END

| No OF POS             | COPLANARITY |
|-----------------------|-------------|
| -02 THRU -20 (SIGNAL) | .0060       |
| -21 THRU -24 (SIGNAL) | .0080       |

NOTES:

- $\text{C1}$  REPRESENTS A CRITICAL DIMENSION.
- COPLANARITY (SEE TABLE 2)
- BURR ALLOWANCE: .0015 MAX.
- MAXIMUM CUT FLASH: .020.
- MINIMUM PUSHOUT FORCE: 1.0 LB.
- MAXIMUM ALLOWABLE BOW: .002 INCH/INCH AFTER ASSEMBLY.
- POWER END TAILS SHEARED TO ACHIEVE DIMENSION SHOWN.

TABLE 1

| LEAD STYLE | "A"  | "B"  | TERMINAL     | "L"  |
|------------|------|------|--------------|------|
| -01        | .230 | ---  | T-1S6-16-X-2 | .445 |
| -02        | .230 | .185 | T-1S6-16-X-2 | ---  |
| -03        | .320 | ---  | T-1S6-08-X-2 | .530 |
| -04        | .320 | .275 | T-1S6-08-X-2 | ---  |
| *-05       | .485 | ---  | T-1S6-23-X-2 | .695 |
| *-06       | .420 | .375 | T-1S6-15-X-2 | ---  |

\* = FOR BOTTOM MOUNT & PASS THROUGH

PACKAGING VIEW

SURFACE MOUNT

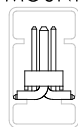

TUBE: PT-1-24-06-29  
 PLUG: TP-03

THROUGH HOLE

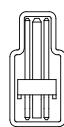

TUBE: PT-1-24-02-53  
 PLUG: TP-03

UNLESS OTHERWISE SPECIFIED, DIMENSIONS ARE IN INCHES.  
 TOLERANCES ARE:  
 DECIMALS ANGLES  
 .XX:  $\pm .01$  2°  
 .XXX:  $\pm .005$   
 .XXXX:  $\pm .0020$

PROPRIETARY NOTE

THIS DOCUMENT CONTAINS INFORMATION CONFIDENTIAL AND PROPRIETARY TO SAMTEC, INC. AND SHALL NOT BE REPRODUCED OR TRANSFERRED TO OTHER DOCUMENTS OR DISCLOSED TO OTHERS OR USED FOR ANY PURPOSE OTHER THAN THAT WHICH IT WAS OBTAINED WITHOUT THE EXPRESSED WRITTEN CONSENT OF SAMTEC, INC.

**MATERIAL:** DO NOT SCALE DRAWING SHEET SCALE: 1:1  
 INSULATOR: VECTRA E130i  
 COLOR: BLACK  
 SIGNAL TERMINAL: PHOS BRONZE  
 POWER TERMINAL: CDA 7025

F:\DWG\MISC\MKTG\HPMC-1XX-XX-USAS113-MKT.SLDDRW

**SAMTEC**

520 PARK EAST BLVD, NEW ALBANY, IN 47150  
 PHONE: 812.944.6733 FAX: 812.948.5047  
 e-Mail: [INFO@SAMTEC.COM](mailto:INFO@SAMTEC.COM) CODE: 55322

DESCRIPTION: HI POWER MALE COMBO  
 DWG. NO. HPMC-1XX-XX-DEAN4  
 BY: DEAN P 2/15/1999 SHEET 1 OF 1