

THIS DRAWING CONTAINS INFORMATION PROPRIETARY TO ADVANCED INTERCONNECTIONS CORPORATION. ANY REPRODUCTION, DISCLOSURE OR USE OF THIS DRAWING IS EXPRESSLY PROHIBITED EXCEPT AS ADVANCED INTERCONNECTIONS CORPORATION MAY OTHERWISE AGREE IN WRITING.

REV.	E.C.N.	DESCRIPTION	DR.	APPR'D	DATE
1	5598	NEW RELEASE	C.W.		9-21-94
2	5989	REDESIGNED	C.W.		8-2-95
3	7589	SEE ECN	G.G.		12-29-97

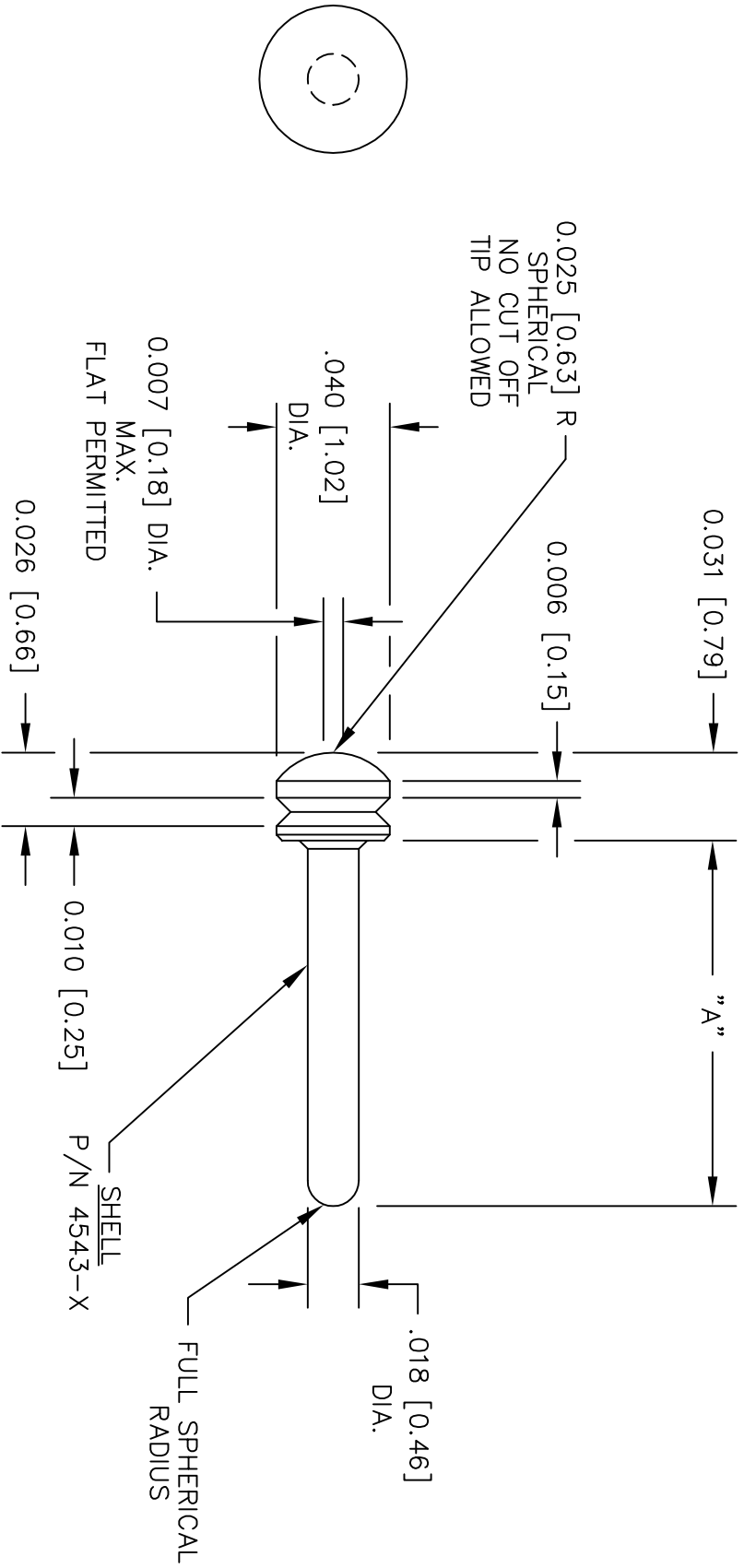

NOTES:

1. MATERIAL:

TERMINAL: BRASS, (FREE CUTTING) COPPER ALLOY No. C36000 PER ASTM-B-16 OR EQUIVALENT.

2. PLATING:

TL: TERMINAL: .000200 [.00508] 90% TIN 10% LEAD OVER .000050 [.00127] MIN. NICKEL.
G: TERMINAL: .000010 [.000254] MIN. GOLD OVER OVER .000050 [.00127] MIN. NICKEL.

3. THIS ITEM IS DESIGNED TO BE USED AS A PEEL-A-WAY® PRODUCT COVERED UNDER U.S. PATENT RE. 32540.

-689	4543-2XX	.180 [4.57]
-525	4543-1XX	.129 [3.28]
STYLE	PART No.	"A"



ADVANCED INTERCONNECTIONS®
 5 Energy Way, West Warwick, R.I. 02893

SCALE		DRAWN BY		CHECKED BY		DATE		APPROVED BY	
15 : 1		C. WILMOT				9-21-94			
TOLERANCES UN.O		TITLE:							
DEC.± --		SURFACE MOUNT ADAPTER TERMINAL							
FRAC.± --									
ANG.± --									
INCHES [MM]		FSC#61638		DRAWING NO.		4543-X-XX		REV.	
								3	