

PROGRAMMING JUMPERS

FEATURES

- Mates with .025" square or round posts on .100" grid
- Side and end stackable
- Dual wipe contact design (two points of contact per pin)
- Reliable, cost effective alternative to switches
- Multiple positions allows "gang loading"

MATERIALS

INSULATOR BODY	Glass Filled Polyester (UL94V-0)
CONTACT	Phosphor Bronze

STANDARD PART DIMENSIONS

INSULATOR BODY		Open Top Low Profile	Open Top	Closed Top	Open Top With Handle	Open Top Multiple Positions
W	WIDTH	0.196"/4,98mm	0.196"/4,98mm	0.196"/4,98mm	0.196"/4,98mm	0.196"/4,98mm
H	HEIGHT	0.177"/4,50mm	0.236"/5,99mm	0.255"/6,48mm	0.540"/13,72mm	0.236"/5,99mm
D	DEPTH	0.098"/2,49mm	0.098"/2,49mm	0.098"/2,49mm	0.098"/2,49mm	$\frac{\text{No. Contact}}{2} \times .100"(2,54\text{mm})$
INSERTION DEPTH		Open Top Low Profile	Open Top	Closed Top	Open Top With Handle	Open Top Multiple Positions
MINIMUM		0.140"/3,56mm	0.170"/4,32mm	0.170"/4,32mm	0.170"/4,32mm	0.170"/4,32mm
MAXIMUM		N/A	N/A	0.236"/5,99mm	0.230"/5,84mm	N/A

Specifications and Performance Data: Page 105

OPEN TOP (LOW PROFILE)

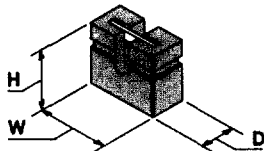

OPEN TOP

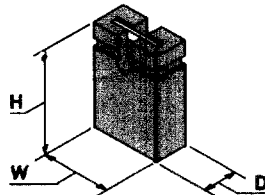

CLOSED TOP

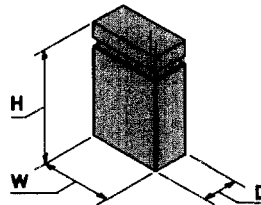

OPEN TOP WITH HANDLE

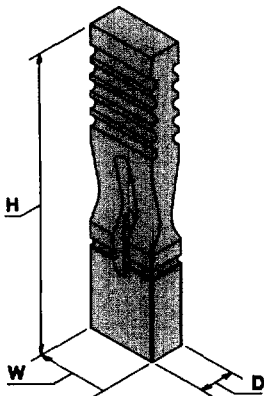

OPEN TOP MULTIPLE POSITIONS

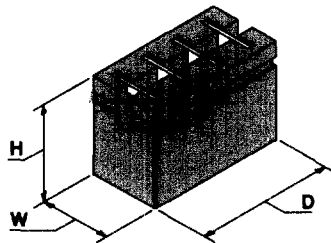

Jumpers are available pre-installed on your Crane header. Contact factory for ordering information.



PRODUCT SERIES	JUN								
	MJUN								
TOTAL NUMBER OF POSITIONS	JUN	02							
	MJUN	04 - 20							
NUMBER OF ROWS	SINGLE		S						
	DUAL (MJUN Only)		D						
TYPE OF JUMPER	STRAIGHT		S						
CONTACT PLATING (See Page 106)	CHOOSE G, T or H, F								
BODY TYPE	JUN SERIES	CLOSED TOP		C	B				
		OPEN TOP		O	A				
		OPEN TOP (LOW PROFILE)		O	S				
		OPEN TOP WITH HANDLE		O	H				
	MJUN SERIES	OPEN TOP - MULTIPLE POSITIONS		O	A				

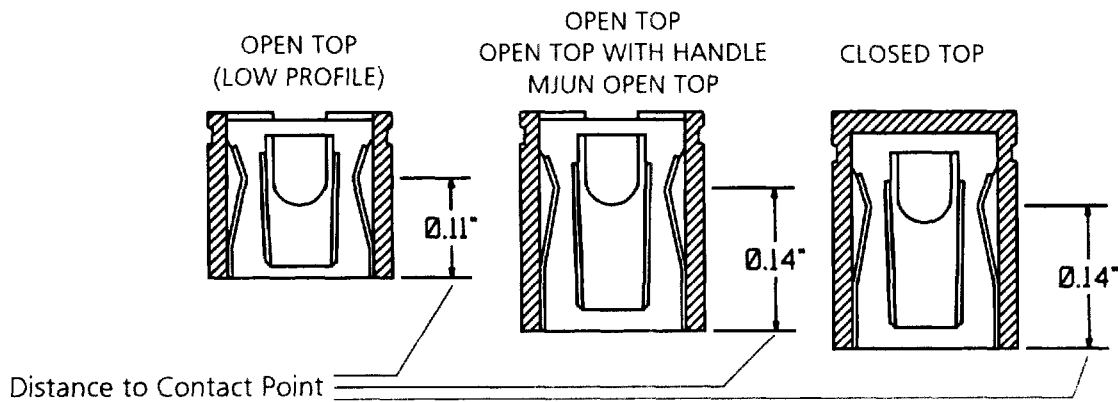

Note: Standard insulator color is black, but other colors are available. Call us!

Sample Hotline: 1-800-676-7644

Crane Connectors • 4700 Smith Road • Cincinnati, Ohio 45212