

## SPECIFICATIONS

## D-SUB Connector

### Mechanical

**Contact Retention Force:** 1.82kg (4.00Lb) min.  
**Contact Engagement Force:** 0.34kg (0.75Lb) max.  
**Contact Separation Force:** 0.021kg (0.05Lb) min.  
**Durability:** 500 Cycles

### DV Series

**Right Angle, T/H Type**  
**2.41mm [.100"] Pitch**  
**78 Pos.**

### Electrical

**Current Rating:** 2A  
**Contact Resistance:** 15mΩ max.  
**Dielectric Withstanding Voltage:** 1000V AC/1min min.  
**Insulation Resistance:** 5000MΩ min.

### Physical

**Housing:** Thermoplastic, UL 94V-0 rated in Black Color  
**Contact:** Copper alloy  
**Plating:** See "ORDERING INFORMATION"  
**Operating Temperature:** -20°C to +85°C  
**Recommended Thickness of PCB:** 1.57[.062]

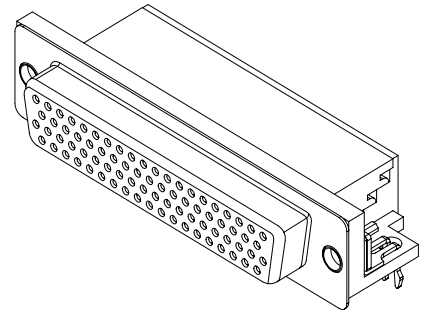

## DRAWING

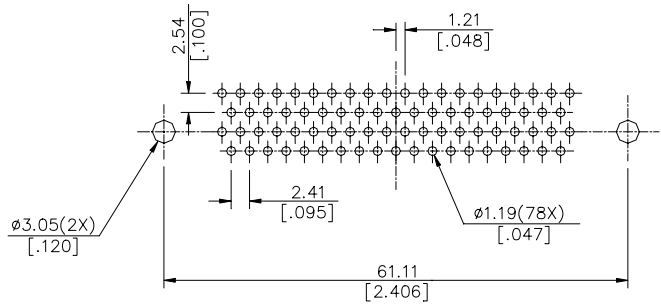
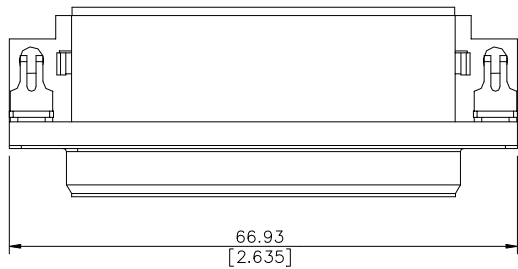

RECOMMENDED P.C.B. LAYOUT

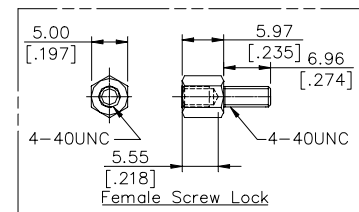
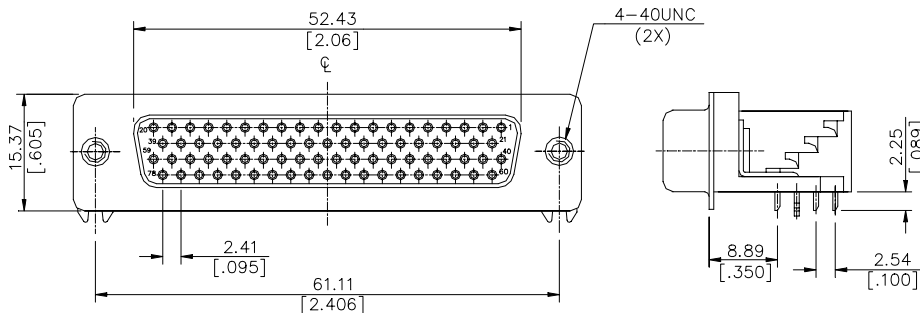

## ORDERING INFORMATION

PRODUCT NO.: DV 1 1 6 0 \* - \*\*

VGA Series  
 Body Type  
 1=Right Angle PCB Mount  
 Termination Type  
 1=Female  
 NO. of Pos.  
 6=H/D 78 Pos.  
 Body Length  
 0=8.89

Extension Code  
 Contact Area Plating  
 1=Gold Flash  
 2=20u" Gold  
 3=30u" Gold  
 6=10u" Gold  
 7=15u" Gold  
 F=Gold Flash(Lead Free)

DV1160*-G6	WITH FEMALE SCREW LOCK
DV1160*-G5	WITHOUT FEMALE SCREW LOCK
P/N	CHARACTER