

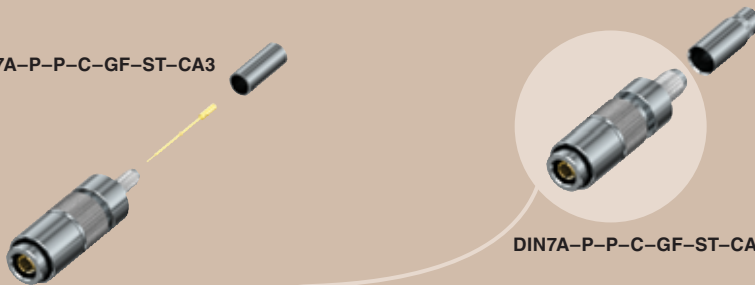

**DIN7A-CA SERIES**

DIN7A-P-P-C-GF-ST-CA3



DIN7A-P-P-C-GF-ST-CA6

# 75Ω DIN 1.0/2.3 COMPONENTS

## SPECIFICATIONS

For complete specifications and assembly instructions see [www.samtec.com?DIN7A-CA](http://www.samtec.com?DIN7A-CA)

- Shell Material:** Nickel
- Center Contact:** Au over 50μ" (1,27μm) Ni
- Outer Contact:** Au flash over 50μ" (1,27μm) Ni
- Signal Pin:** Soldered
- Outer Ferrule:** Crimped
- Impedance:** 75Ω
- Frequency Range:** Testing Now!
- V.S.W.R.:** Testing Now!
- Working Voltage:** Testing Now!
- Dielectric Withstanding:** Testing Now!
- Contact Resistance:** Center Contact: Testing Now!  
Outer Contact: Testing Now!
- Insulator Resistance:** Testing Now!

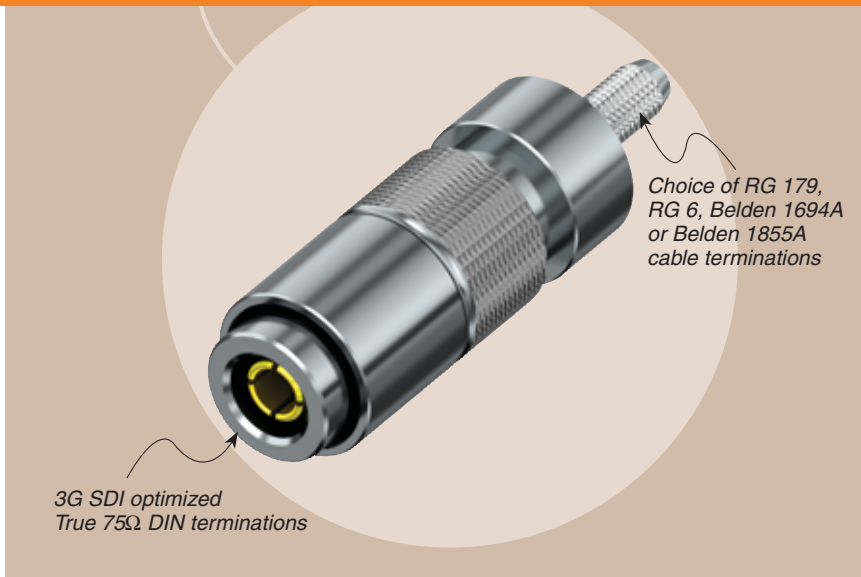

DIN7A	STYLE	GENDER	TYPE	PLATING	ORIENTATION	TERMINATION
	-P = Push Pull	-P = Plug	-C = Cable	-GF = 10μ" (0,25μm) Gold on contact, Flash Gold on outer contact, Nickel on shell	-ST = Straight	-CA3 = RG 179 Cable  -CA6 = RG 6 or Belden 1694A Cable  -CA8 = Belden 1855A Cable

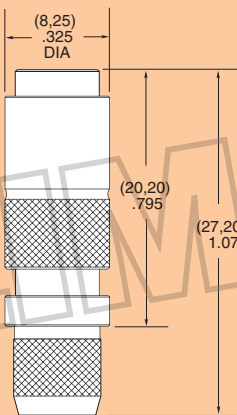

Supplied with pins and ferrules. See website for dimensions.

Due to technical progress, all designs, specifications and components are subject to change without notice.

[WWW.SAMTEC.COM](http://WWW.SAMTEC.COM)