

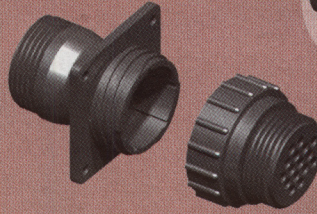

RCC1-17-16-M



RCC1-11-04-F



RCC1-11-04-M



RCC1-17-16-F

\*Note: Wire supplied by others. Not assembled by Samtec. Pin or Socket must be specified separately.

# RUGGED CIRCULAR RCC1 SERIES

## SPECIFICATIONS

For complete specifications see [www.samtec.com?RCC1](http://www.samtec.com?RCC1)

**Insulator Material:**

Black Thermoplastic

**Pin Material:**

See T-1R29

**Socket Material:**

See C-194

**Operating Temp Range:**

-55°C to +125°C

**Requires:**

Pin T-1R29 or  
Socket C-194 and  
customer assembly

Optional Strain Relief  
(Cable Clamp)

Locking collar,  
Align & Latch  
features

Male or  
Female

Ideal for high  
vibration,  
high shock  
applications

Polarized  
and keyed

### ALSO AVAILABLE

Assembly Tooling.  
Contact [atg@samtec.com](mailto:atg@samtec.com)

Shell sizes  
11, 13, 17 or 23

Unshielded,  
100% Thermoplastic

4, 9, 16, 24  
or 37 positions

RCC1	SHELL SIZE	NO. OF POSITIONS	GENDER	OPTION
------	------------	------------------	--------	--------

### SPECIFY FROM CHART

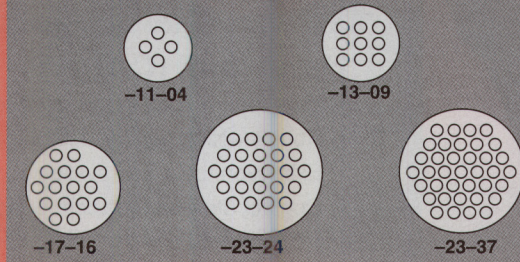

-F  
= Female

-M  
= Male

-SR  
= Strain Relief  
(Cable Clamp)

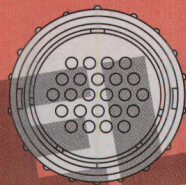
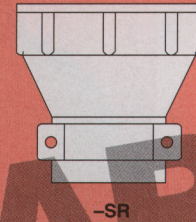

-F  
(-23-24 SHOWN)

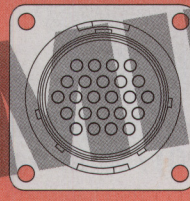

-M  
(-23-24 SHOWN)

SHELL SIZE	A (DIA)	B (SQ)
-11	(23,93) 0.942	(28,58) 1.125
-13	(27,18) 1.070	(32,54) 1.281
-17	(33,40) 1.315	(36,45) 1.435
-23	(44,43) 1.743	(44,45) 1.750

Due to technical progress, all designs, specifications and components are subject to change without notice.

[WWW.SAMTEC.COM](http://WWW.SAMTEC.COM)