



TAI-SAW TECHNOLOGY CO., LTD.

No. 3, Industrial 2nd Rd., Ping-Chen Industrial District,
Taoyuan, 324, Taiwan, R.O.C.

TEL: 886-3-4690038 FAX: 886-3-4697532

E-mail: tstsales@mail.taisaw.com Web: www.taisaw.com

Product Specifications Approval Sheet

Product Description: SAW Filter 221.6 MHz SMD 5.0x5.0 mm

TST Part No.: TA0576A

Customer Part No.: _____

Customer signature required
Company: _____
Division: _____
Approved by : _____
Date: _____

Checked by: _____ David Chang 張閱智

Approved by: _____ Francis Chen (Signature)

Date: _____ 2009/05/21

1. Customer signed back is required before TST can proceed with sample build and receive orders.
2. Orders received without customer signed back will be regarded as agreement on the specifications.
3. Any specifications changes must be approved upon by both parties and a new revision of specifications shall be released to reflect the changes.



TAI-SAW TECHNOLOGY CO., LTD.

No. 3, Industrial 2nd Rd., Ping-Chen Industrial District,
Taoyuan, 324, Taiwan, R.O.C.

TEL: 886-3-4690038 FAX: 886-3-4697532

E-mail: tstsales@mail.taisaw.com Web: www.taisaw.com

SAW Filter 221.6 MHz

MODEL NO.: TA0576A

REV. NO.: 2

A. MAXIMUM RATING:

1. Input Power Level: 15 dB_m
2. DC voltage: 5 V
3. Operating Temperature: -40°C to +85°C
4. Storage Temperature: -40°C to +85°C

RoHS Compliant
Lead free
Lead-free soldering

B. ELECTRICAL CHARACTERISTICS:

Item	Unit	Min.	Typical	Max.
Center frequency F_c	MHz	-	221.6	-
Minimum Insertion Loss IL_{min} (reference level)	dB	-	1.95	3.0
Amplitude ripple 218.1~225.1 MHz	dB	-	1.1	2.2
3dB Bandwidth BW_{-3dB}	MHz	7	10	-
Attenuation (Reference level from IL_{min})				
10 ~ $F_c - 35$ MHz	dB	38	43	-
$F_c + 35$ ~ 500 MHz	dB	38	50	-
Source impedance Z_s	Ω	-	50	-
Load impedance Z_L	Ω	-	50	-

Note: IL_{min} is the minimum of the pass band attenuation. The center frequency F_c is the mean value of the upper and lower frequencies at the 3dB filter attenuation level relative to the IL_{min} .

C. MEASUREMENT CIRCUIT:

HP Network analyzer

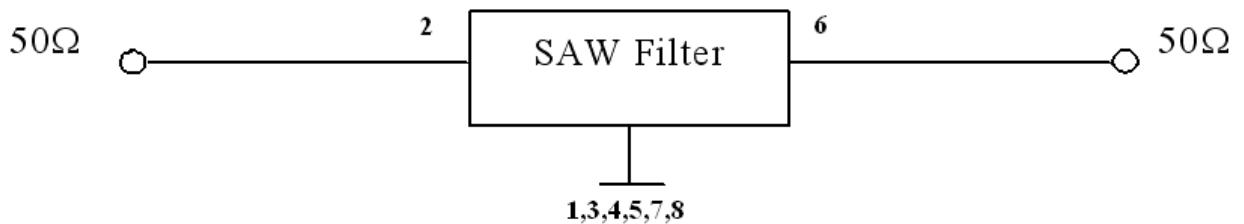

D. Frequency Characteristics :

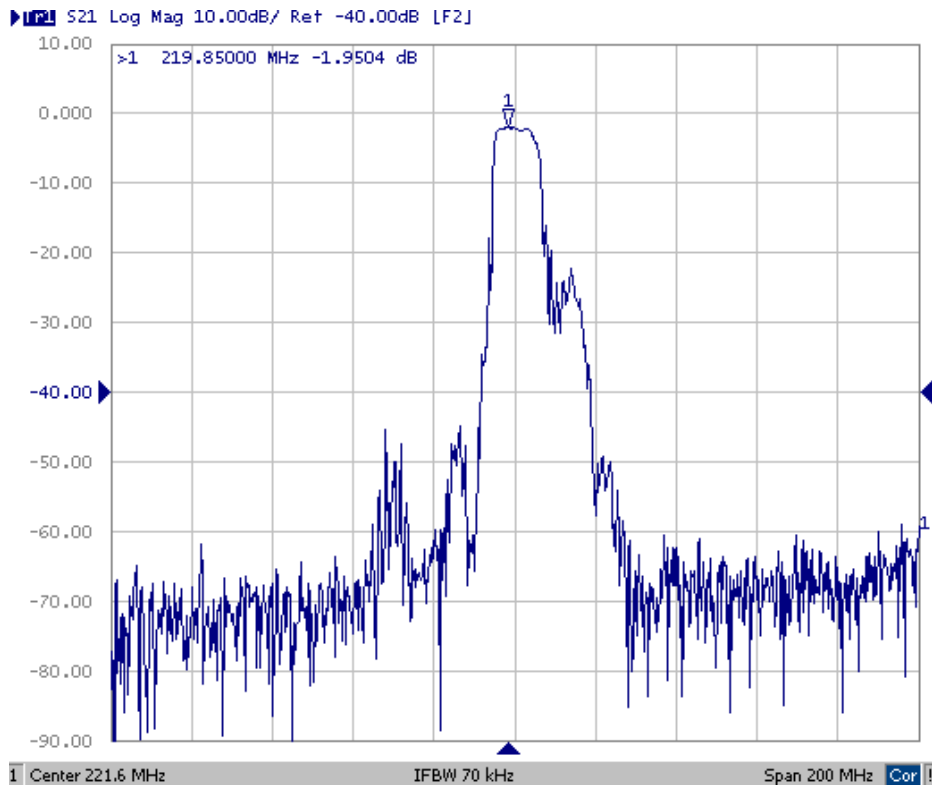
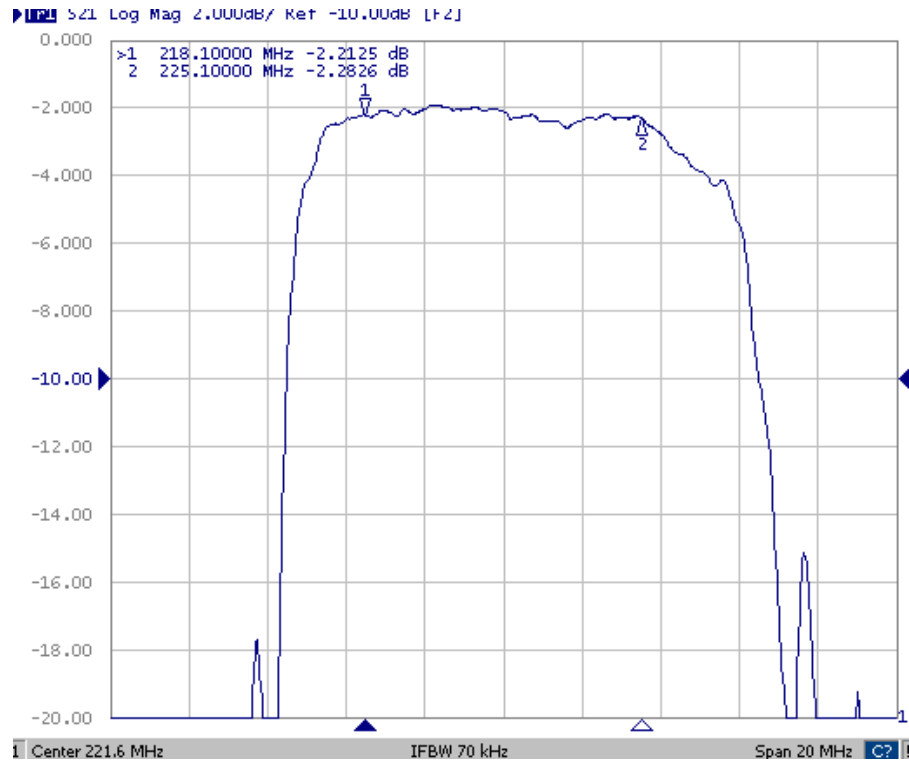

E.OUTLINE DRAWING:

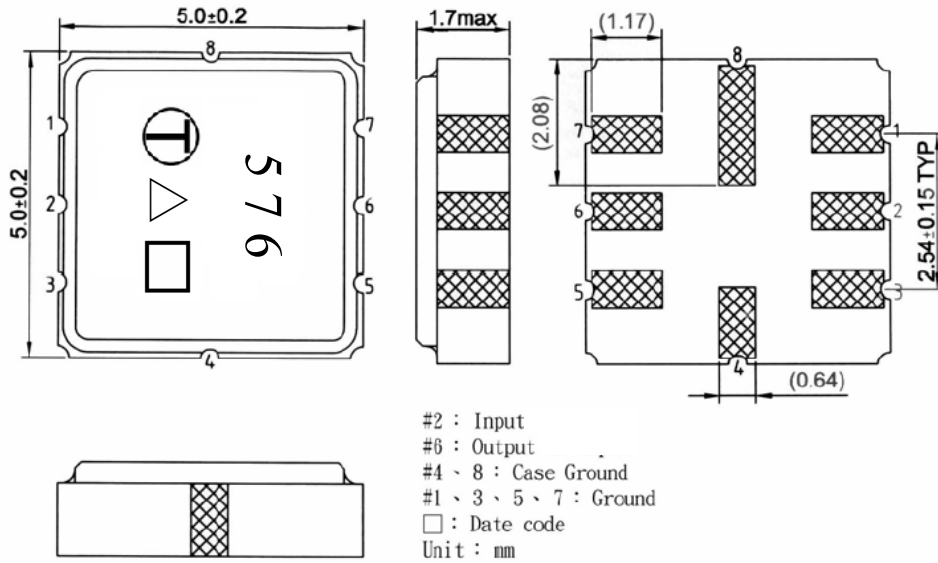

□ Date code: Provided by planer each year

△ Product Year Code

Year	2005 2009	2006 2010	2007 2011	2008 2012
Product Code	A	a	<u>A</u>	<u>a</u>

F.PCB FOOTPRINT:

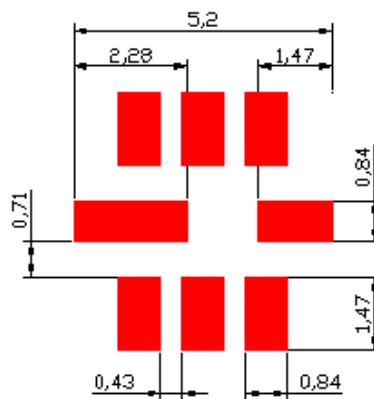

G. PACKING:

1. REEL DIMENSION

7"=1000

13"=3000

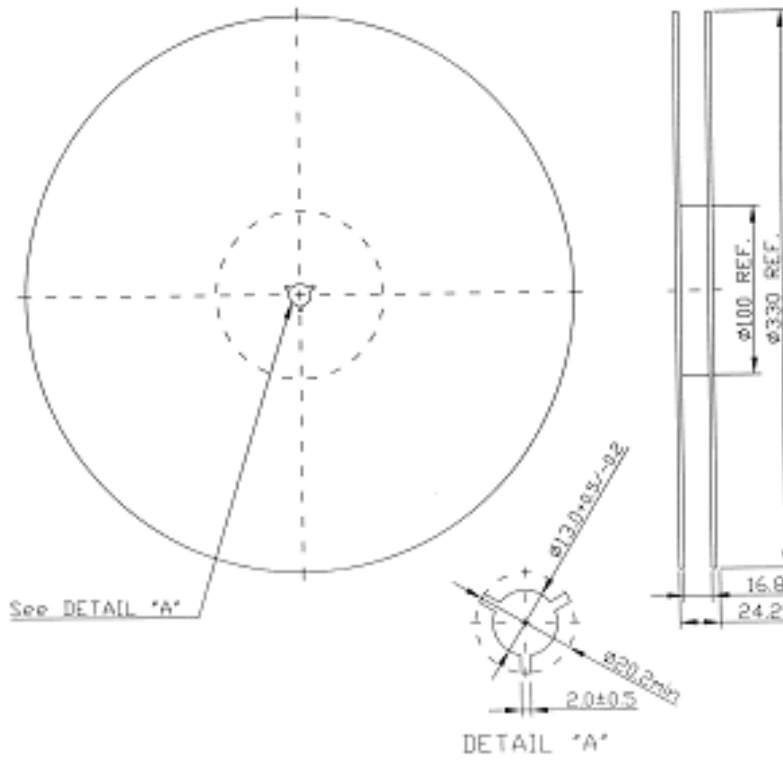

2. TAPE DIMENSION

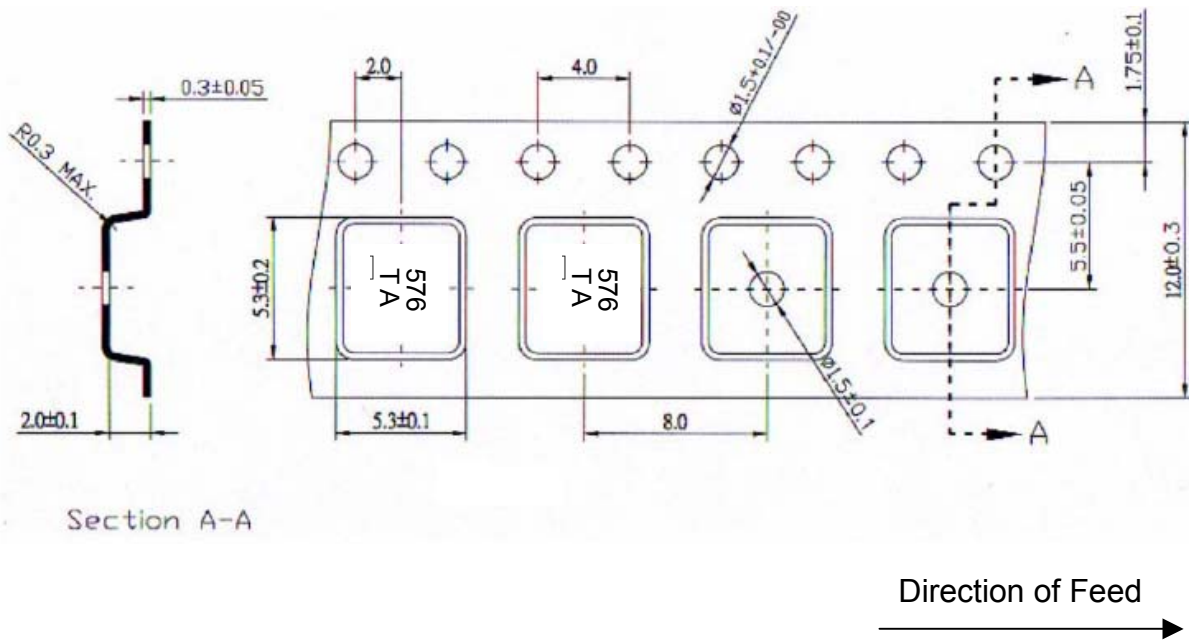

H.RECOMMENDED REFLOW PROFILE:

