

Rev	AWO #	Description	Date	Appr
-		RELEASED	9/10/10	

APPROVED: _____
 DATE: _____ TITLE: _____

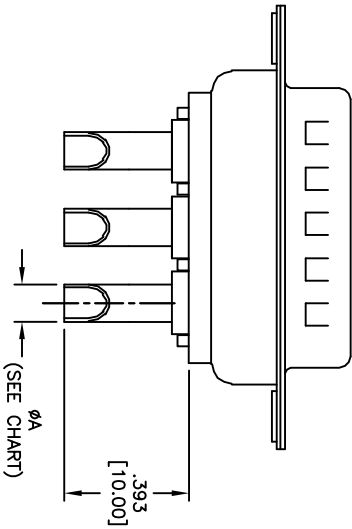

ADAM TECH PART NO.	CURRENT RATING	WIRE SIZE	DIMENSION	
			A	B
D3W3-PDP-61	40 AMPS	8-10 AWG	ϕ .181 [4.60]	ϕ .216 [5.50]
D3W3-PDP-51	30 AMPS	10-12 AWG	ϕ .146 [3.70]	ϕ .181 [4.60]
D3W3-PDP-41	20 AMPS	12-14 AWG	ϕ .106 [2.70]	ϕ .141 [3.60]
D3W3-PDP-31	10 AMPS	16-18 AWG	ϕ .067 [1.70]	ϕ .098 [2.50]

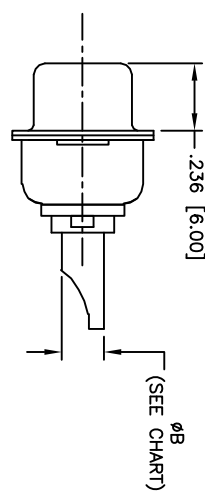
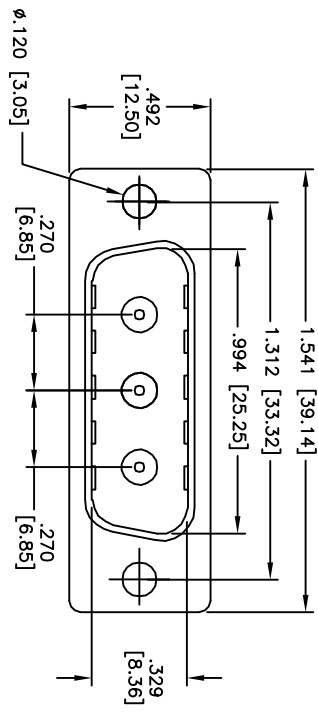
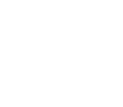

UNLESS OTHERWISE SPECIFIED
 ALL DIMENSIONS ARE INCHES [MM]
 TOLERANCES: EXCEPT AS NOTED
 INCHES HOLEES

.X	\pm .10	ϕ XX	\pm .10
.XX	\pm .020	ϕ XXX	\pm .015
.XXX	\pm .015	ϕ XXX	\pm .010

ADAM TECH
 909 Rahway Avenue, Union, NJ 07083
 Phone: 908-687-5000 Fax: 908-687-5710

TITLE: D-SUB POWER PLUG, D3W3, STRAIGHT, FEMALE, SOLDER CUP

DRAWN	AY	9/10/10	SIZE	PART NO.	REV.
CHECKED	VW	9/10/10	X	D3W3-PDP-X1	-
APPROVED			REF:	S00019T	SCALE: NTS

A
 Specifications:
 Material: Insulator: PBT, 30% glass reinforced, rated UL 94V-0
 Insulator color: Black
 Contacts: Brass
 Shell: Steel, Tin plated
 Hardware: Brass, Nickel plated
 Plating: Gold flash over Nickel underplate overall
 Electrical: Operating voltage: 250 VAC max
 Current rating: 10 - 40 Amps max (See Chart)
 Contact resistance: 10 mohms max
 Insulation resistance: 5,000 Mohms min
 Dielectric withstanding voltage: 1,000 VAC for 1 minute
 Temperature Rating: Operating temperature: -55°C to +280°C
 Environmental: Lead free, RoHS compliant

B

A

B

C

D

6

5

4

3

2

1