

## DETAILS

Product Number	CA12070_EMILY-M2
Family	Emily
Type	Assembly
Color	clear
Diameter	26 mm
Height	15 mm
Style	round
Optic Material	PMMA
Holder Material	
Fastening	tape, pin
Status	production ready
ROHS Compliant	Yes
Date Updated	7/07/2016

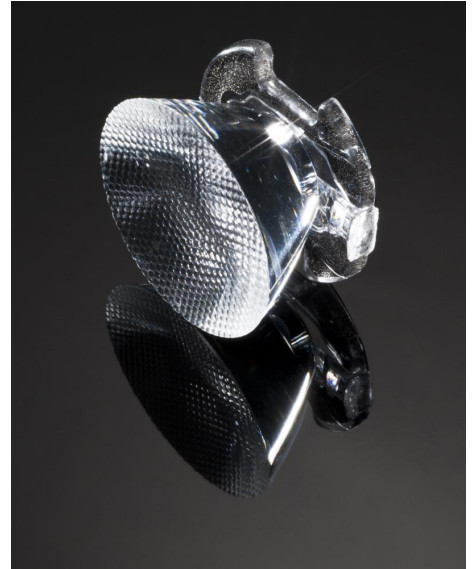

## OPTICAL PROPERTIES

LED	Viewing	Light	Efficiency	cd/lm	Connector
	Angle	Beam			
XM-L	28 deg	M2-class	92 %	-	-
XM-L HVV	sim: 30	M2-class	88 %	-	-
XM-L2	29 deg	M2-class	90 %	3.800	-
XP-L HI	27 deg	M2-class	89 %	4.100	-
NS9x383	26 deg	M2-class	89 %	3.400	-

4

4

Beam direction Emily-0-90

Beam direction Emily-0

Bottom view

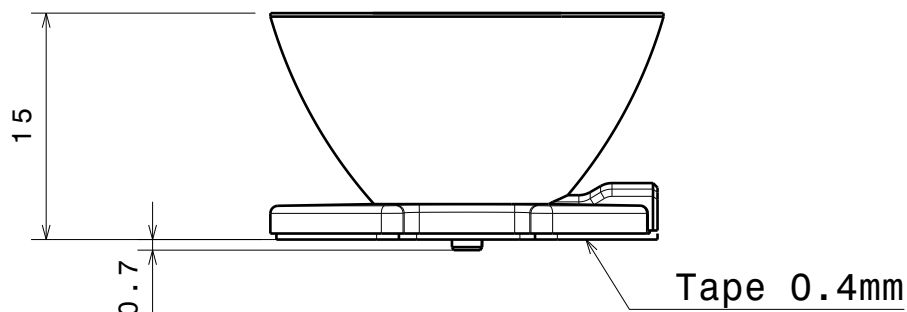

Tape 0.4mm

Front view

Material:  
Lens: PMMA  
Tape: PU Foam with adhesive

Part no.s:  
CA12062\_Emily-SS  
CA12064\_Emily-M  
CA12066\_Emily-0  
CA12068\_Emily-0-90  
CA12070\_Emily-M2

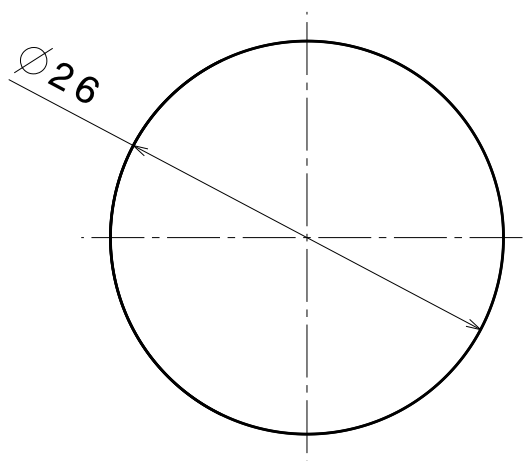

Top view

Tolerances if not otherwise shown  
According to DIN ISO 2768-1  
Linear measures:  
up to 30mm class M, otherwise class C  
According to DIN ISO 2768-2  
Form and position: class L

LEDiL

Ledil Oy  
Salorankatu 10  
FIN 24240 SALO  
Finland

THIRD ANGLE PROJECTION:

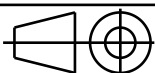

DRAWING TITLE

Datasheet Emily-RE-ES series lens

This drawing is the property  
of LEDiL Oy. It may not be  
reproduced, copied or  
communicated without a written  
agreement with LEDiL Oy.

SIZE

A4

PART NUMBER

SCALE

2:1 WEIGHT

SHEET

1/1

D

A

1

Luminaire: Ledil Oy CA12070\_Emily-M2-Tape-XM CA12070\_Emily-M2-Tape-XM Cree XM-L (white) 97lm @ 250 mA LOR=92%  
Lamps: 1 x Cree XM-L (white) 97lm @ 250 mA

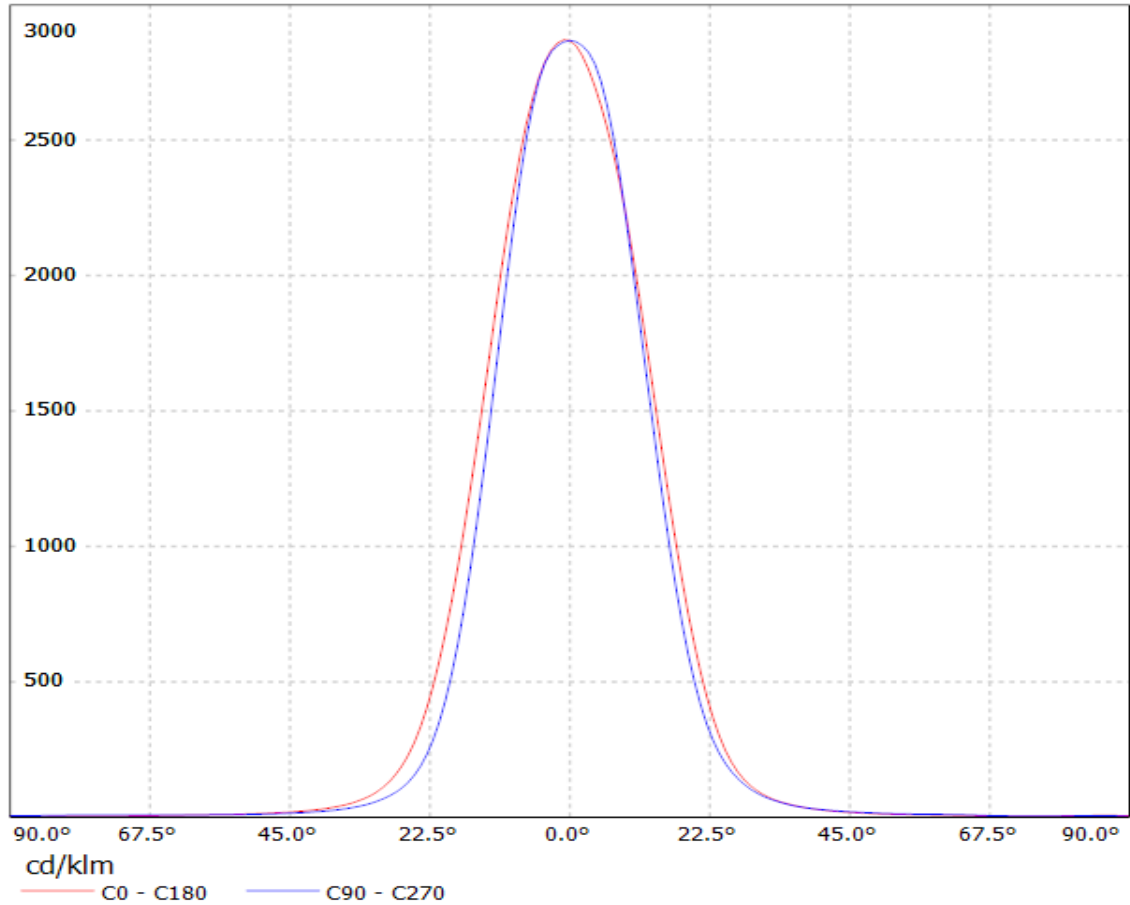

Luminaire: LEDil Oy CA12070\_EMILY-M2\_(XM-L2) Efficiency=90%  
Lamps: 1 x Cree XM-L2 (XMLBWT-0-7B4-T30-0L-0001) 91lm @ 250mA CCT=3200K P=0.7W I=250mA

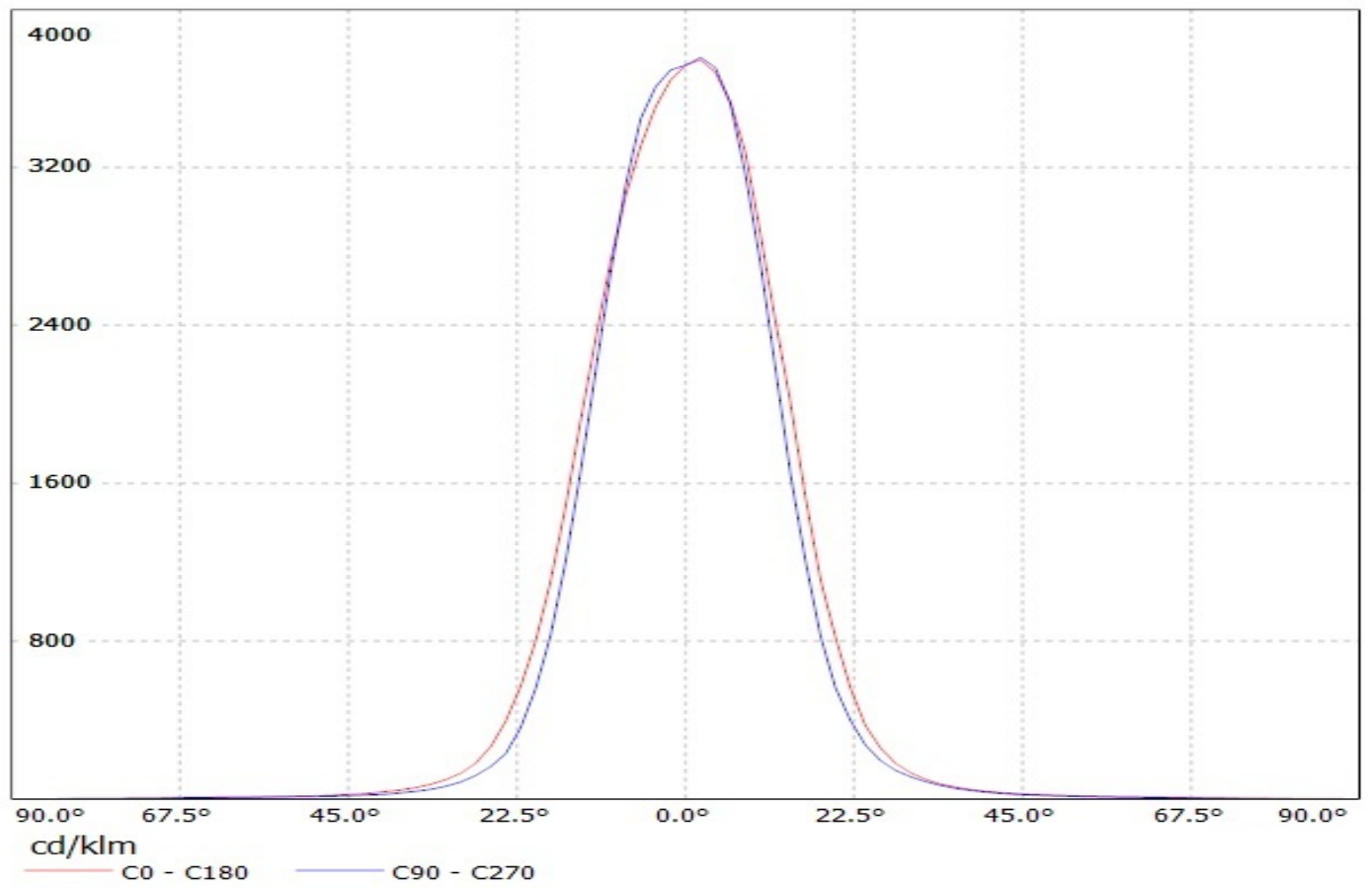

## Ledil CA12070\_EMILY-M2\_(XP-L\_HI) / LDC (Linear)

Luminaire: Ledil CA12070\_EMILY-M2\_(XP-L\_HI)

Lamps: 1 x CREE\_XP-L\_HI\_116.971lm@250mA\_P=0.75W\_I=0.25A

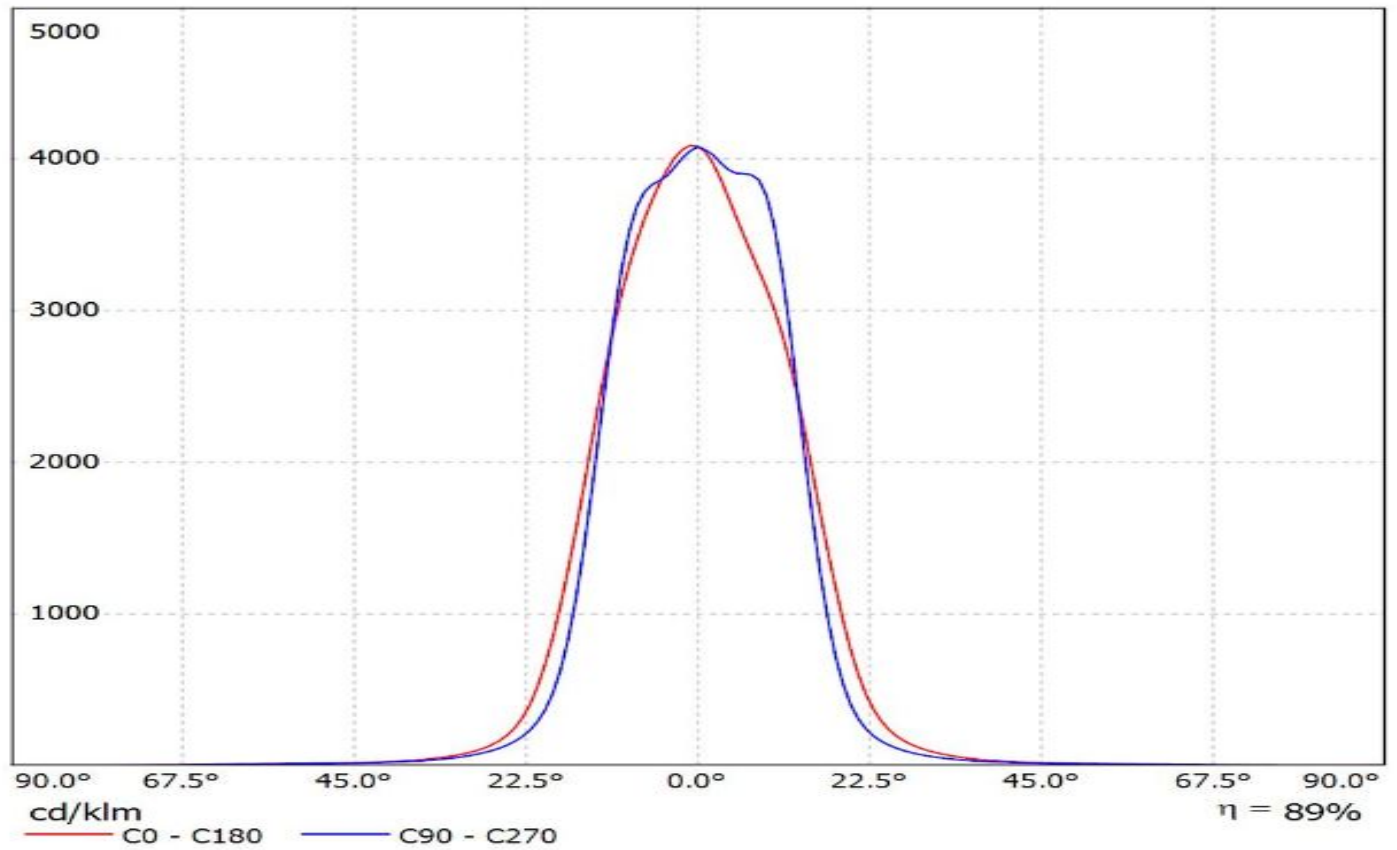

Luminaire: LEDiL Oy CA12070\_EMILY-M2\_(NS9x383) Eff.88,5%  
Lamps: 1 x Nichia NS9x383 (105lm@250mA)

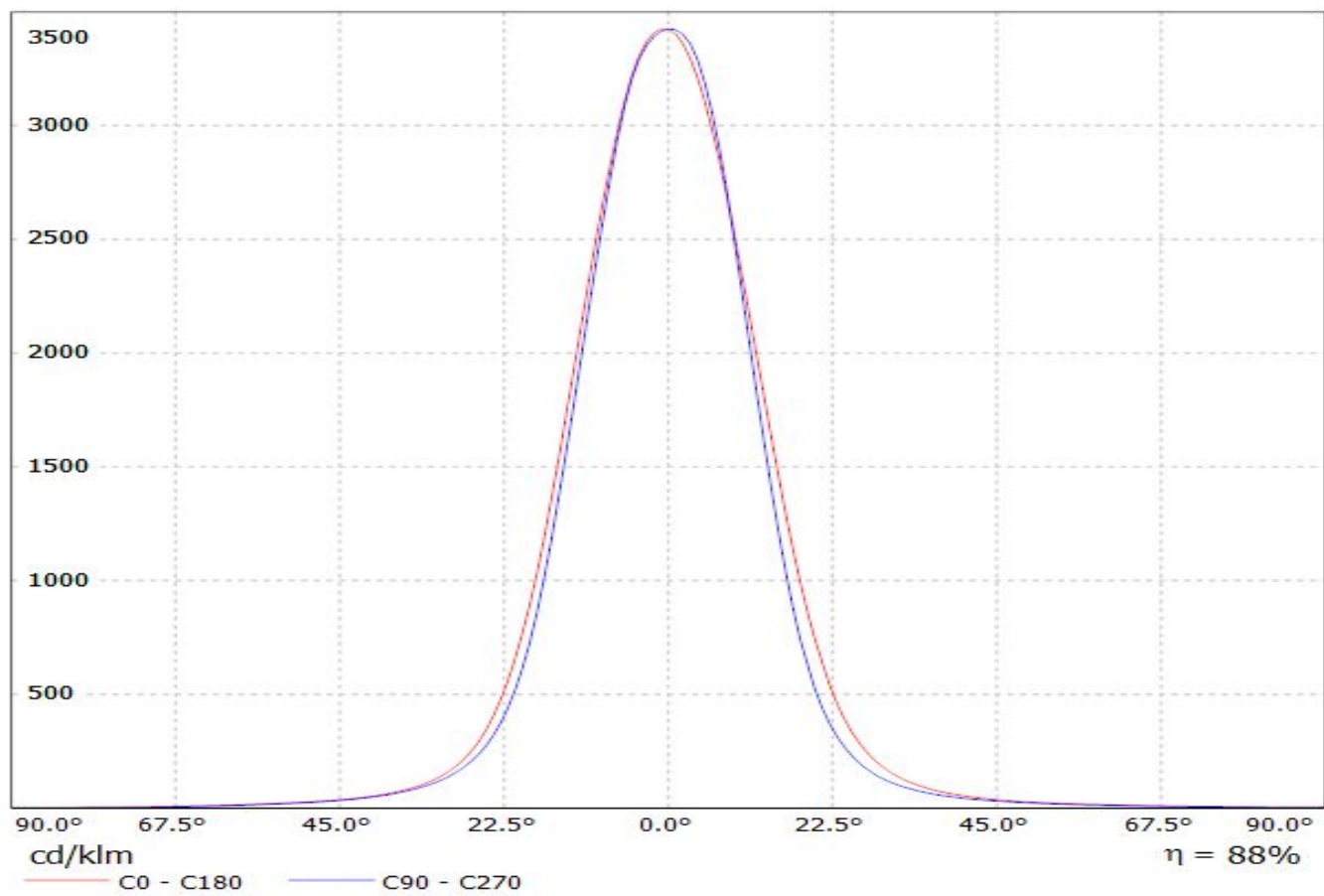

Luminaire: Ledil Oy CA12070\_Emily-M2-Tape-XM CA12070\_Emily-M2-Tape-XM Cree XM-L (white) 97lm @ 250 mA LOR=92%  
Lamps: 1 x Cree XM-L (white) 97lm @ 250 mA

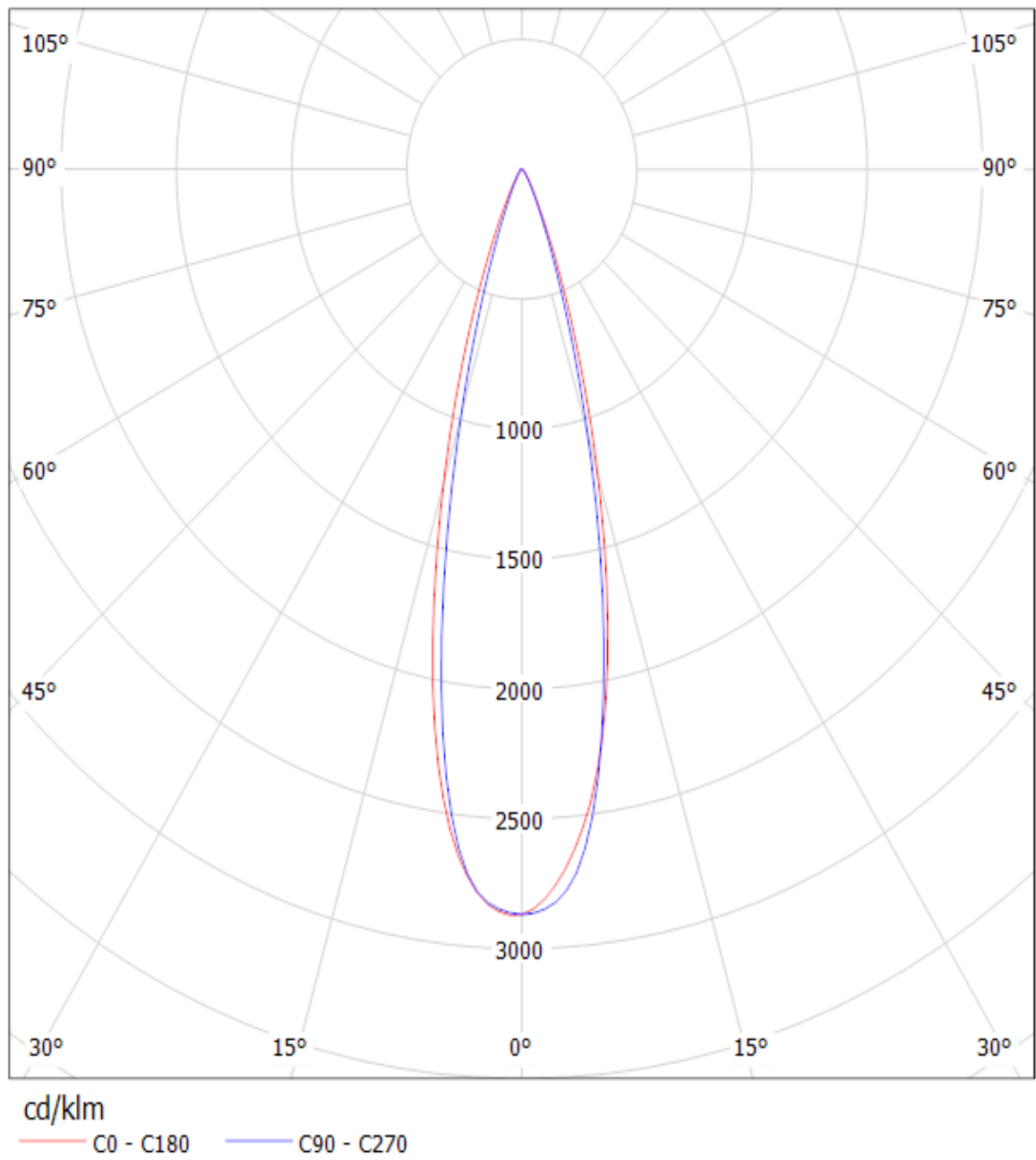

Luminaire: LEDil Oy CA12070\_EMILY-M2\_(XM-L2) Efficiency=90%

Lamps: 1 x Cree XM-L2 (XMLBWT-0-7B4-T30-0L-0001) 91lm @ 250mA CCT=3200K P=0.7W I=250mA

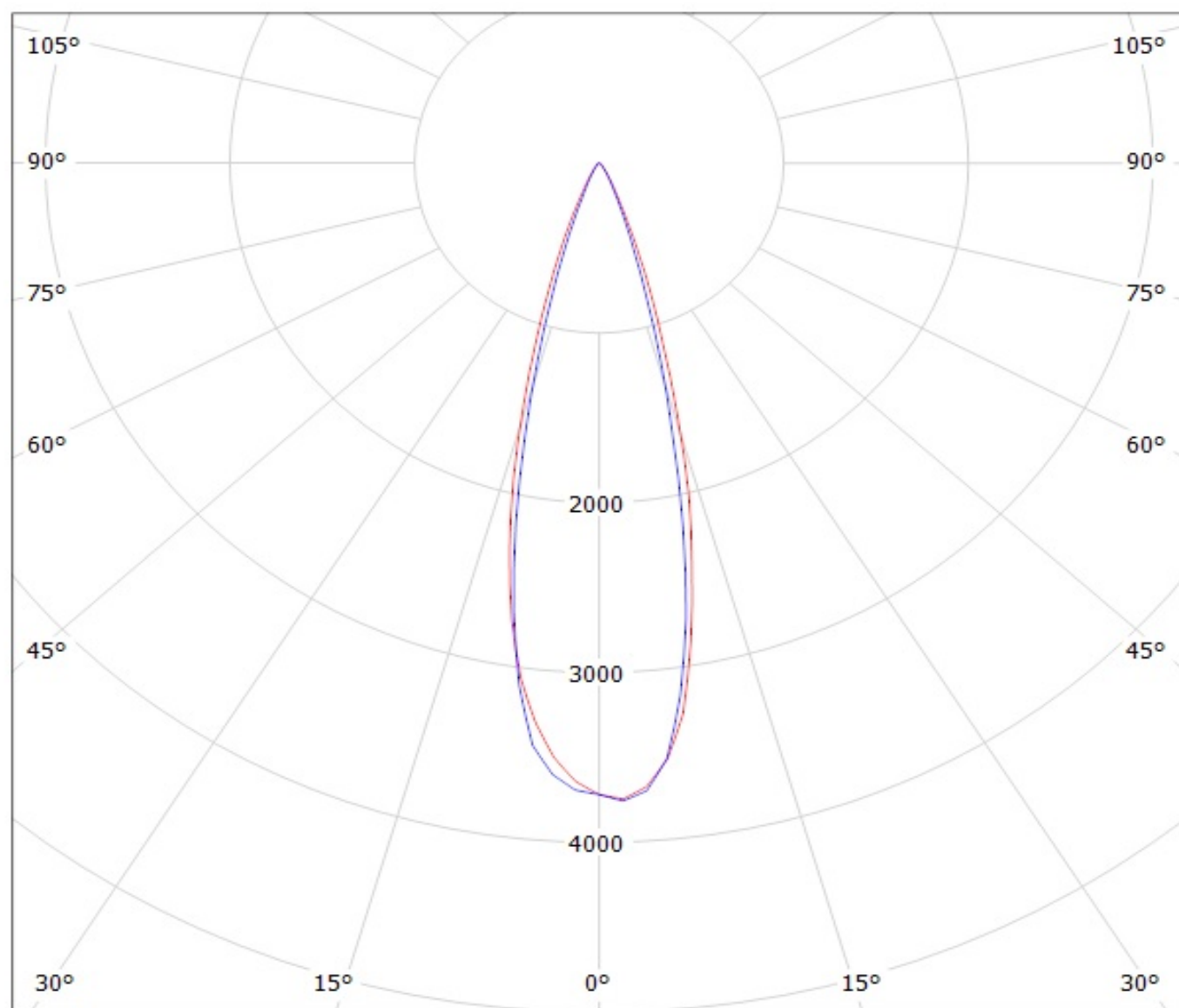

cd/klm

— C0 - C180

— C90 - C270



## Ledil CA12070\_EMILY-M2\_(XP-L\_HI) / LDC (Polar)

Luminaire: Ledil CA12070\_EMILY-M2\_(XP-L\_HI)

Lamps: 1 x CREE\_XP-L\_HI\_116.971lm@250mA\_P=0.75W\_I=0.25A

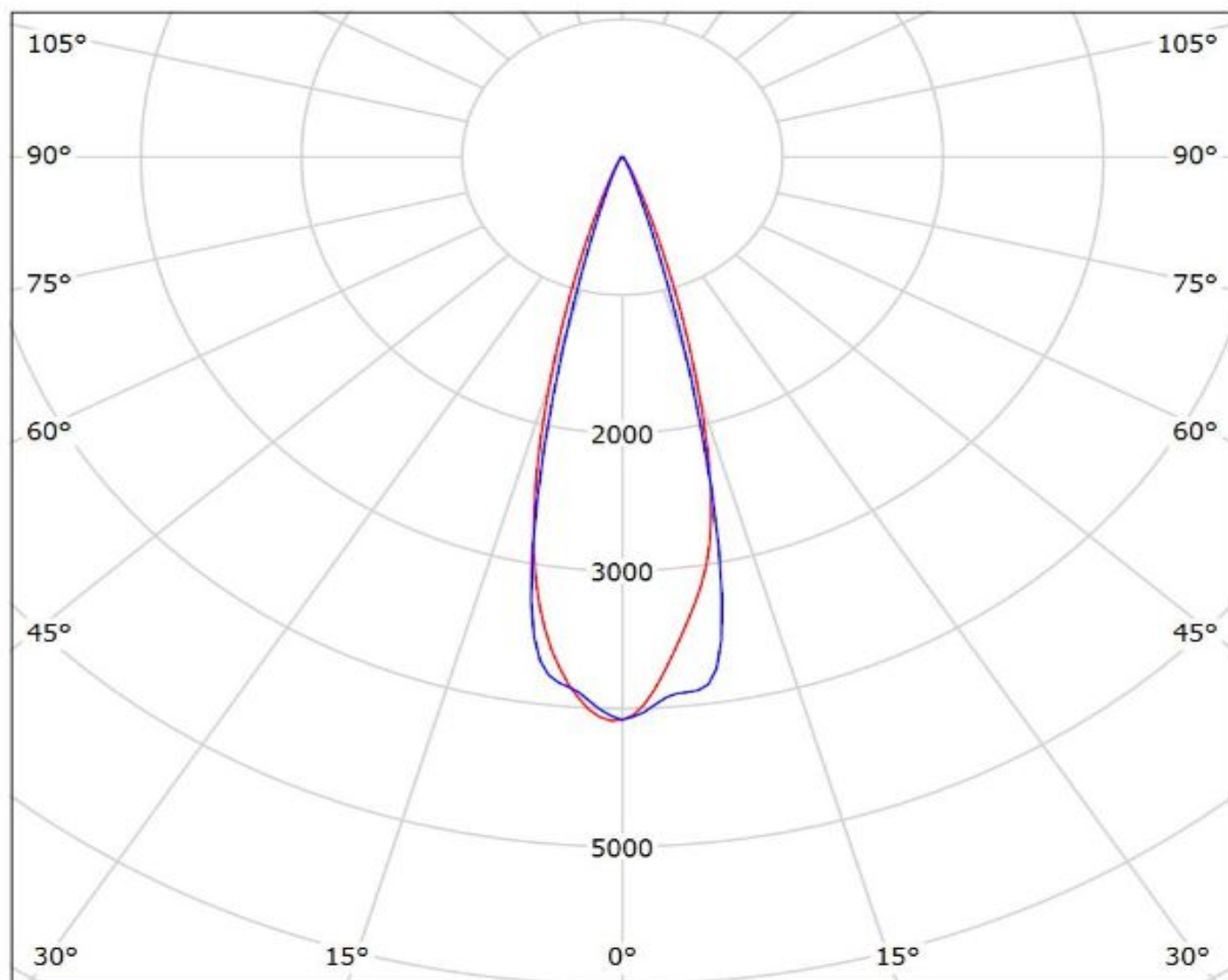

cd/klm

— C0 - C180

— C90 - C270

$\eta = 89\%$

Luminaire: LEDiL Oy CA12070\_EMILY-M2\_(NS9x383) Eff.88,5%  
Lamps: 1 x Nichia NS9x383 (105lm@250mA)

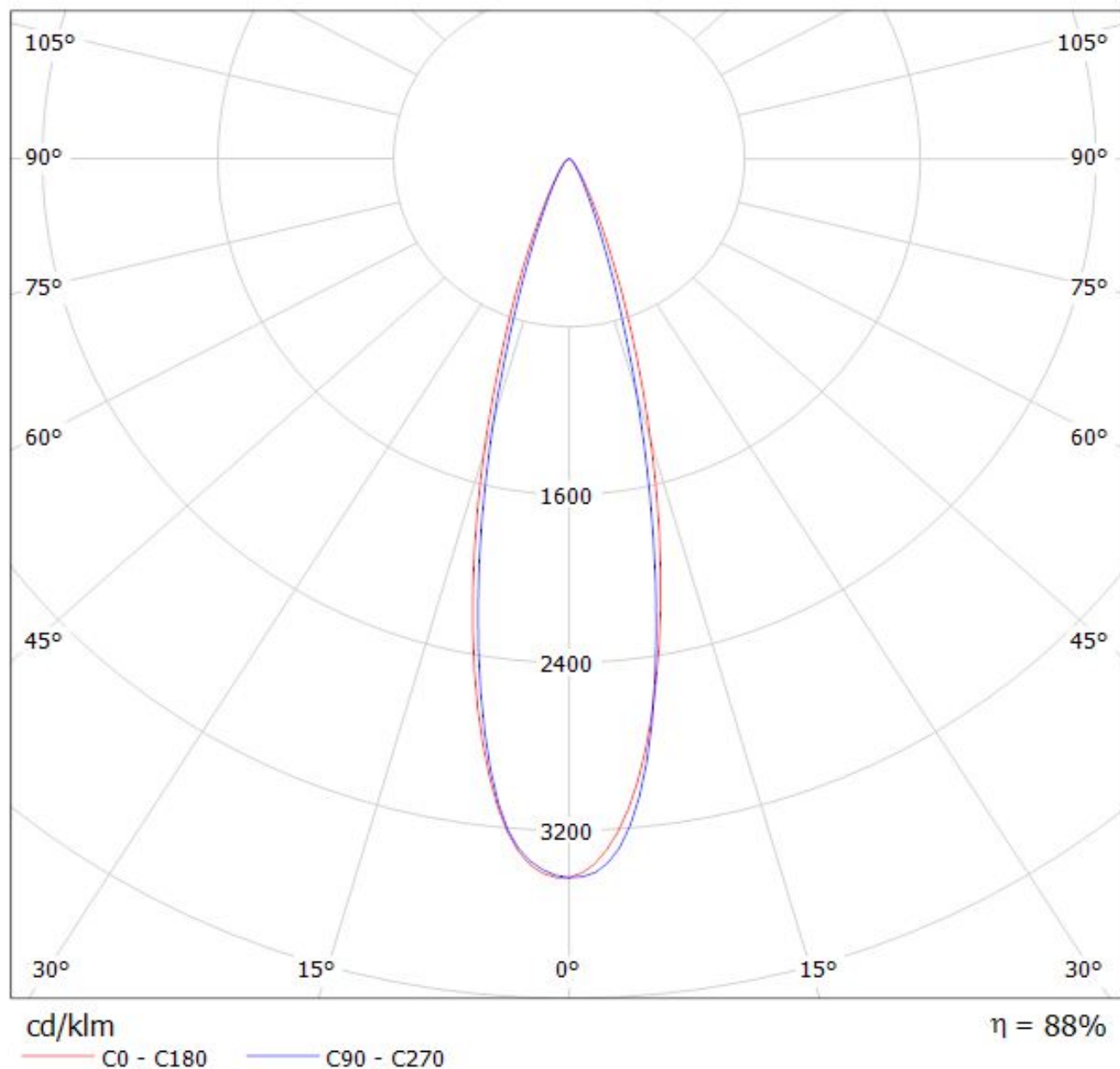

**NOTE: The typical divergence will be changed by different color, chip size and chip position tolerance. The typical total divergence is the full angle measured where the luminous intensity is half of the peak value.**