

# HIGH CURRENT INDUCTORS FOR INVERTER SYSTEMS



## H1300 SERIES



- Ideal for use in PV Inverters, String Inverters, Bidirectional Inverters
- Flat wire coil minimizes losses at high frequency
- Superior thermal management and significantly reduced size and weight compared with conventional toroid designs
- Operating Temperature -40°C to +180°C
- Custom Design Available up to 500A current for inverter systems 20kW and up

### ELECTRICAL PARAMETERS @ 25°C

Part Number	INDUCTANCE ( $\mu$ H)  $\pm 12\%$	DCR (m $\Omega$ )  MAX	SRF (MHz)  TYP	Isat (A) TYP			Irms (A) TYP	
				10% Drop	20% Drop	30% Drop	20°C Rise	40°C Rise
				H1300-260	26.0	1.5	11.5	55
H1300-400	40.0	2.3	9.0	44	65	85	53	81
H1300-780	78.0	4.2	6.2	31	47	61	39	59
H1300-940	94.0	5.2	6.5	28	43	56	35	54
H1300-151	150.0	8.7	4.4	23	34	44	27	41
H1300-161	160.0	9.0	3.5	22	32	42	26.5	40.5
H1300-241	244.0	12.0	3.0	17.5	26.5	34.5	23.5	35.5

**Note:**

1. Inductance measured at 100KHz, 1Vrms
2. Isat is the DC current where the inductance drops the specified amount from its original value without bias.
3. Irms is the DC current that causes the specified temperature rise of the winding from 25°C ambient for the inductor without housing or potting. Aluminum case, thermal conductive epoxy, or thermal pads can be added to improve cooling.

Revised 06/27/2018

Product performance is limited to specified parameters. Data is subject to change without prior notice.

Tel: 310-325-1043  
Fax: 310-325-1044

www.mpsind.com  
sales@mpsind.com

# HIGH CURRENT INDUCTORS FOR INVERTER SYSTEMS



## H1300 SERIES

### DIMENSIONS (mm / [inch])

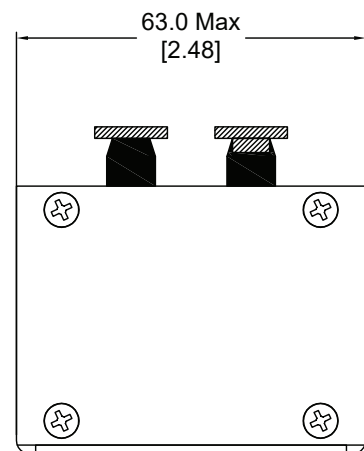
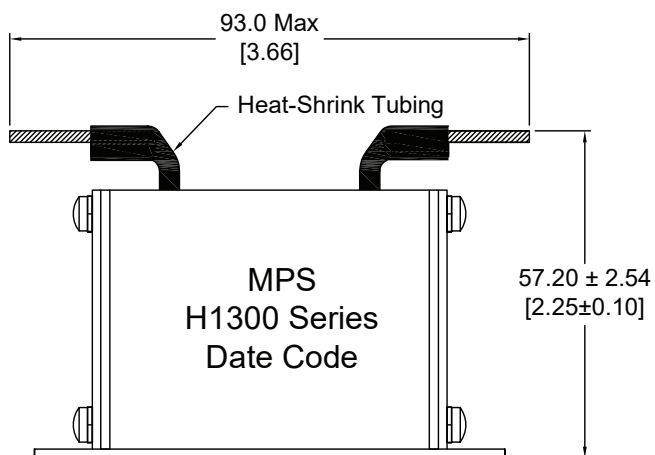
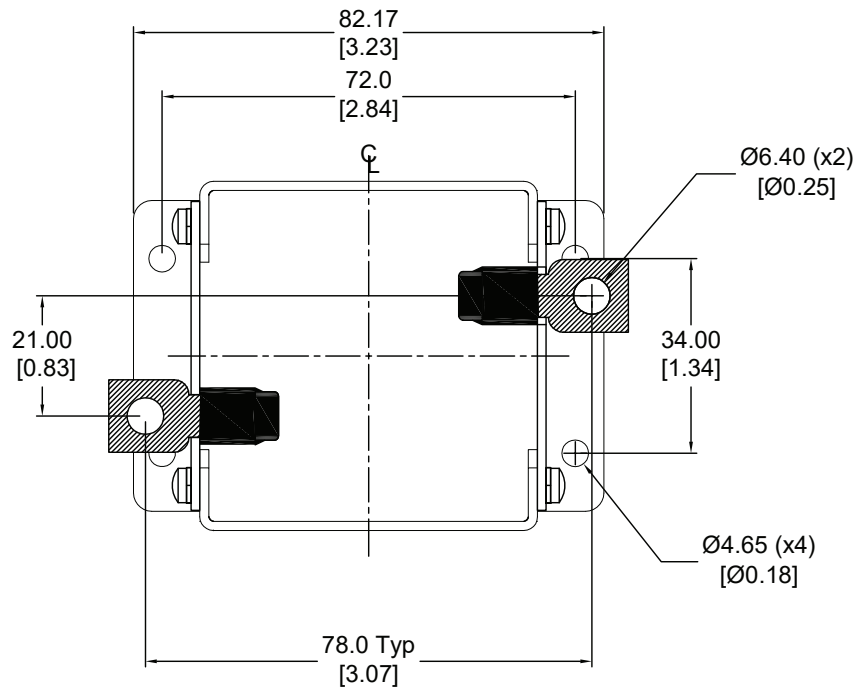

Revised 06/27/2018  
Product performance is limited to specified parameters. Data is subject to change without prior notice.

Tel: 310-325-1043  
Fax: 310-325-1044

www.mpsind.com  
sales@mpsind.com