

**SAW Filter 433.920MHz**

**Model: TB433ED**

**Part No: MA03137**

**REV. NO.: 4**

**A. MAXIMUM RATING:**

1. Input Power Level: 10 dBm
2. DC voltage: 12 V
3. Operating Temperature: -40°C to +85°C
4. Storage Temperature: -40°C to +85°C

**B. ELECTRICAL CHARACTERISTICS:**

Item	Min.	Typ.	Max.	Note
Center frequency $F_c$ (MHz)	433.8	433.92	434.12	1
Minimum I.L. (433.8~434.12 MHz) (dB) $IL_{min}$	-	3.0	5.0	
Pass band (relative to $IL_{min}$ )				
433.76~434.08 MHz (dB)	-	-	2.0	1
433.74~434.10 MHz (dB)	-	-	3.0	
433.68~434.16 MHz (dB)	-	-	6.0	
Pass bandwidth (relative to $IL_{min}$ ) $BW_3$ (KHz)	500	650	750	
Attenuation:( relative to $IL_{min}$ ) (dB)				
414~428 MHz (dB)	40	43	-	1
428~432.84 MHz (dB)	15	26	-	
434.92~442 MHz (dB)	10	16	-	
442~550 MHz (dB)	33	38	-	
Impedance at $F_c$ ; Input $Z_{IN}=R_{IN}/C_{IN}$ Output $Z_{OUT}=R_{OUT}/C_{OUT}$	212Ω // 3.1 pF 212Ω // 3.1 pF			2
Turnover To (deg.C)	25 typ.			

Note1. The standard definitions is in JIS C 6703

Note2.

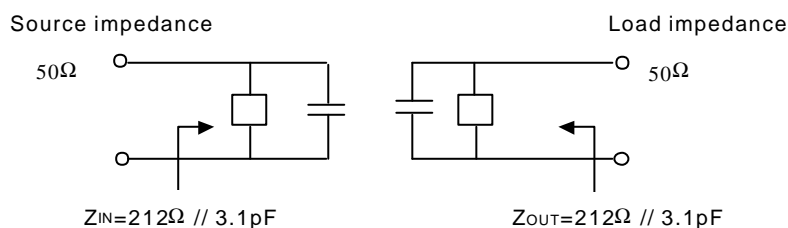

**SAW Filter 433.920MHz**  
**Part No: MA03137**

**Model: TB433ED**  
**REV. NO.: 4**

**C. FREQUENCY CHARACTERISTICS:**

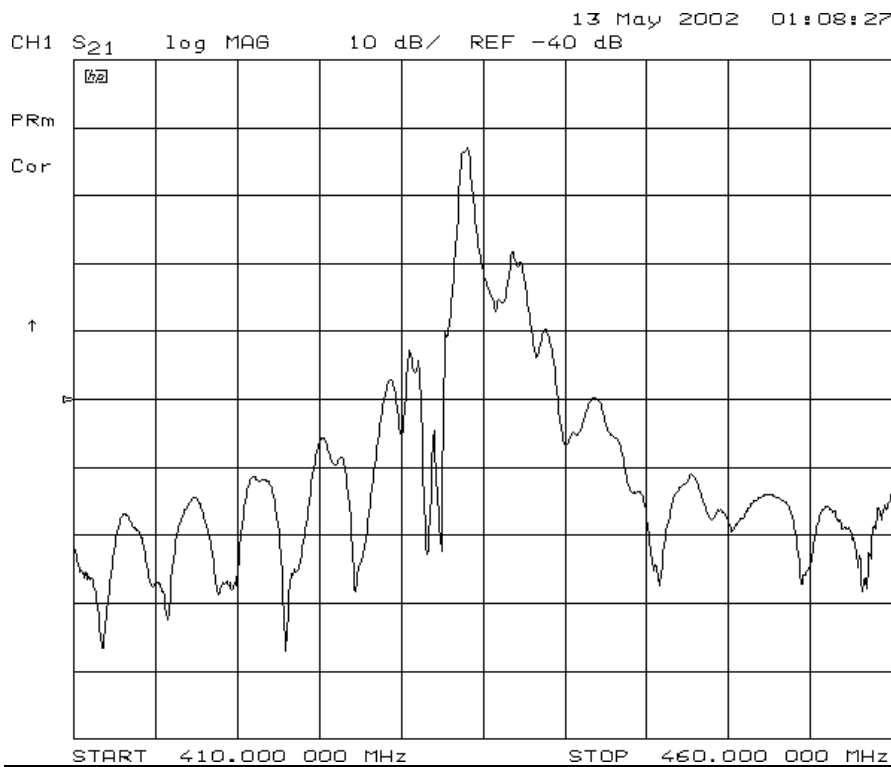
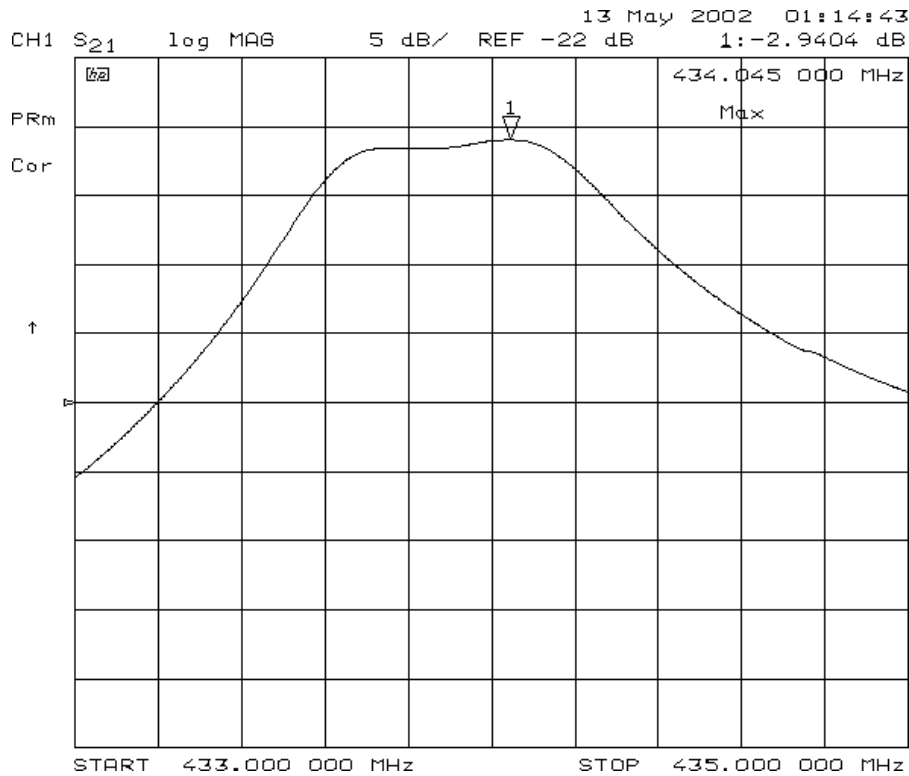

**SAW Filter 433.920MHz**  
**Part No: MA03137**

**Model: TB433ED**  
**REV. NO.: 4**

**D. MEASUREMENT CIRCUIT:**

HP Network analyzer

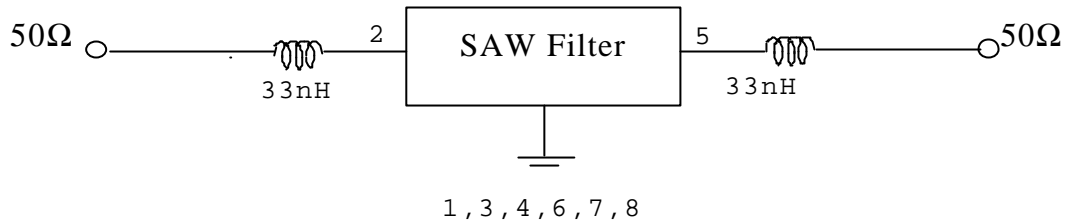

**E. OUTLINE DRAWING:**

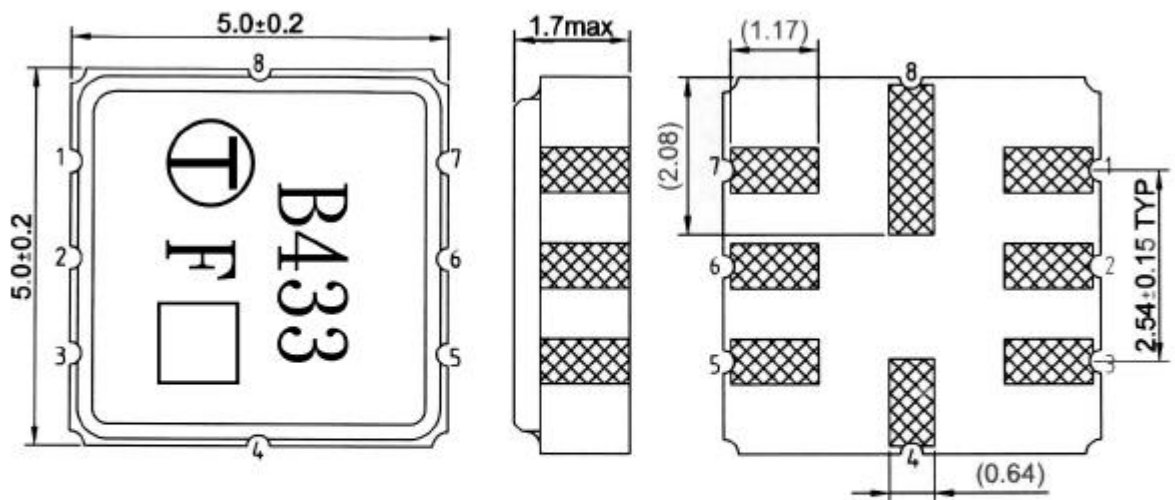

- #1 : Input Ground
- #2 : Input
- #5 : Output
- #6 : Output Ground
- #4、8 : Case Ground
- #3、7 : to be ground
- : Date code
- Unit : mm

**SAW Filter 433.920MHz**  
**Part No: MA03137**

**Model: TB433ED**  
**REV. NO.: 4**

**F. PACKING:**

**1. REEL DIMENSION**

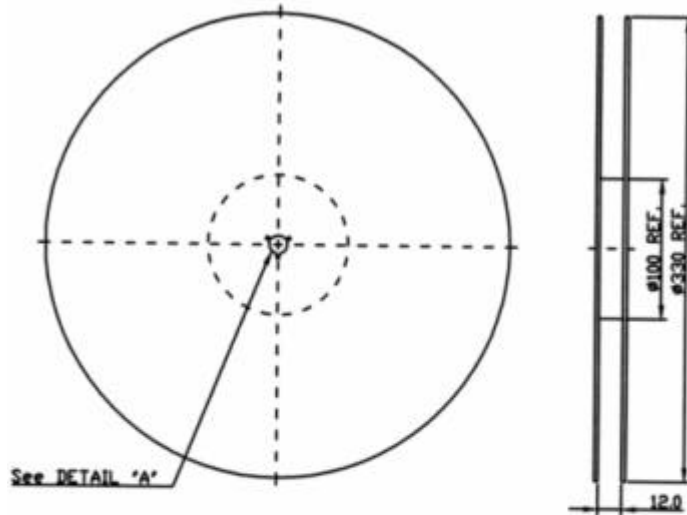

**2. TAPE DIMENSION**

